

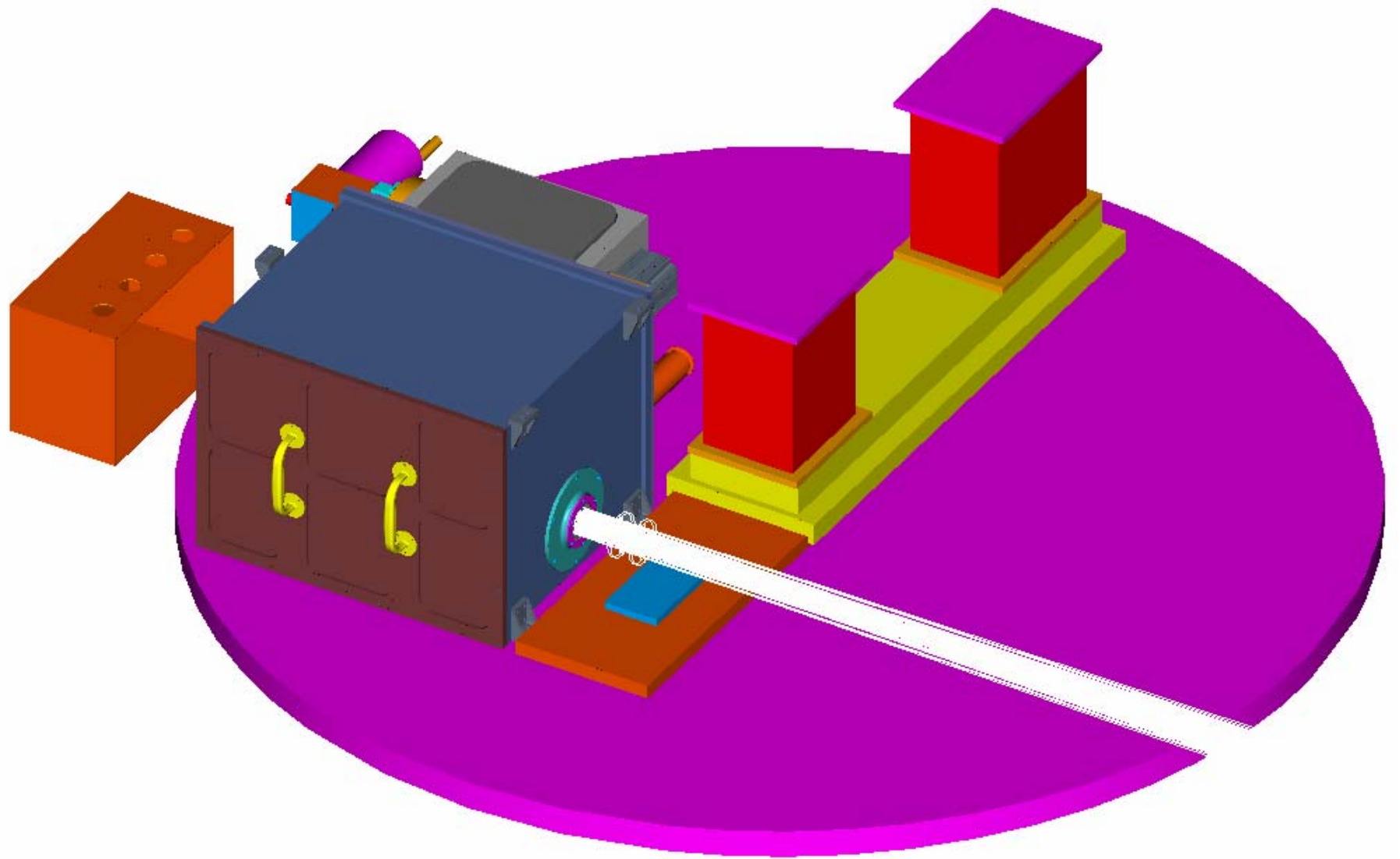

National Solar
Observatory
New Array Camera
Design Review

9/10/03

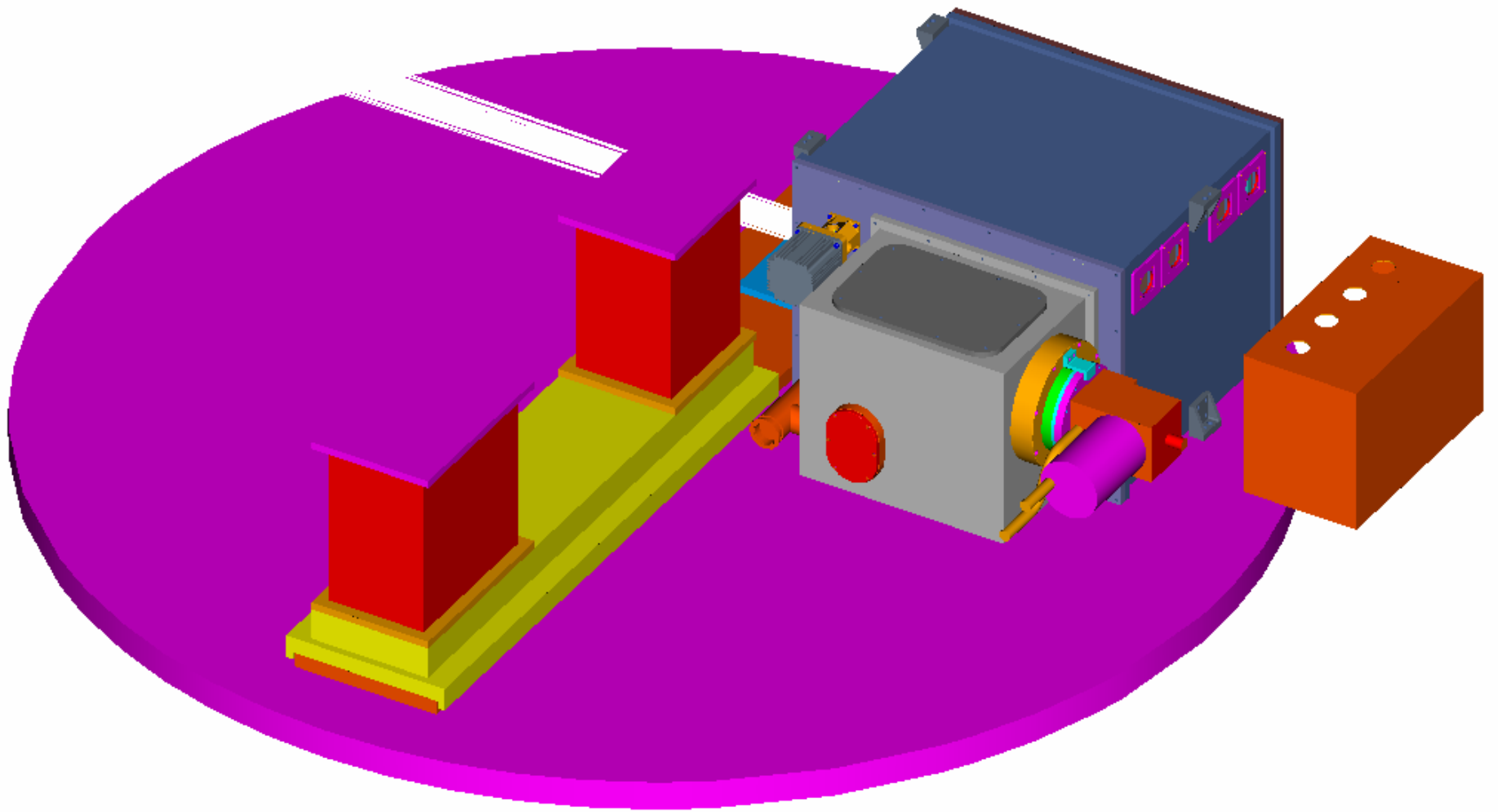



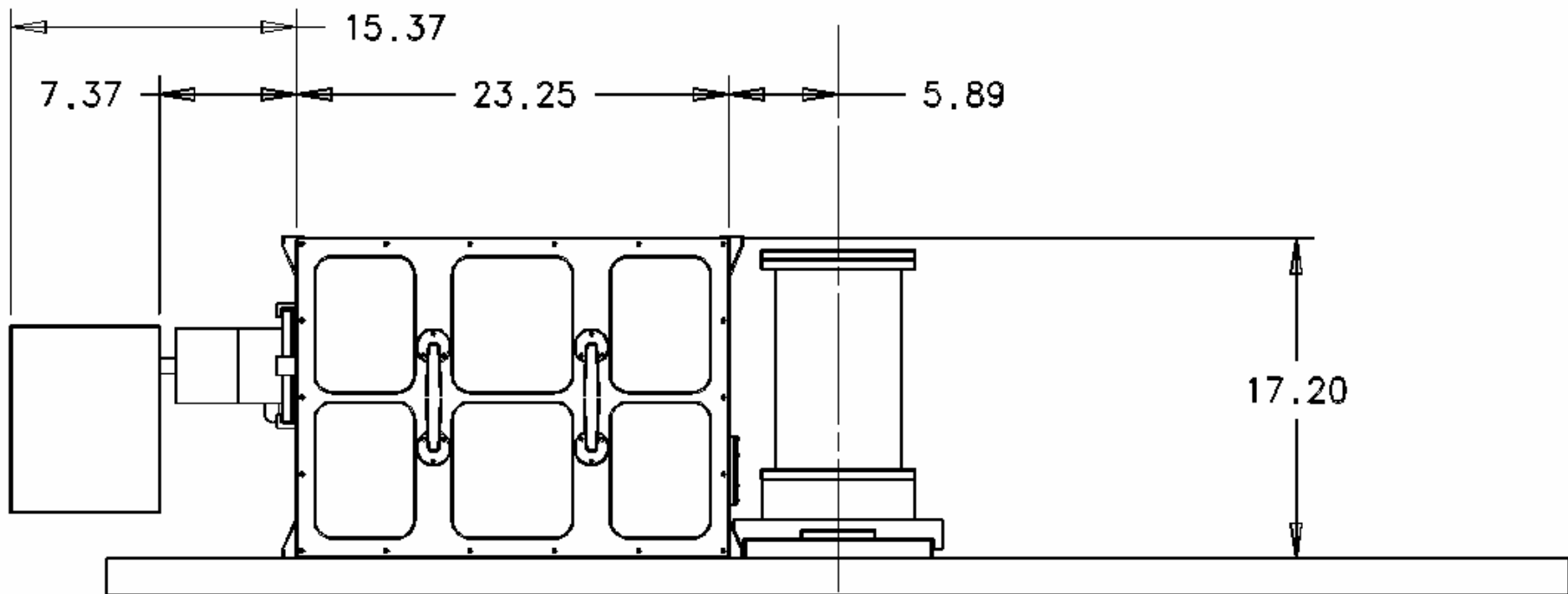

CENTERLINE OF SPECTROGRAPH TABLE

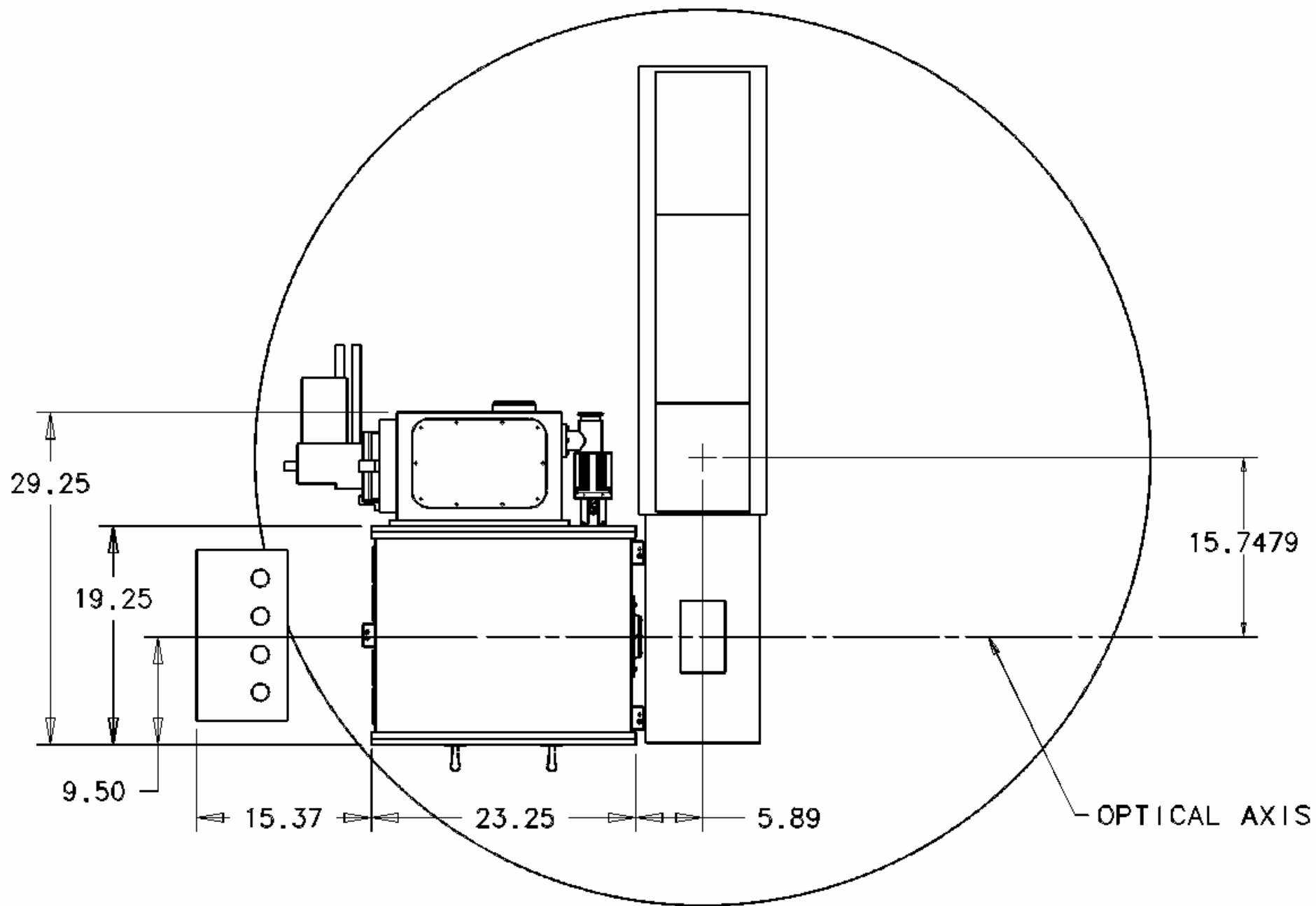

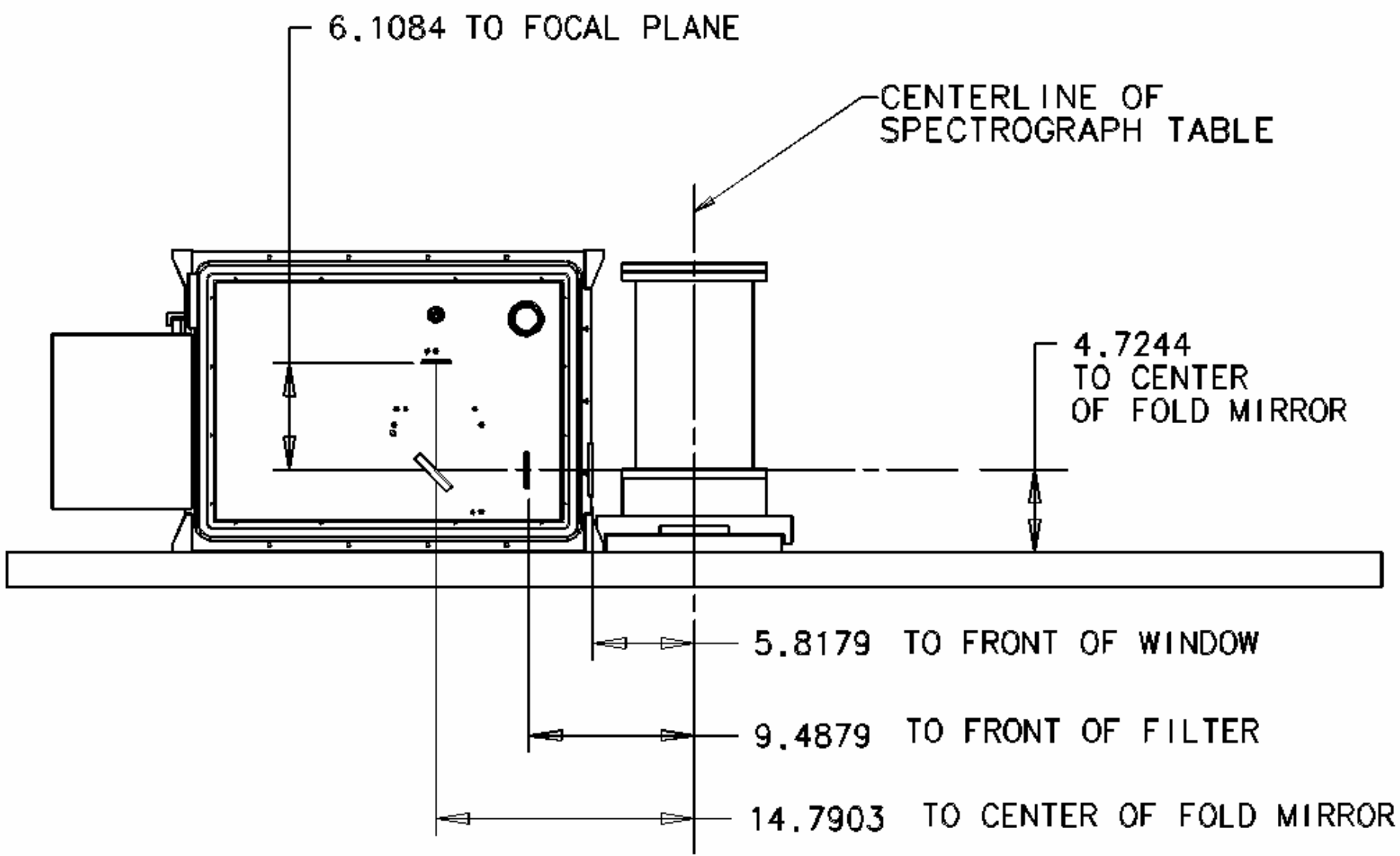

6.1084 TO FOCAL PLANE

CENTERLINE OF SPECTROGRAPH TABLE

4.7244 TO CENTER OF FOLD MIRROR

5.8179 TO FRONT OF WINDOW

9.4879 TO FRONT OF FILTER

14.7903 TO CENTER OF FOLD MIRROR

Vacuum jacket

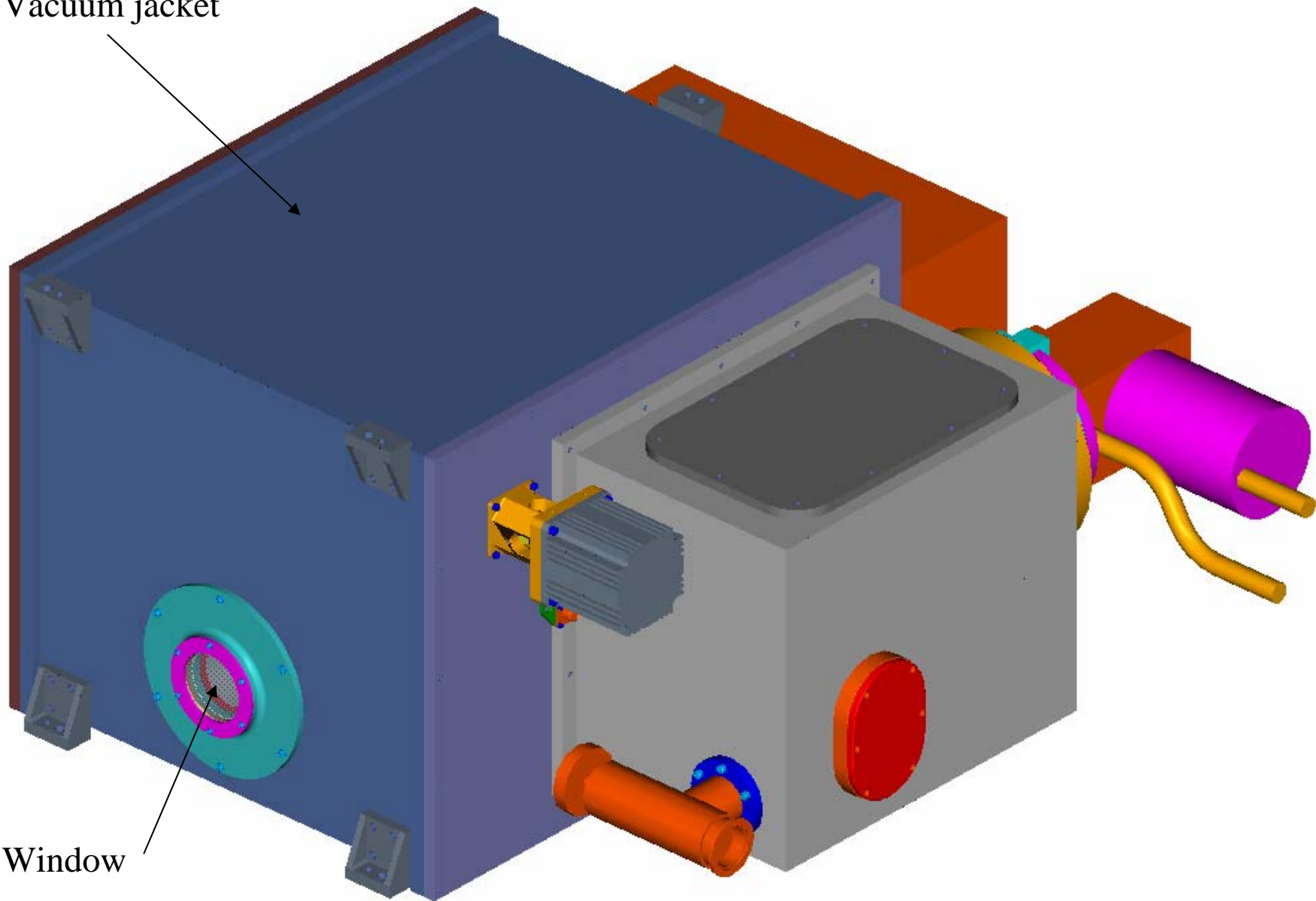

Window

Electronics enclosure

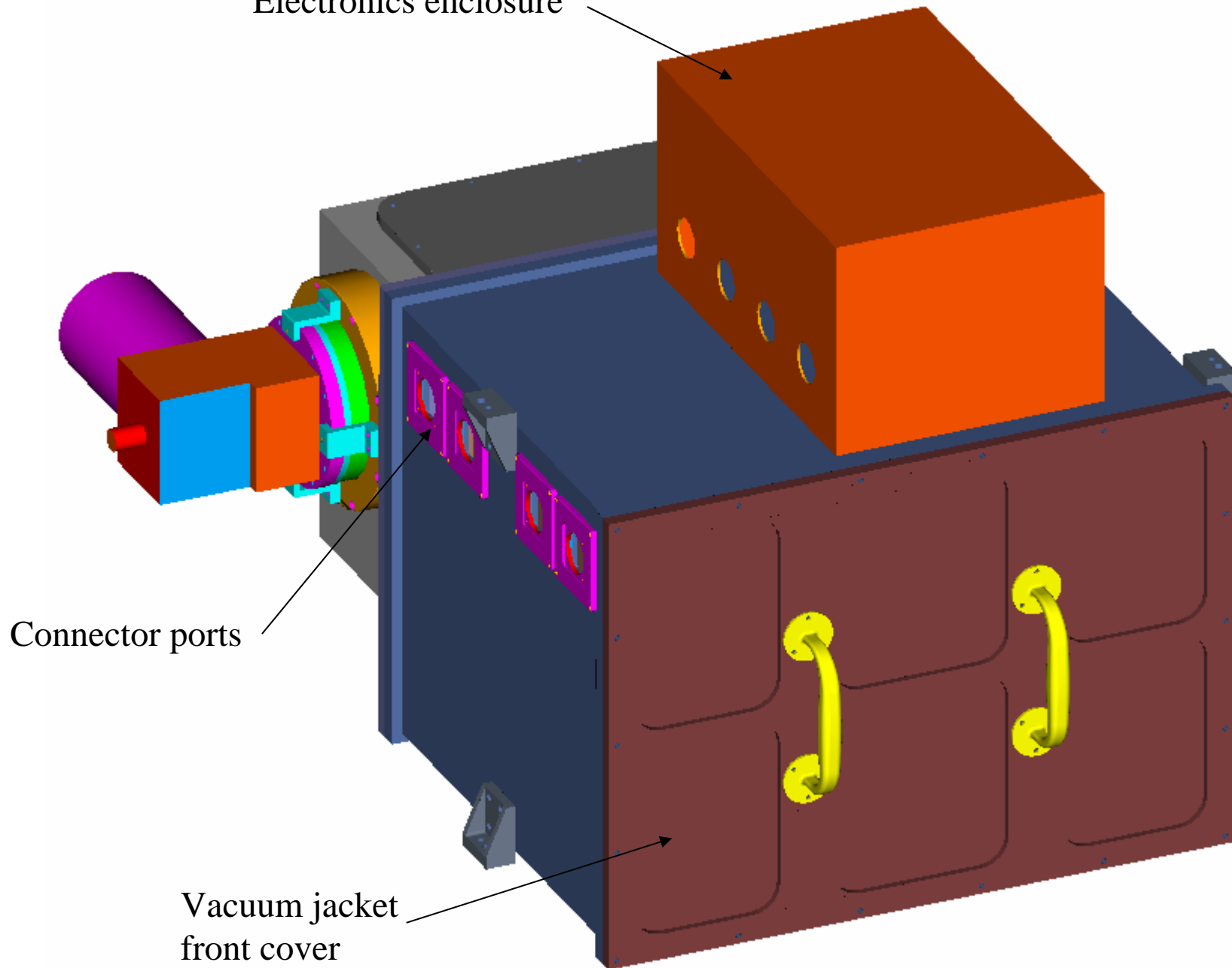

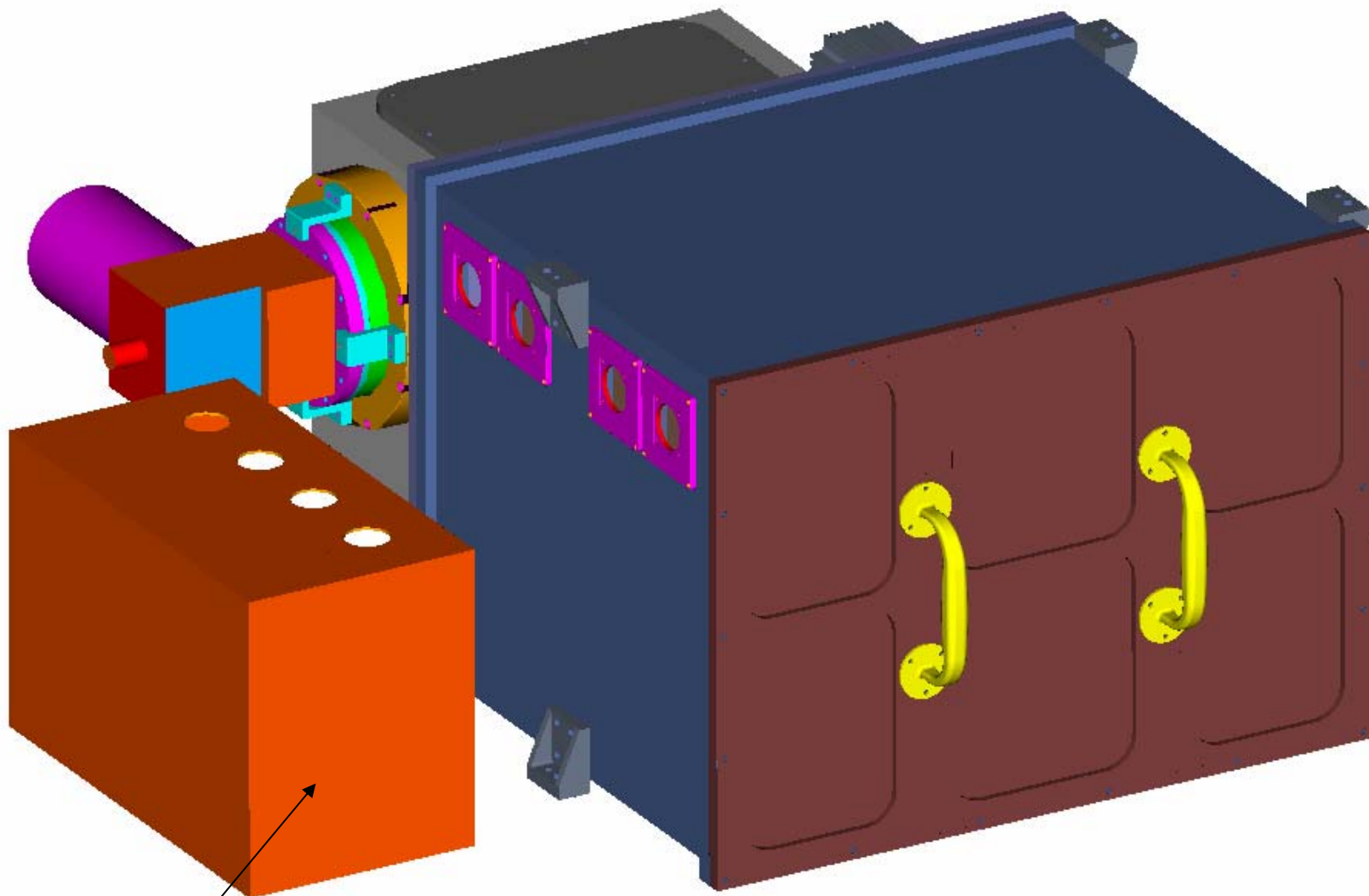

Electronics Enclosure,
alternate position

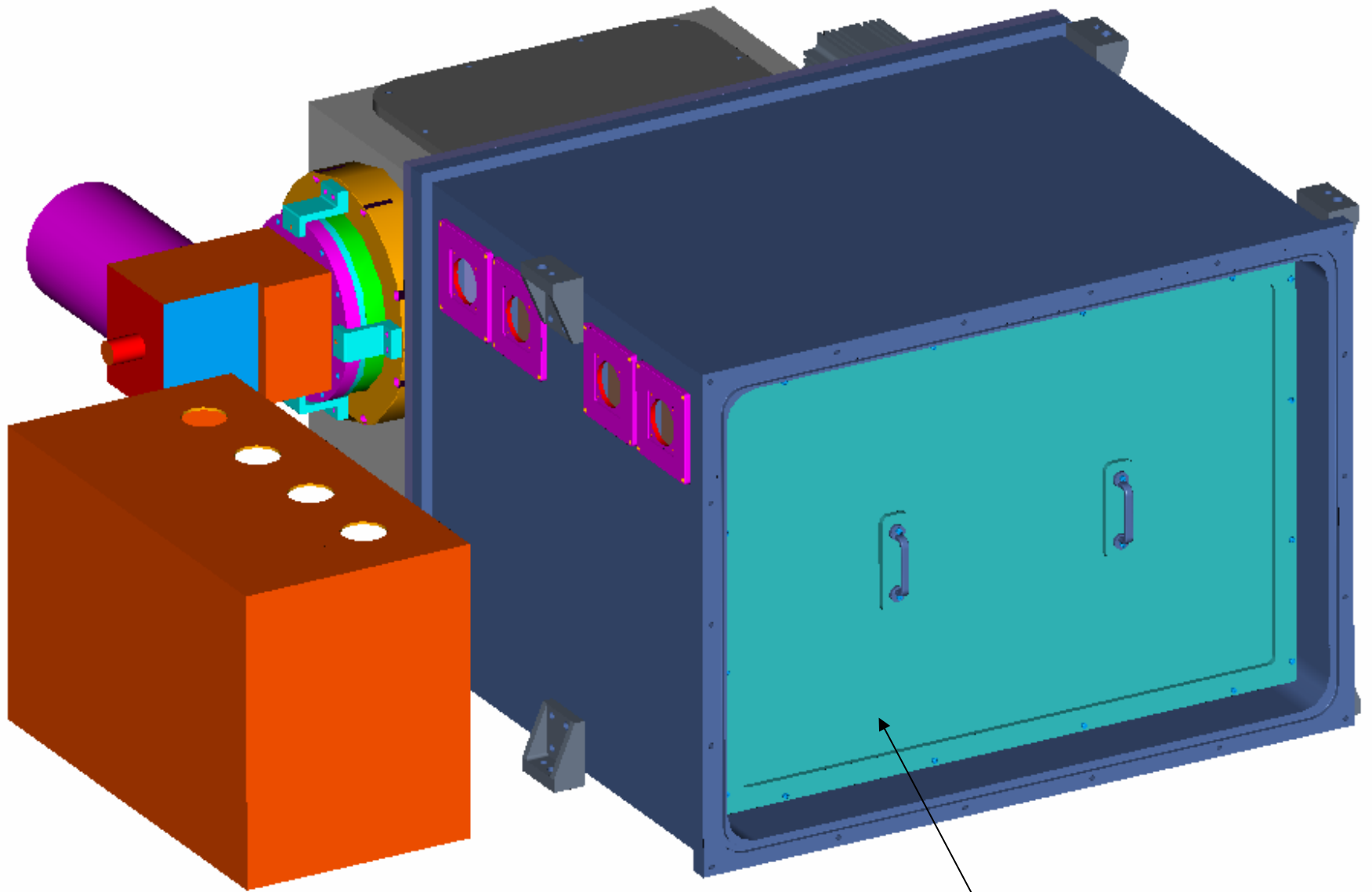

Front cover removed

Radiation shield

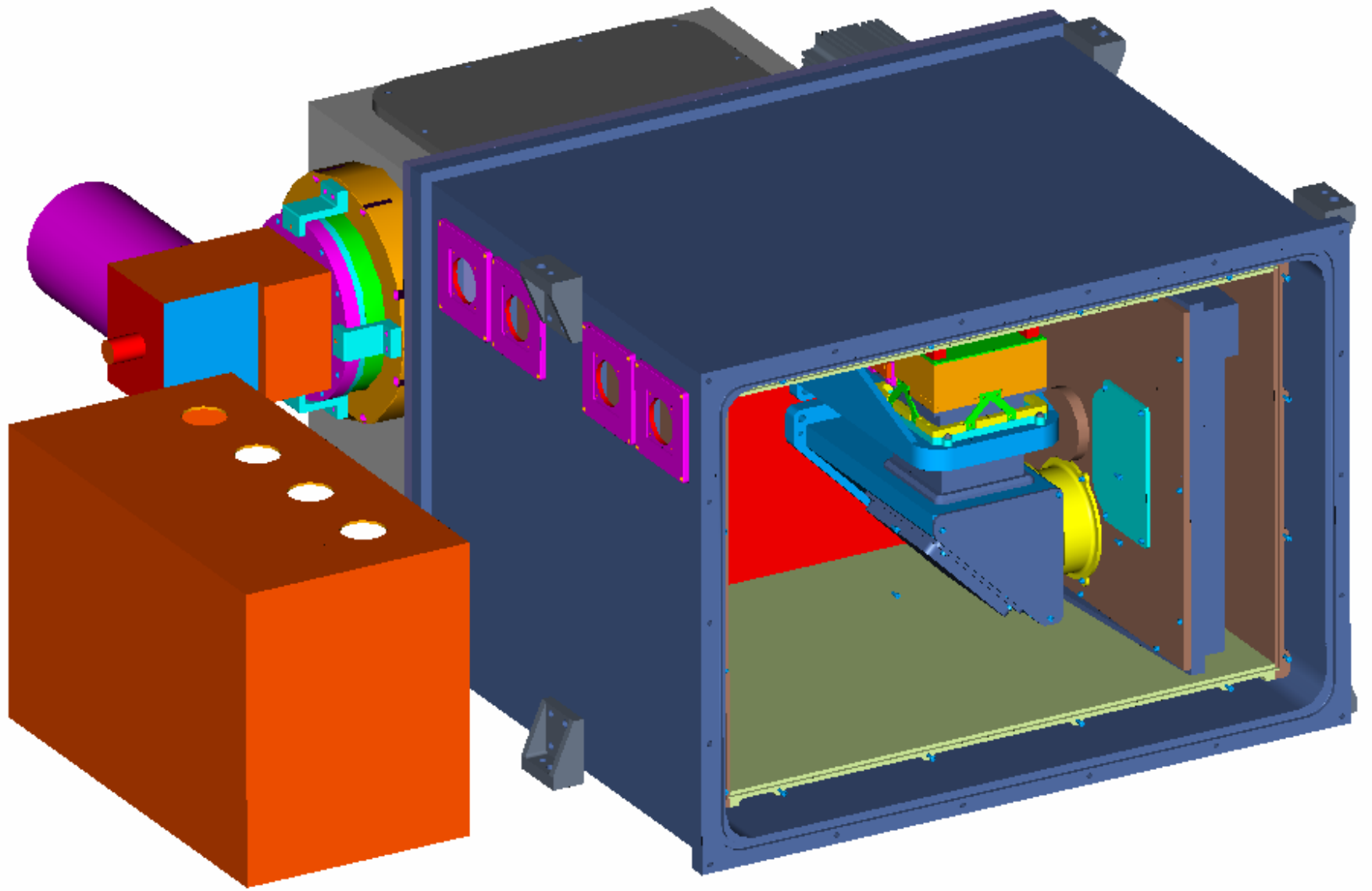

Radiation shield
cover removed

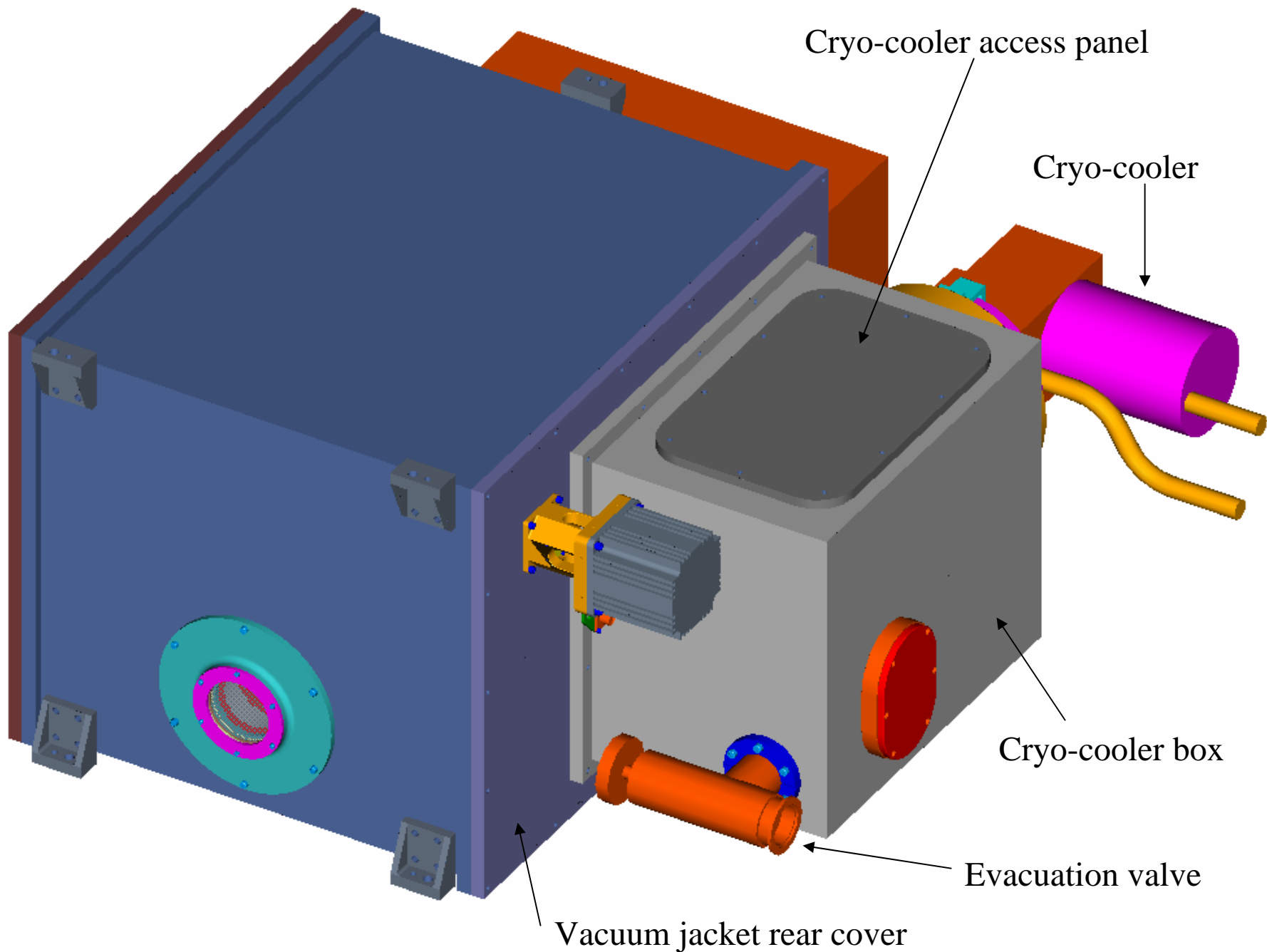

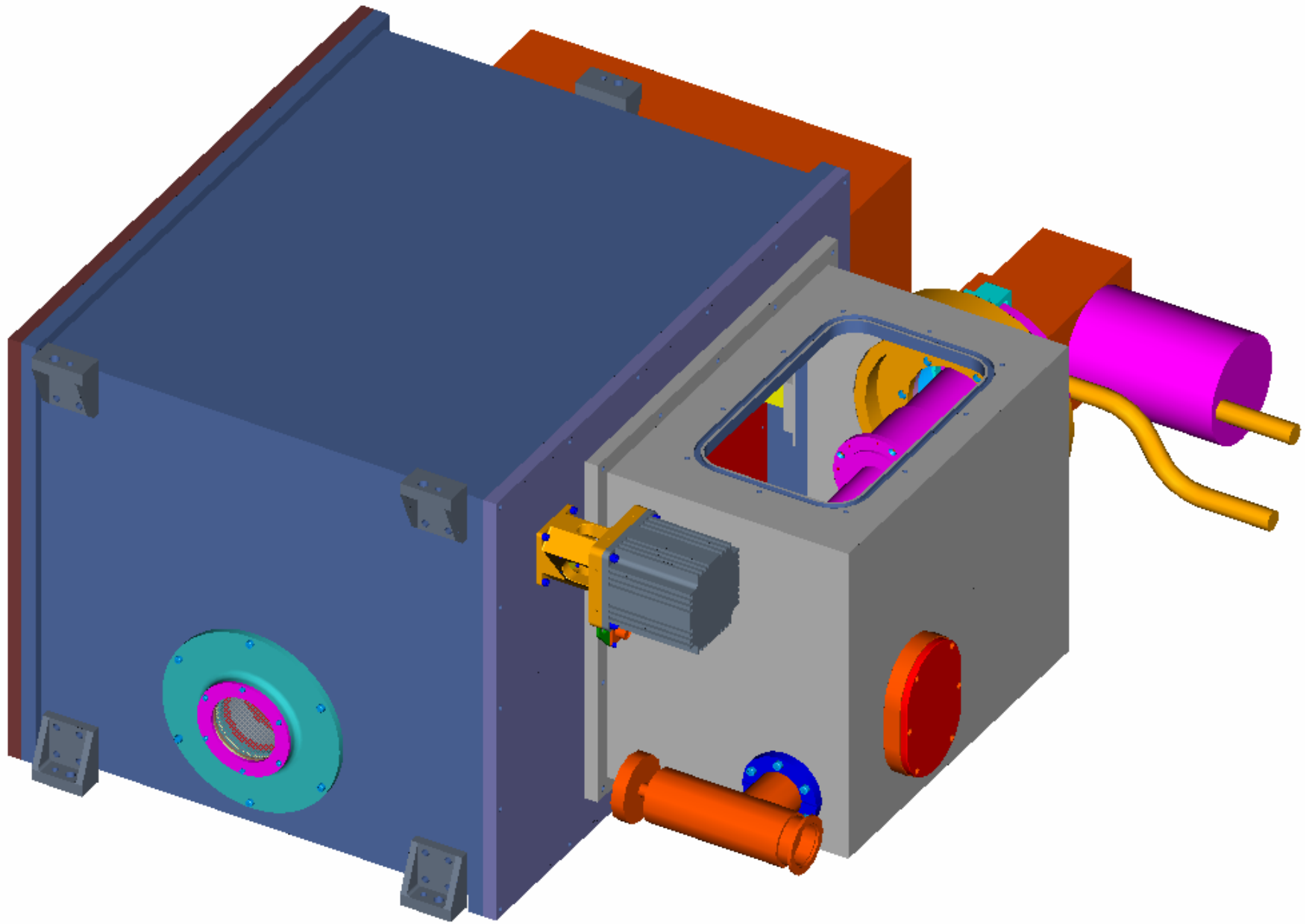

Access panel removed

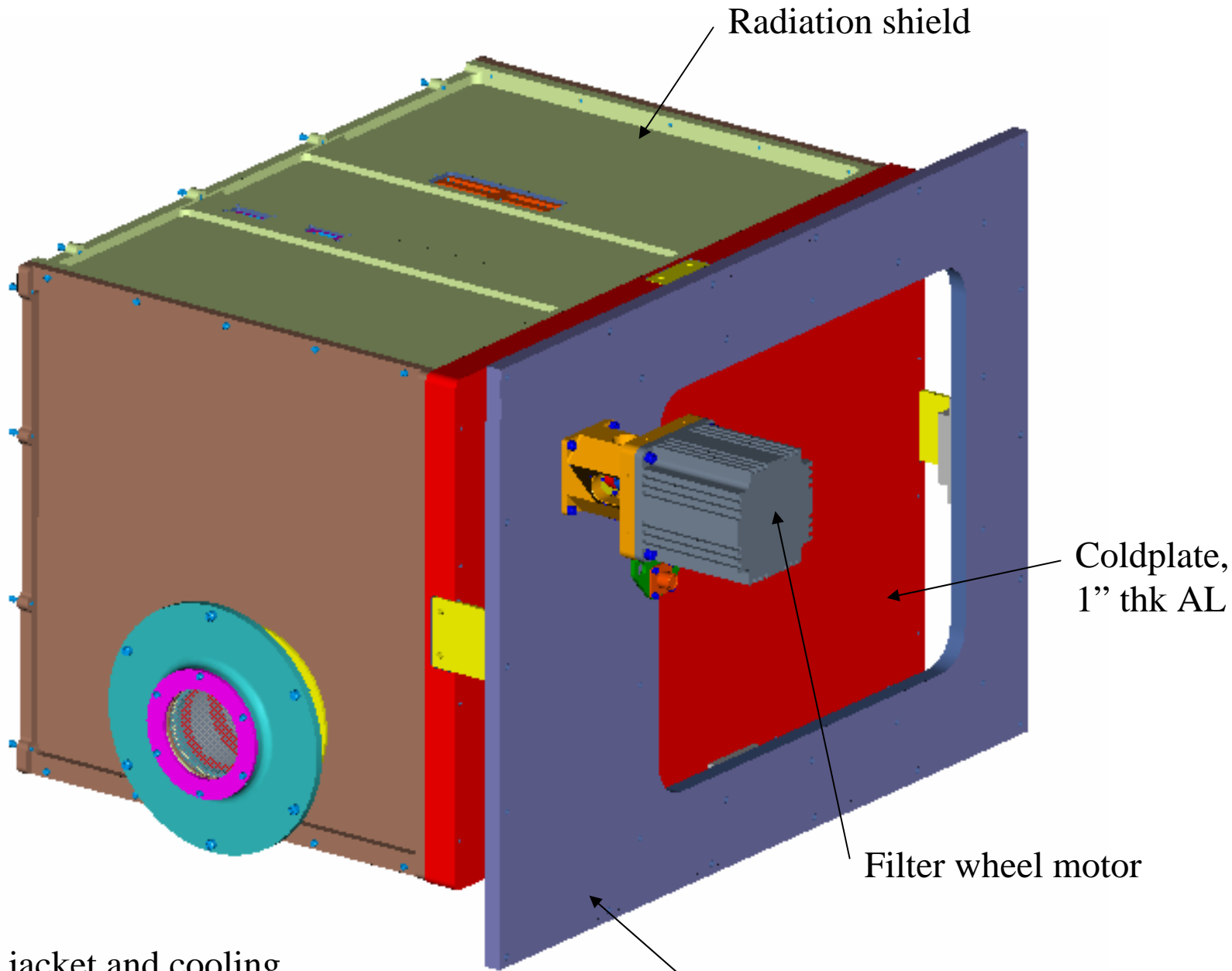

Radiation shield

Coldplate,
1" thk AL

Filter wheel motor

Vacuum jacket rear cover

Vacuum jacket and cooling
hardware removed

Vacuum jacket rear cover

Connector ports

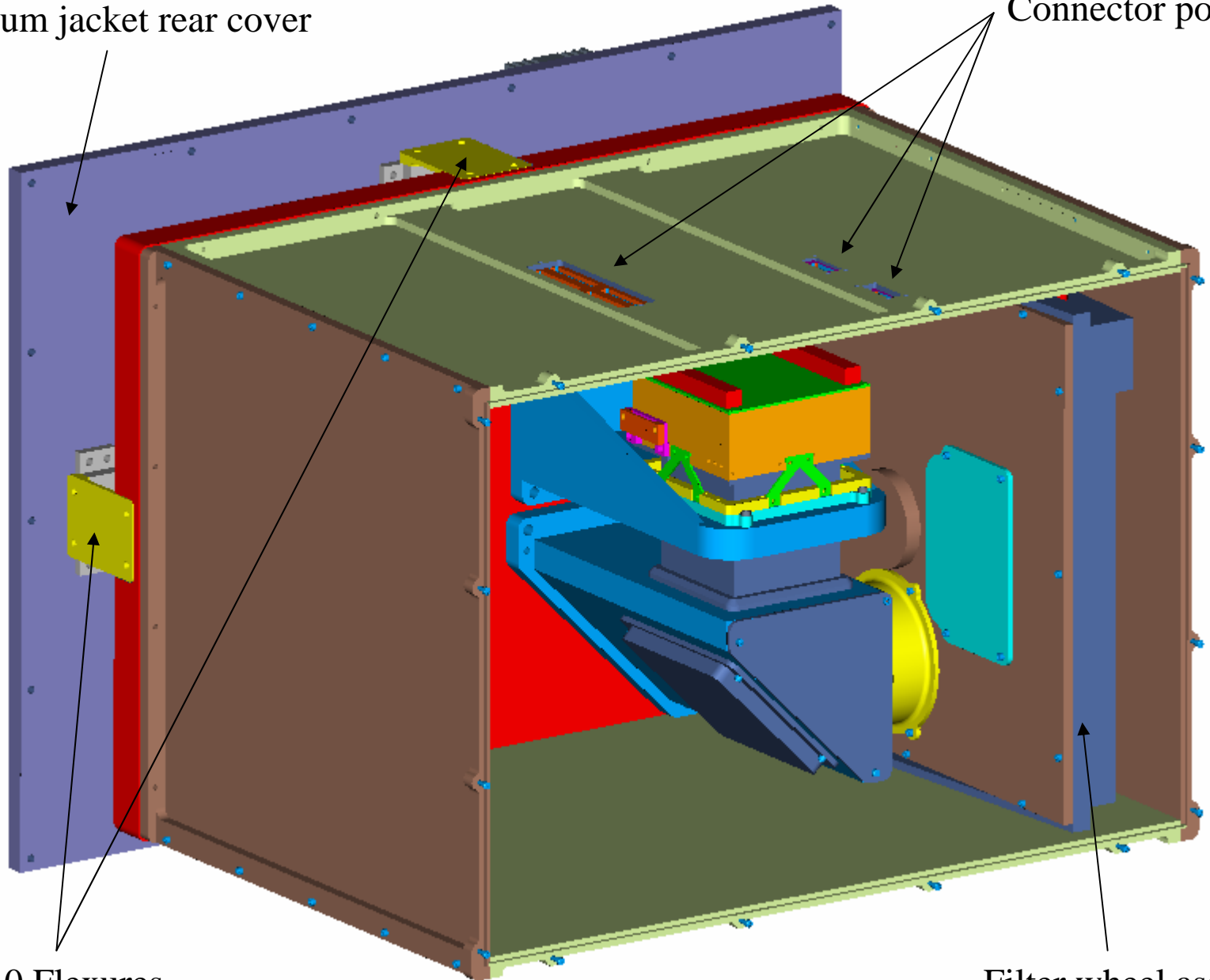

G-10 Flexures

Filter wheel assy

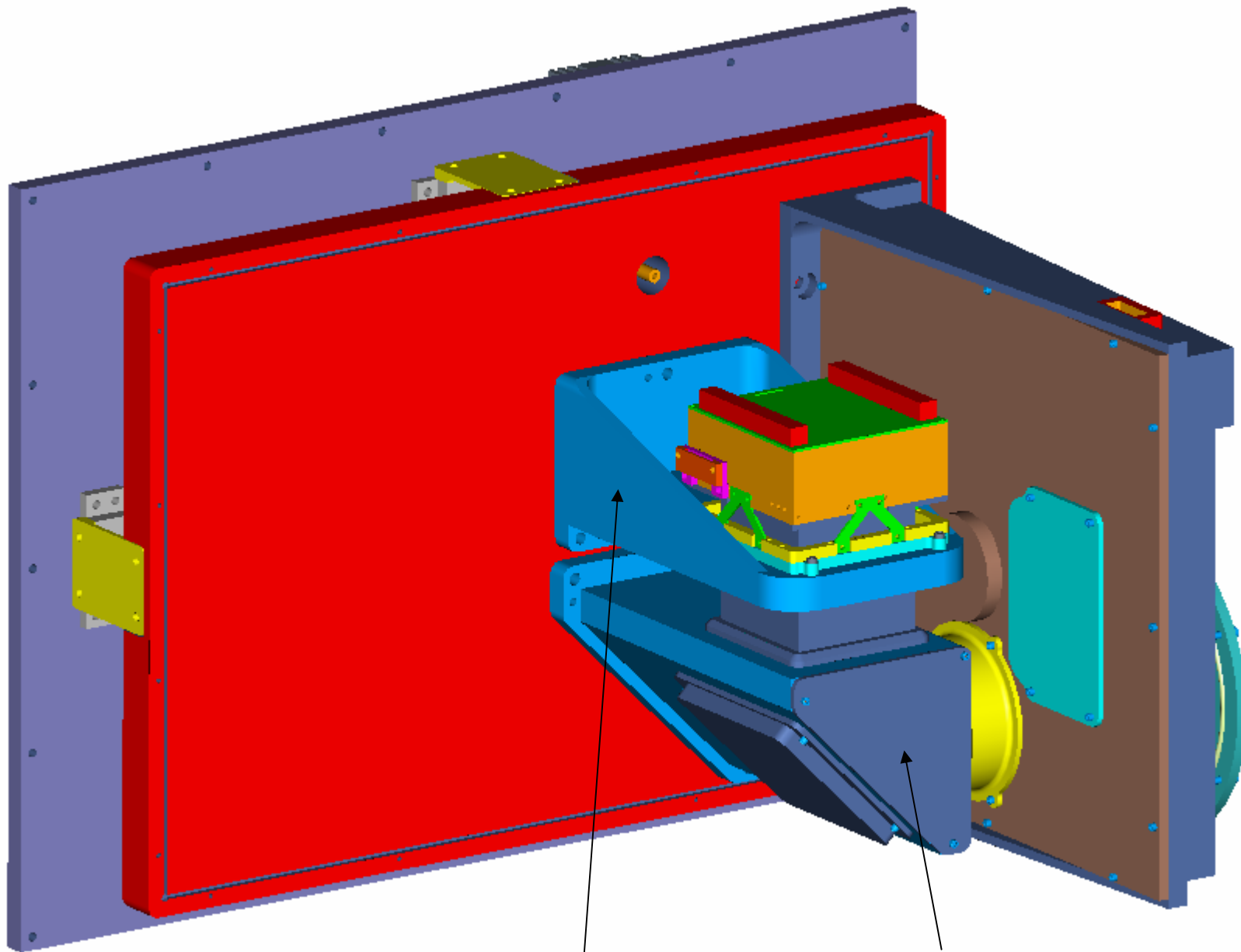

Detector mount assy

Fold mirror mount assy

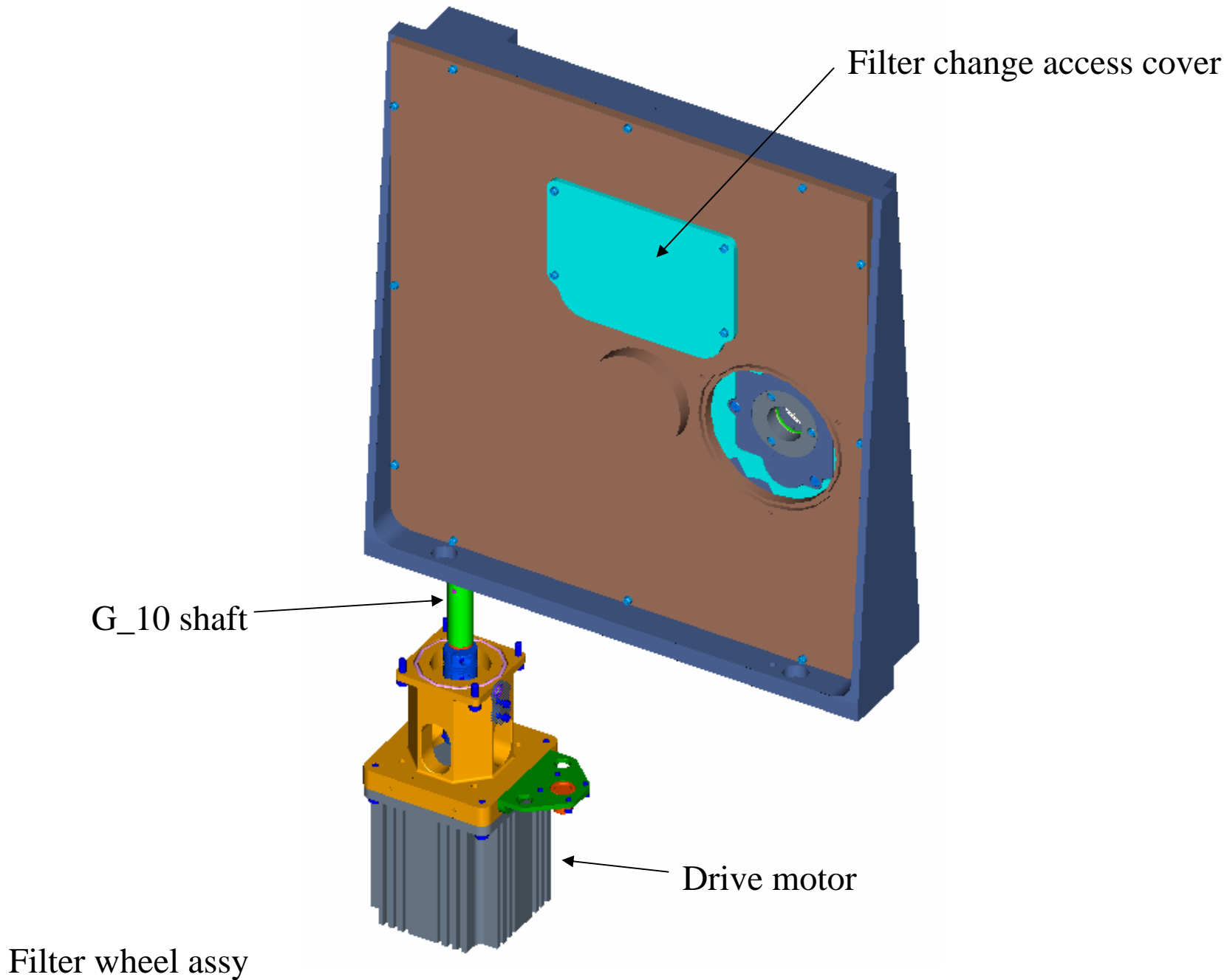

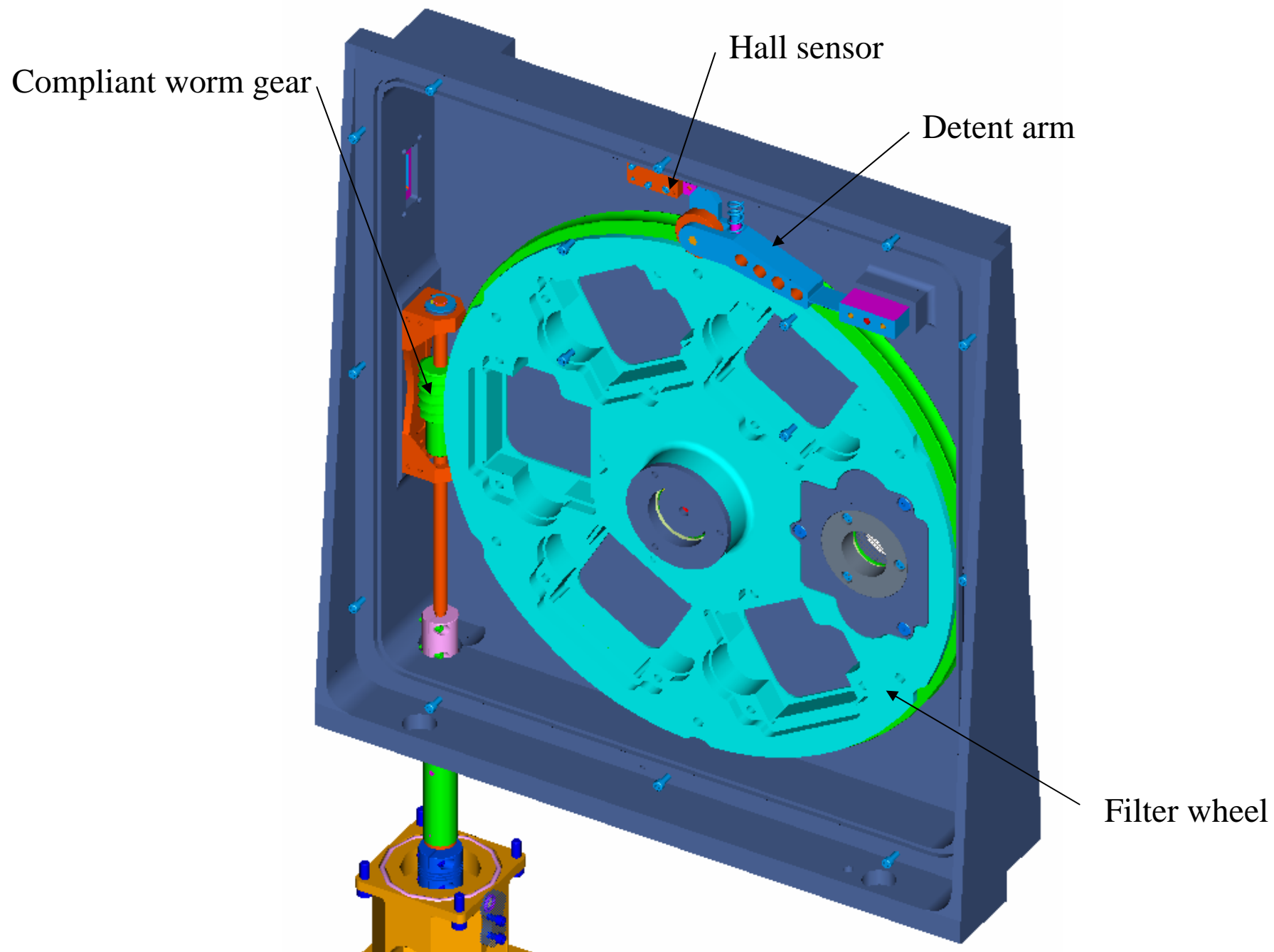

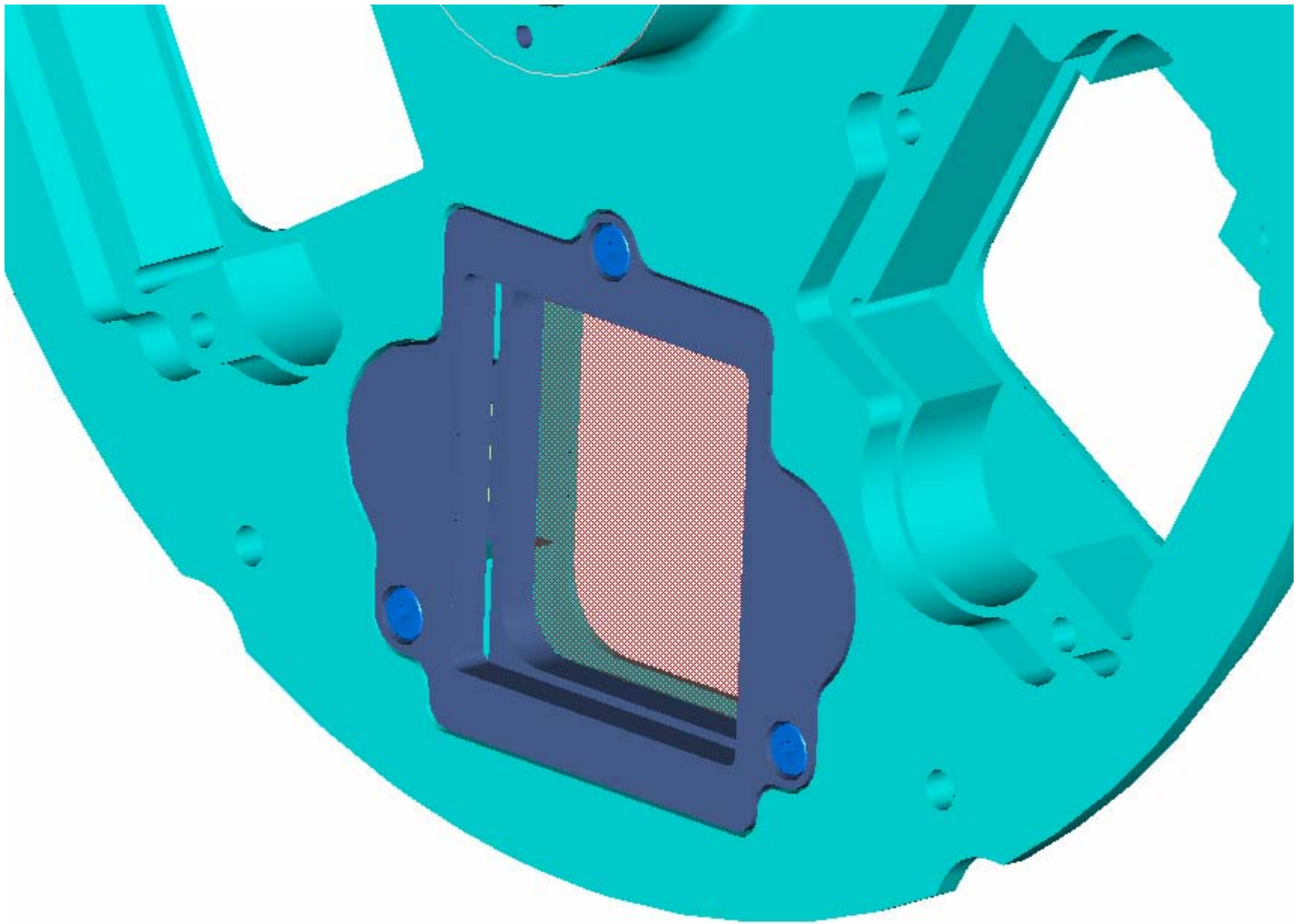

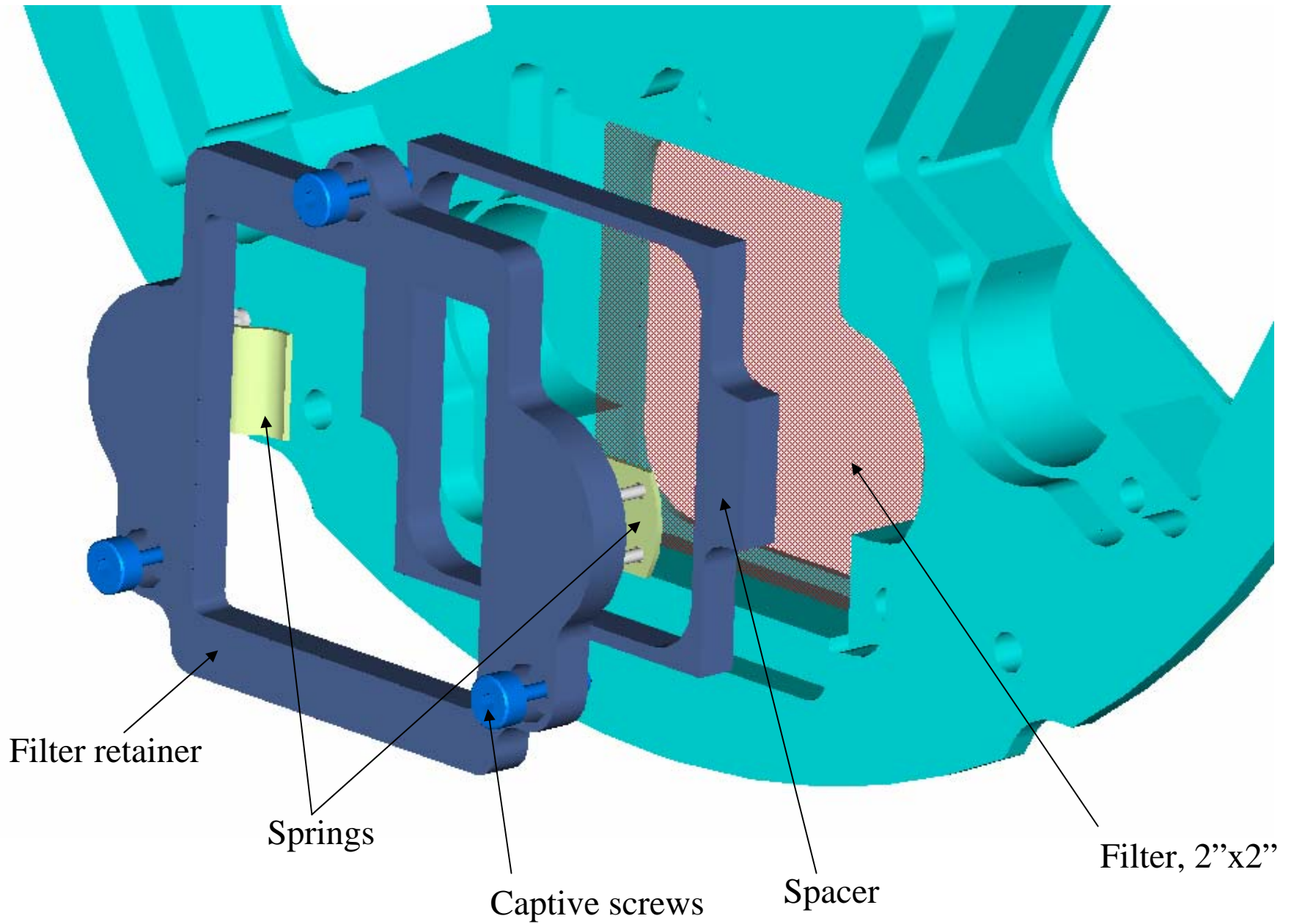

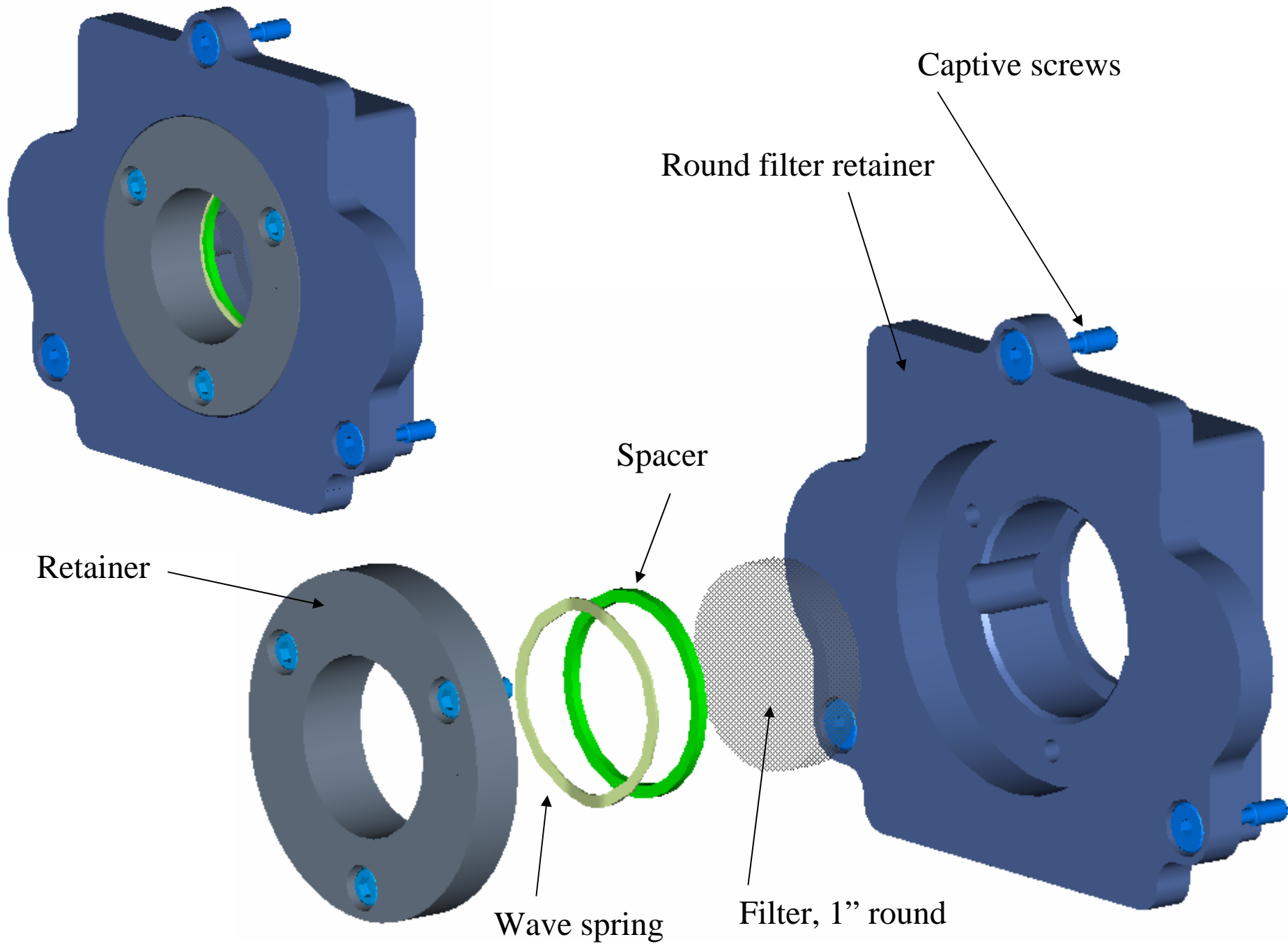

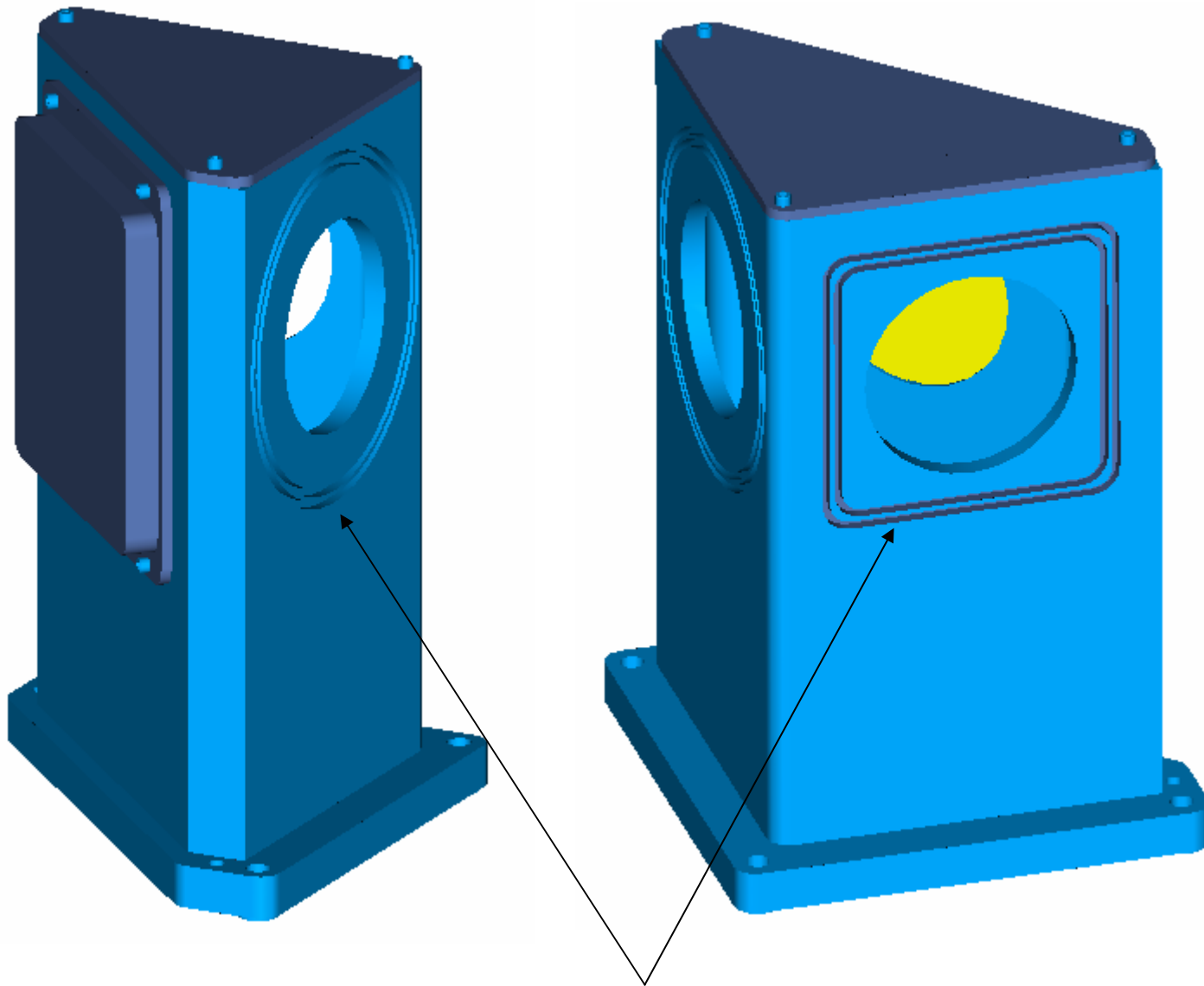

Fold mirror mount assy

Light stop grooves for
baffle tube interface

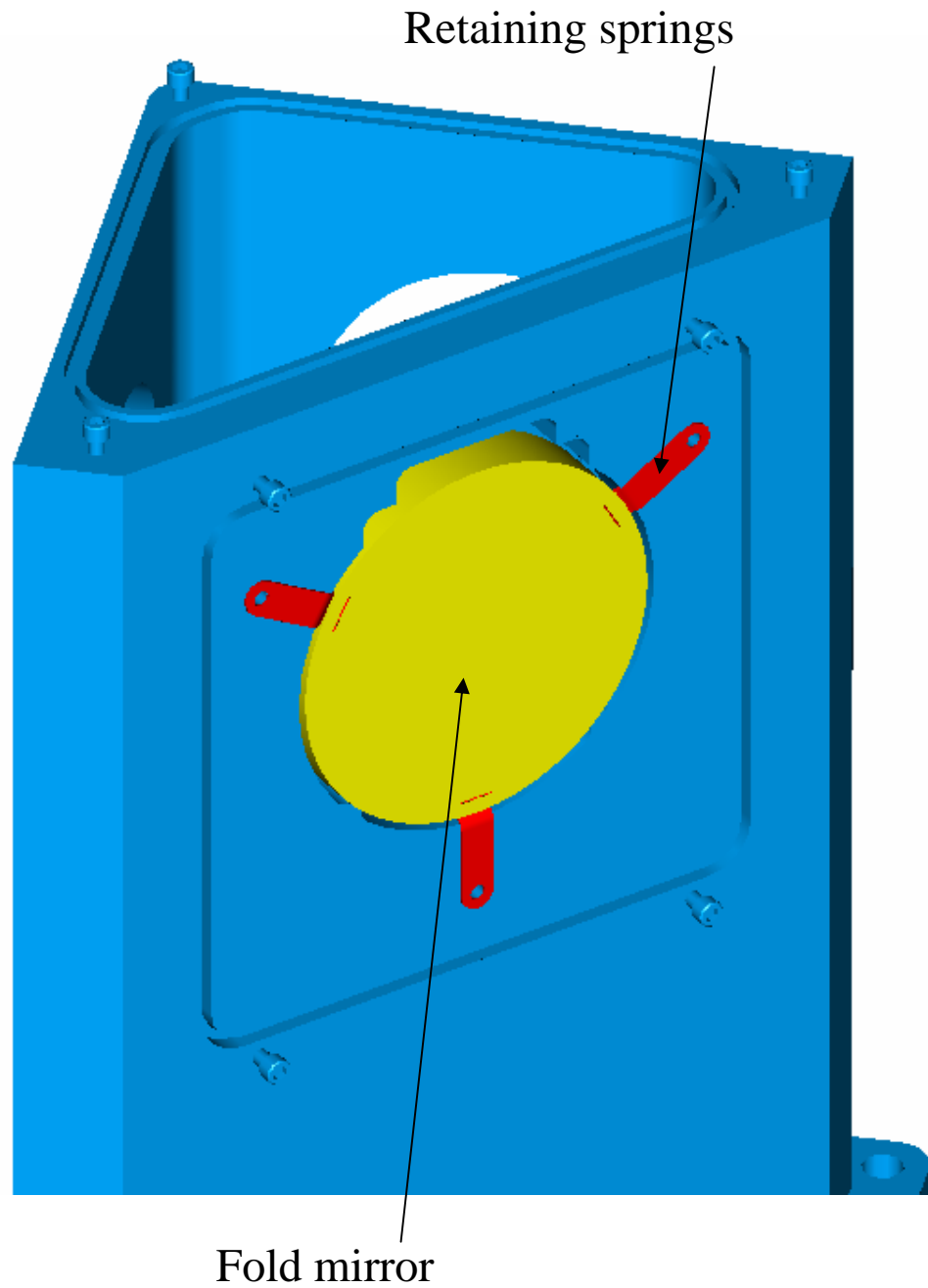
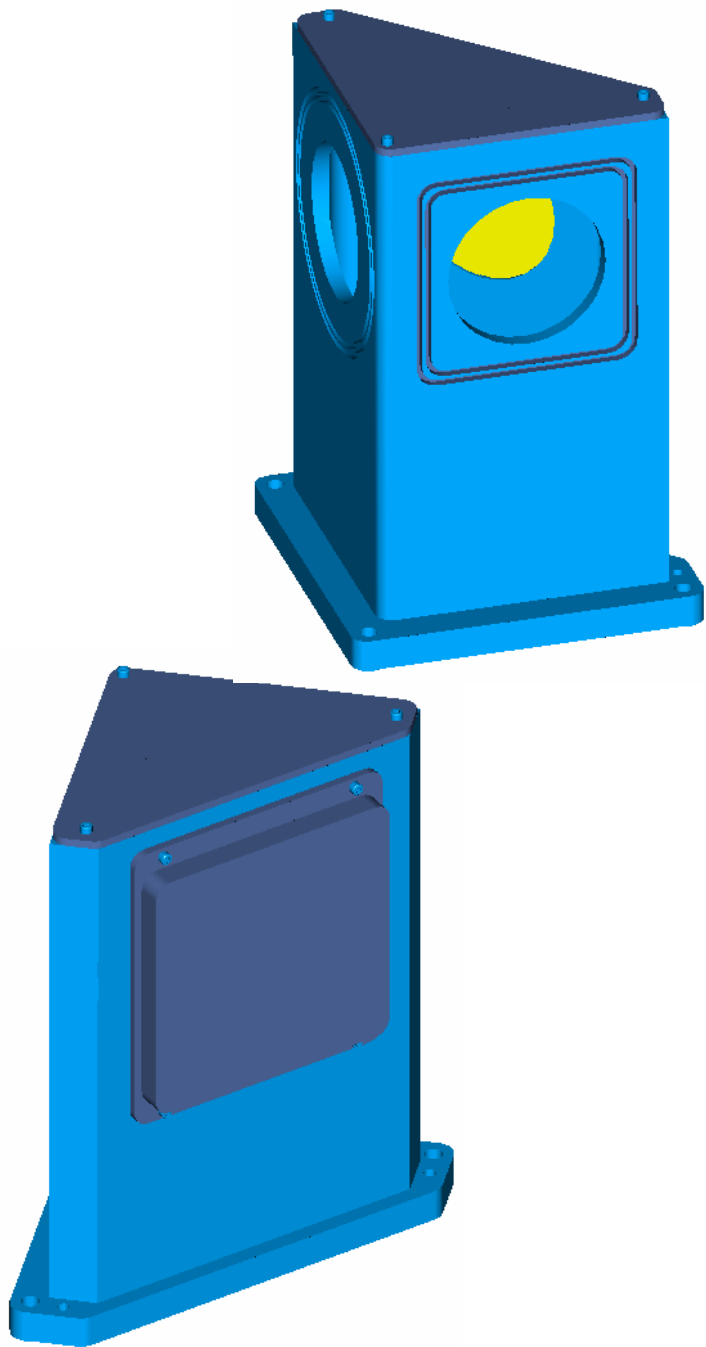

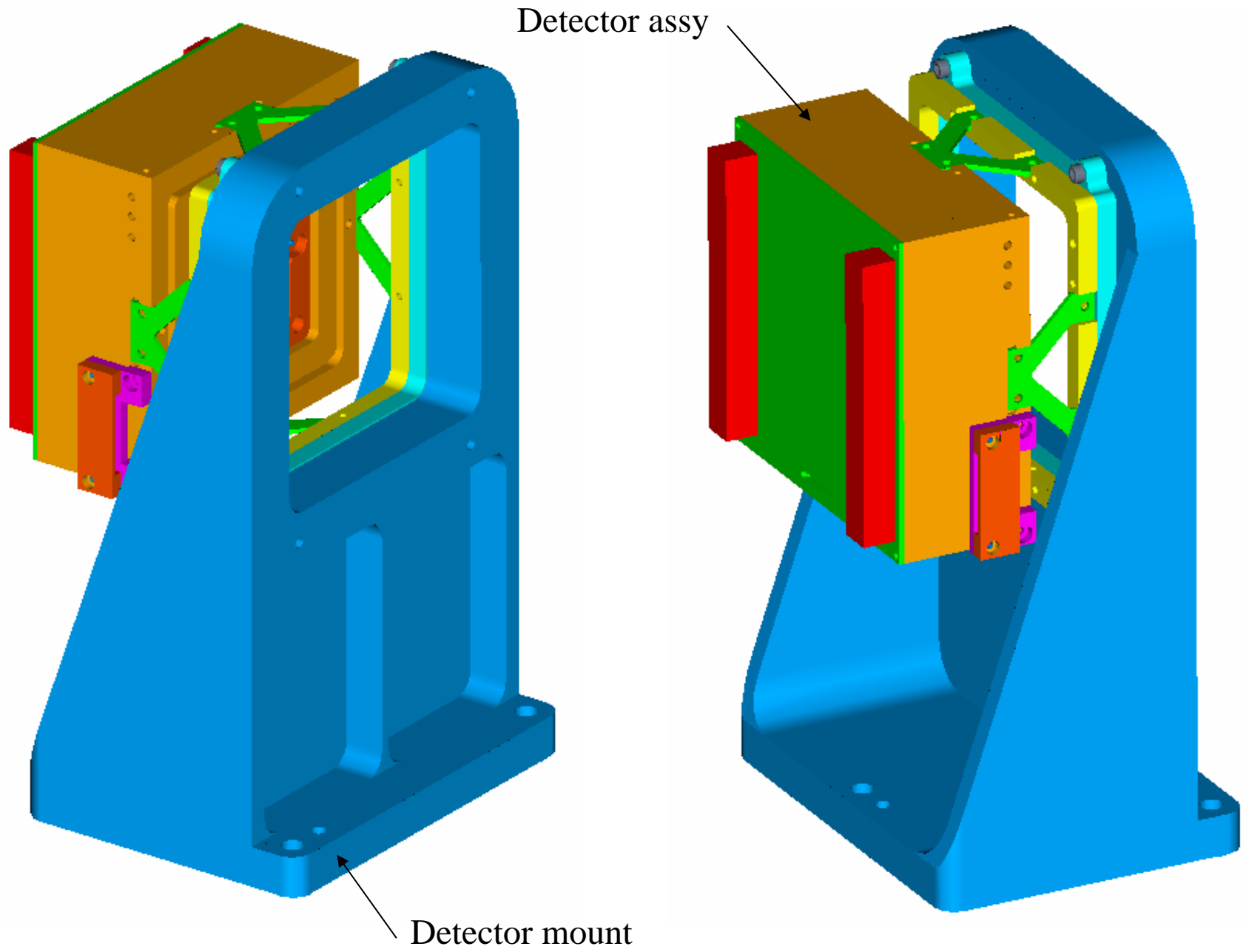

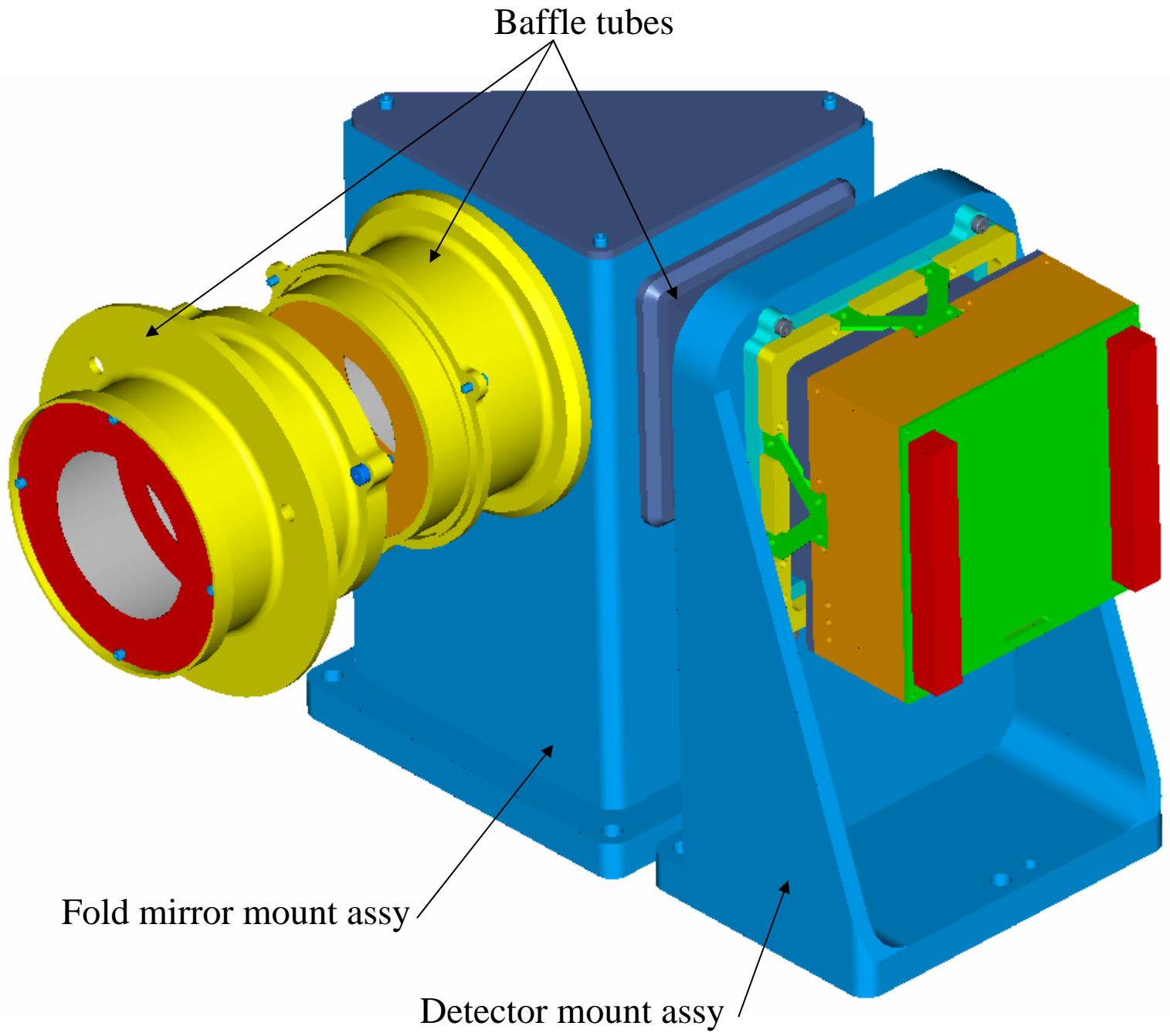

Baffle tubes

Fold mirror mount assy

Detector mount assy

20.700

COLDPLATE OUTLINE

14.550

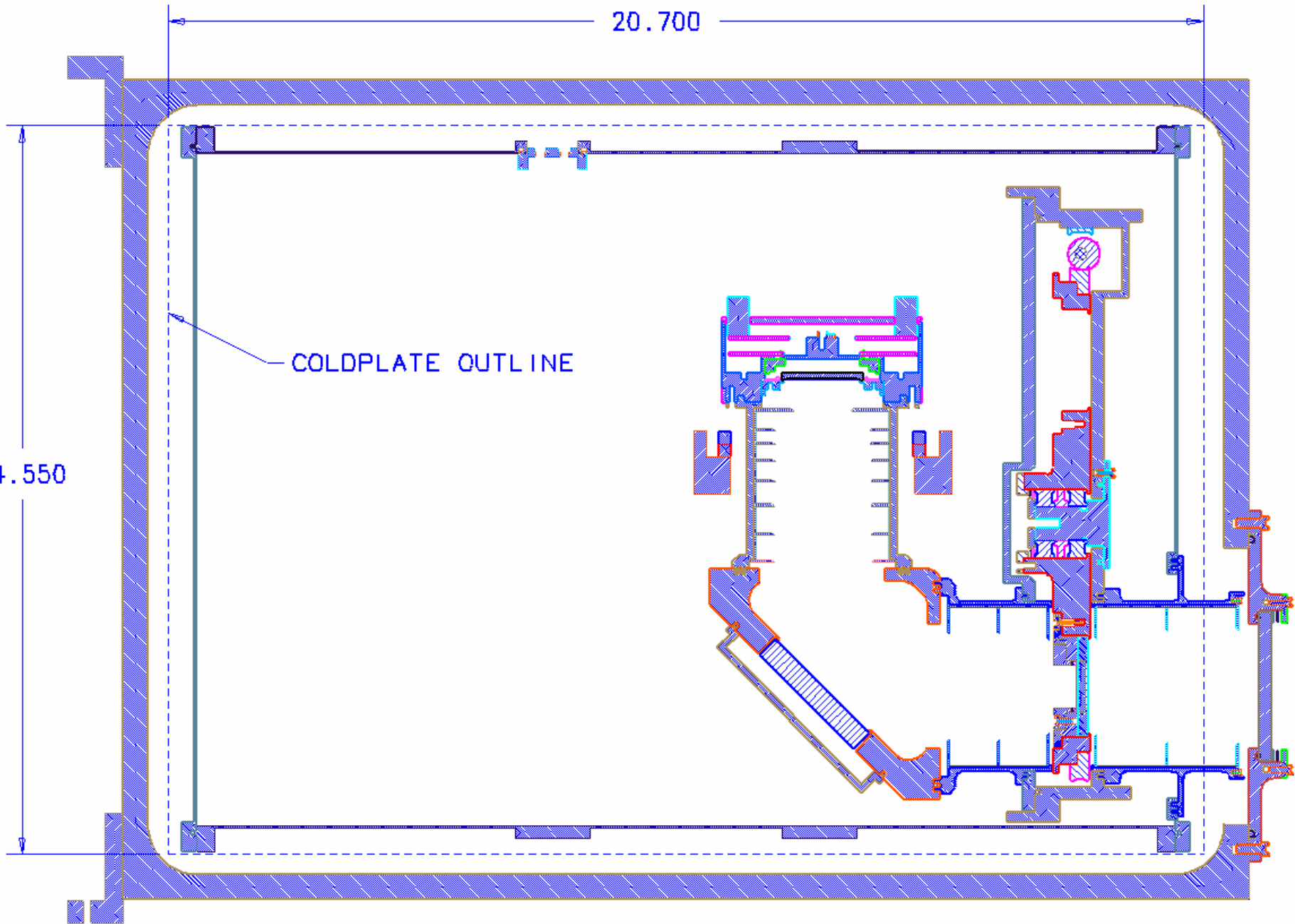

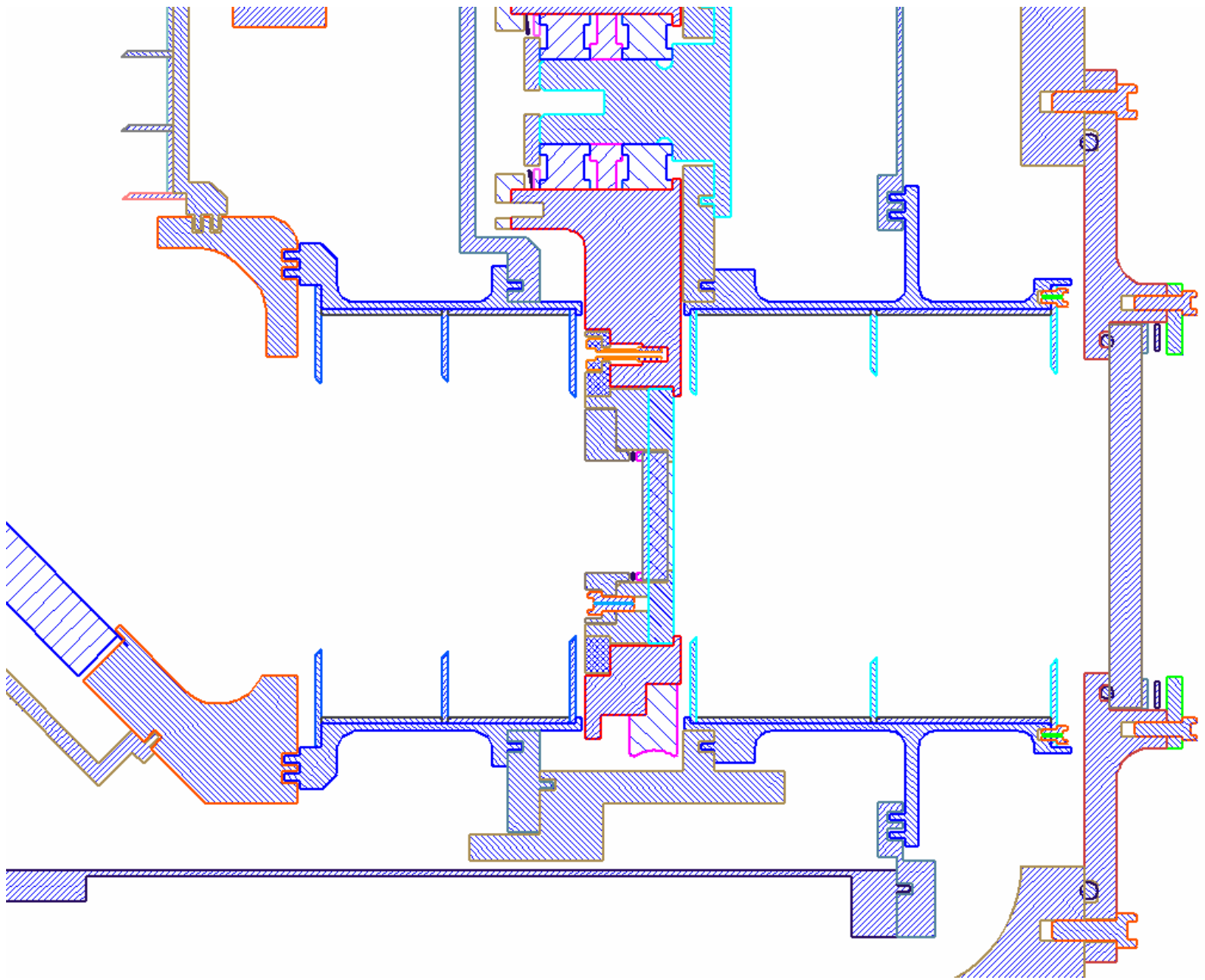

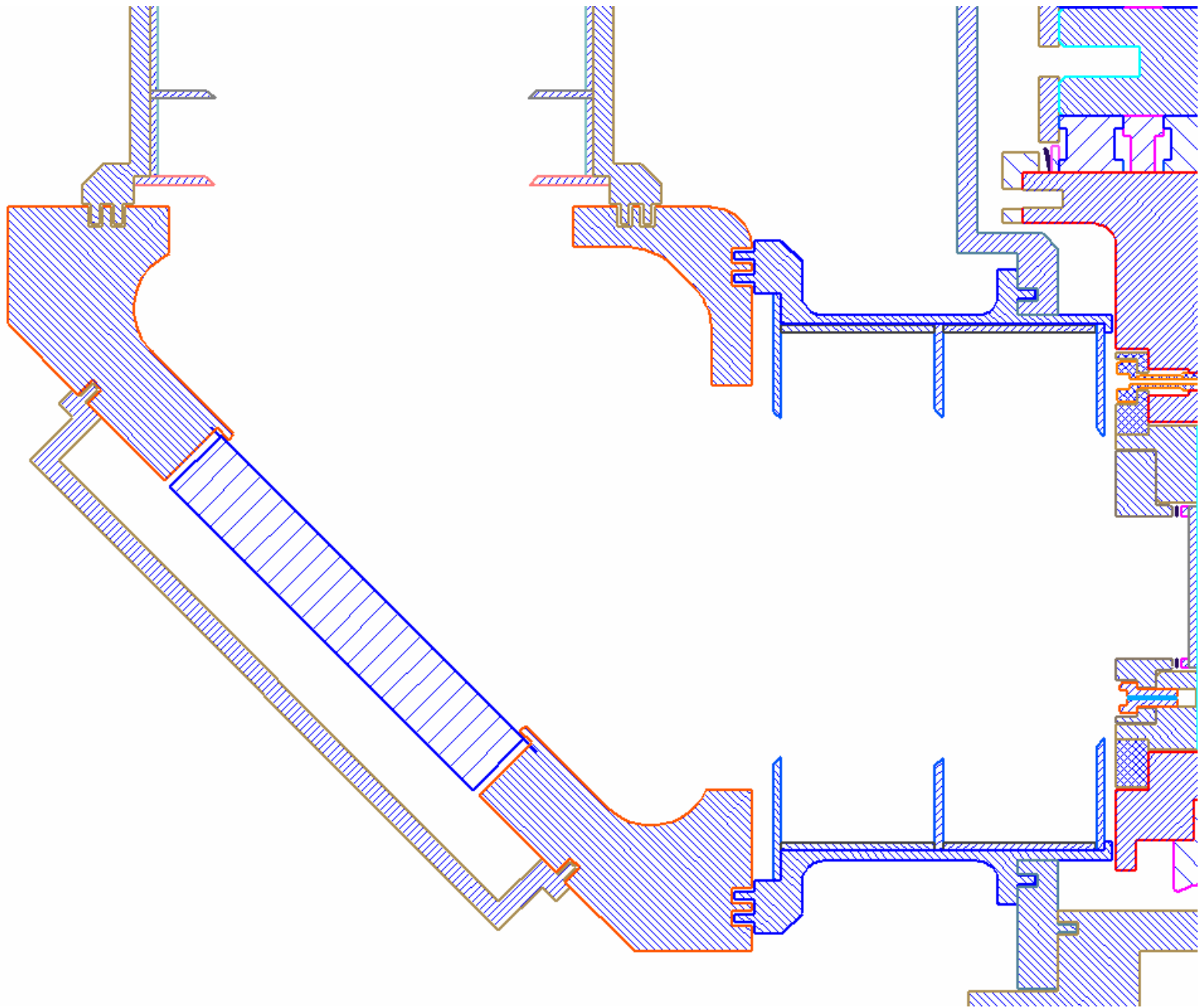

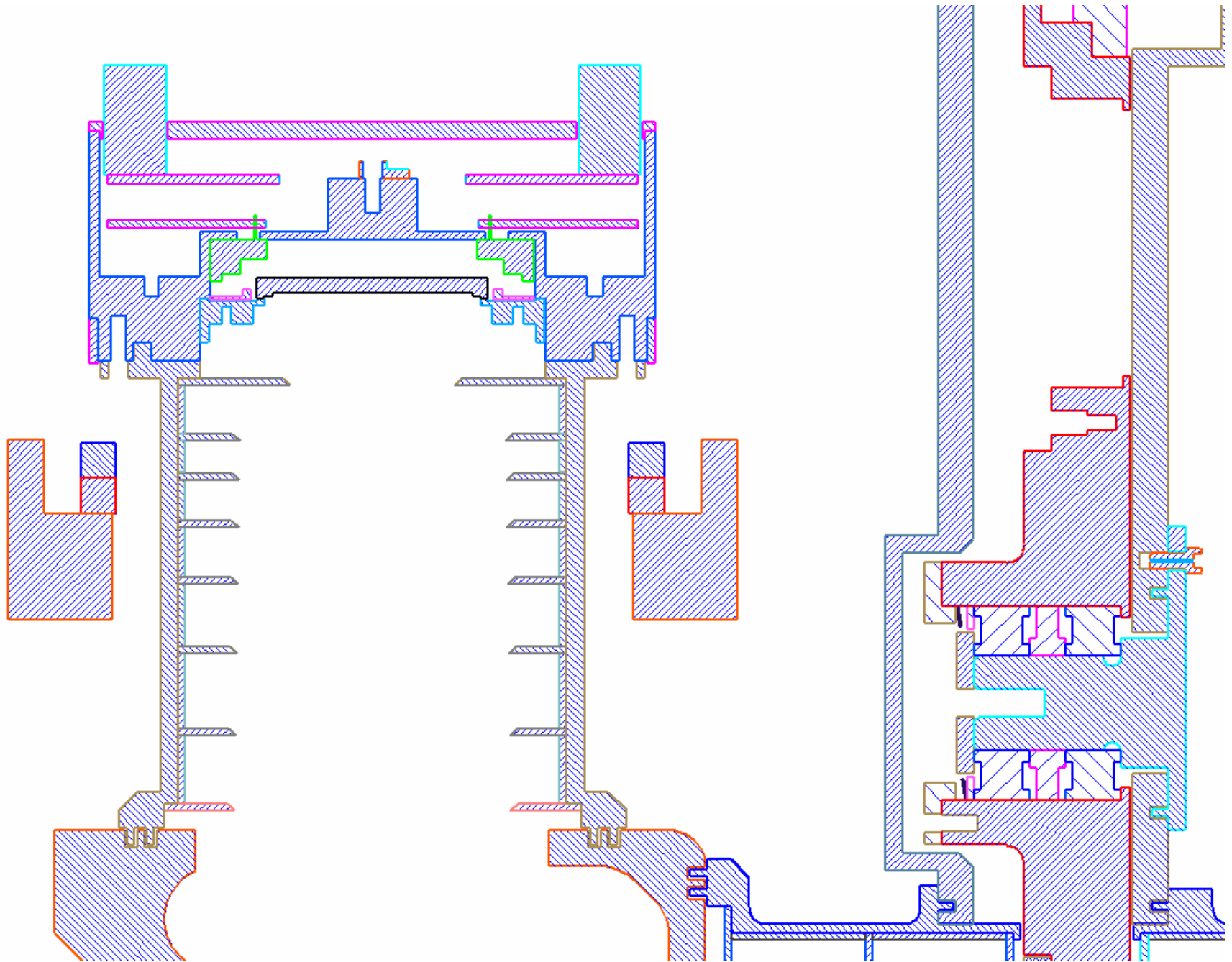

NAC Dewar Assembly Order:

- Precharge-can and coldstraps are bolted to the coldplate.
- Coldplate is attached to the rear vacuum jacket cover with G-10 flexures.
- Optics are built up on the coldplate:
 - ∞ Filterwheel assembly is bolted and pinned to the coldplate.
 - ∞ Baffle assembly is bolted to the filterwheel assembly.
 - ∞ Fold mirror mount and detector mount are bolted and pinned to the coldplate.
 - ∞ Detector assembly and detector baffle assembly are bolted to the detector mount.
- Radiation shield assembly is bolted to the coldplate.
- Vacuum jacket is bolted and pinned to the rear cover.
- Front baffle assembly is inserted through the window opening in the vacuum jacket and bolted to the filterwheel assembly using threaded access holes in the radiation shield. The access holes are then sealed with 1/4-20 screws.
- The window cell assembly is bolted over the ...
- Cryocooler box is bolted to the rear vacuum jacket cover.
- Cryocooler and precharge-can fittings are bolted to the cryocooler box. Coldstraps are attached to the cryocooler through an access hole.
- Filterwheel motor is attached to the rear vacuum jacket cover.