

NOTES: UNLESS OTHERWISE SPECIFIED

1. REMOVE ALL BURRS AND SHARP EDGES .03.

2. MACHINED SURFACE ROUGHNESS 125 ✓

3. MATERIAL: .75 X 1.00 X 2.75 OFHC COPPER BAR.
ADD STOCK FOR MACHINING AS REQUIRED.

REVISIONS				
LTR	DESCRIPTION	ECR	DATE	BY

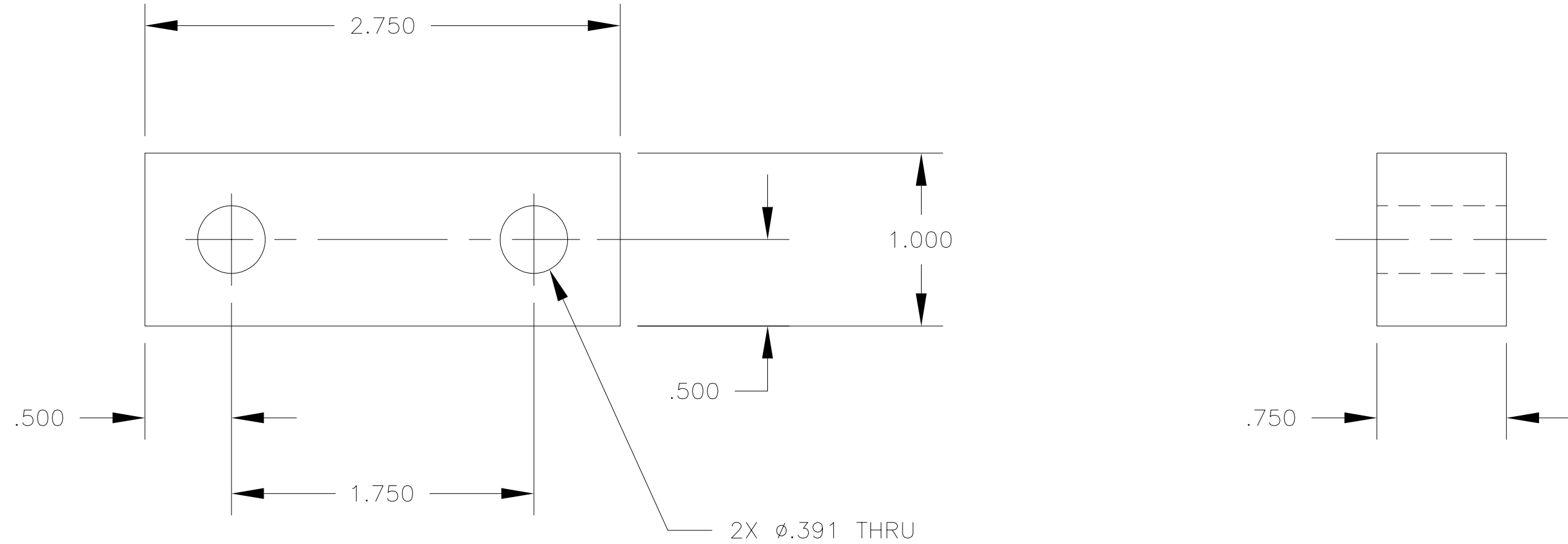

TOLERANCES UNLESS OTHERWISE NOTED
 DECIMALS FRACTIONS ANGULAR
 .XX ± .03 ± 1/32 ± 0°30'
 .XXX ± .010

NATIONAL OPTICAL ASTRONOMY OBSERVATORIES
 OPERATED BY THE
 ASSOCIATION OF UNIVERSITIES FOR RESEARCH IN ASTRONOMY
 UNDER COOPERATIVE AGREEMENT WITH
 NATIONAL SCIENCE FOUNDATION

NEXT ASSEMBLY C10393P-38		NAME FILAMENT BUSS TIE BAR			REF FILE 8384	
SCALE FULL		DESIGNED BY A.J. GERZOFF		DATE 931101		DWG NO 2107.0006137B
ISSUED		DRAWN BY A.J. GERZOFF		DATE 931101		
		CHECKED BY		DATE		APPROVED BY
						DATE
						RELEASED
						SHEET 1 OF 1