

BILL OF MATERIAL

ITEM	QTY.	MATERIAL	DESCRIPTION	WEIGHT
------	------	----------	-------------	--------

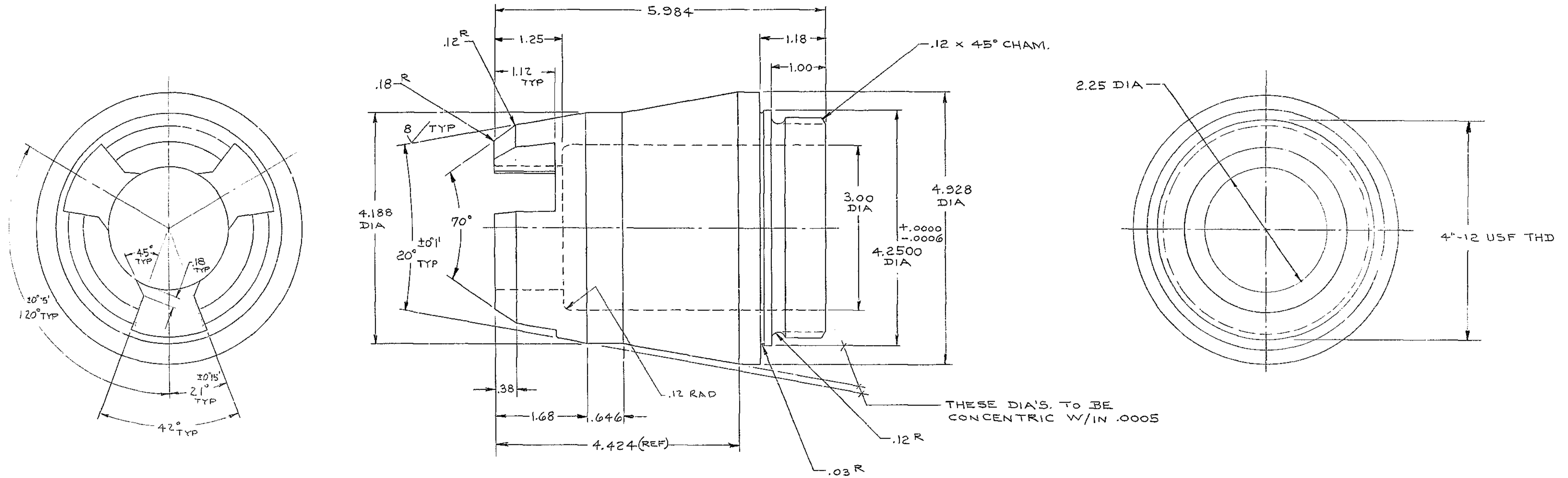

MATL: C1018 STEEL
 FINISH: HARD CHROME .0003/.0005 THK
 (ALL DIM. TO BE HELD AFTER PLATING)

- NOTES:
- 5-BREAK SHARP EDGES .03
 - 4-IDENTIFY BY _____ AT LOCATION - 4 - , "AURA INC. MADE IN U.S.A."
 - 3-STAMP MATCH MARKS ON ALL MATING PARTS WHERE NECESSARY.
 - 2-PROJECT DRAWINGS _____
 - 1-FOR NEXT ASSY. SEE 2150.530-E302

KITT PEAK NATIONAL OBSERVATORY
 OPERATED BY THE
 ASSOCIATION OF UNIVERSITIES FOR RESEARCH IN ASTRONOMY, INC.
 UNDER CONTRACT WITH
 NATIONAL SCIENCE FOUNDATION

150 INCH STELLAR TELESCOPE REF. FILE 1193

NAME PIN, TAPERED LOCK-SECONDARY FLIP LOCK ASSY SCALE FULL PRINT ISSUED

TOLERANCES UNLESS OTHERWISE NOTED:

DECIMAL DIMENSIONS	00.00 ± .010
	00.000 ± .003
FRACTIONAL DIMENSIONS	UP TO 18" ± 1/64
	18" TO 30" ± 1/32
	30" & OVER ± 1/16
ANGLES	± 0° - 30'
ALL SURFACES	TO HAVE 125/ FINISH UNLESS OTHERWISE NOTED.

DESIGNED BY	J.B.H.	DATE	4-13-70	APPROVED BY	L.K.R.	DATE	8-14-70
DRAWN BY	J.S.H.	DATE	6-17-70	APPROVED BY	A.A.	DATE	8-13-70
CHECKED BY	L.BRAUN	DATE	8-24-70	APPROVED BY	J.W.C.	DATE	8-13-70

REVISION	B	REVISION	REVISED & REDRAWN	ECR	0821	DATE	4-27-70	BY	J.B.H.
DRAWING NUMBER	2150.530-D325								