

# BILL OF MATERIAL

ITEM	QTY	MATERIAL	DESCRIPTION	WEIGHT
------	-----	----------	-------------	--------

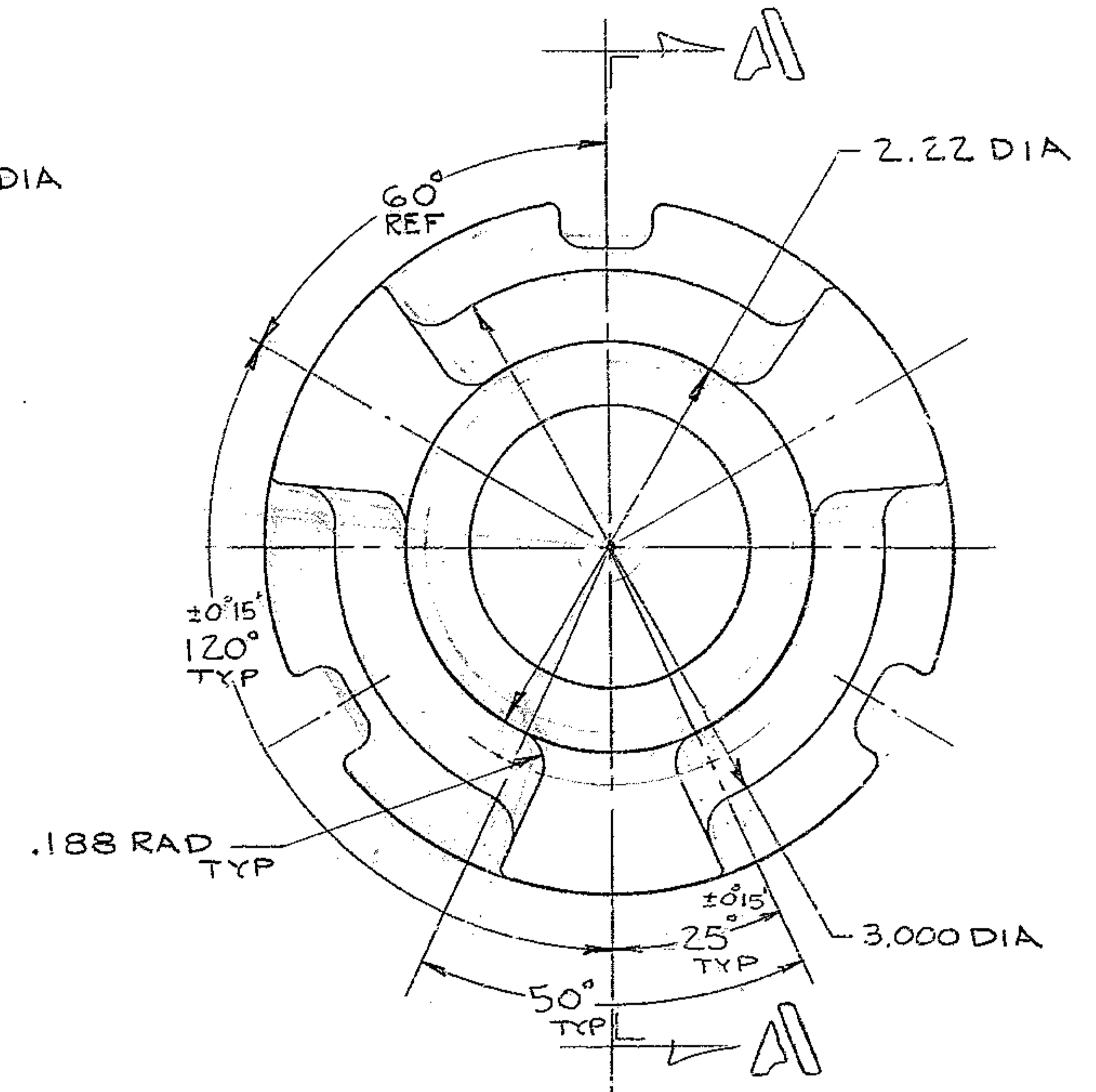
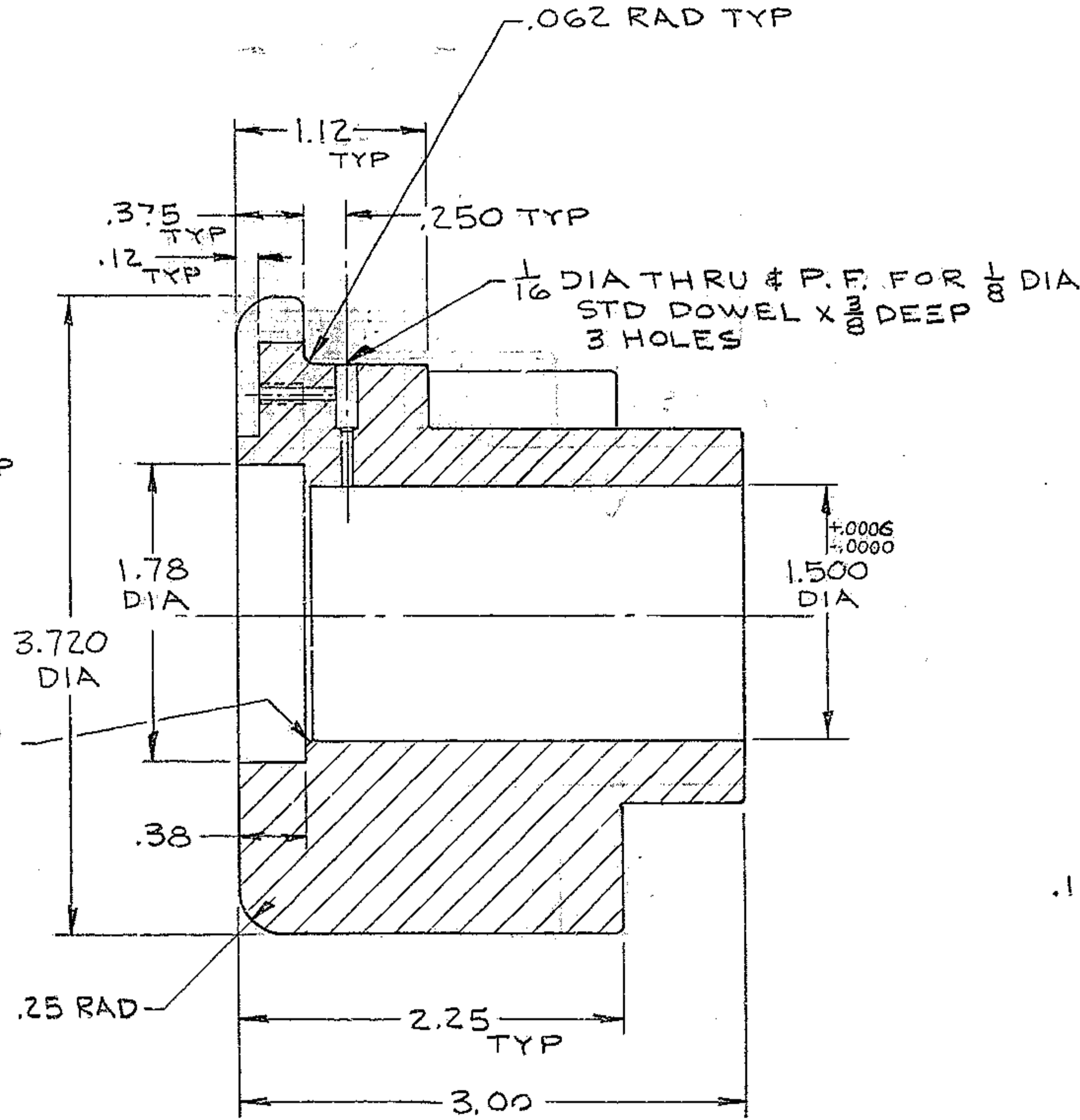
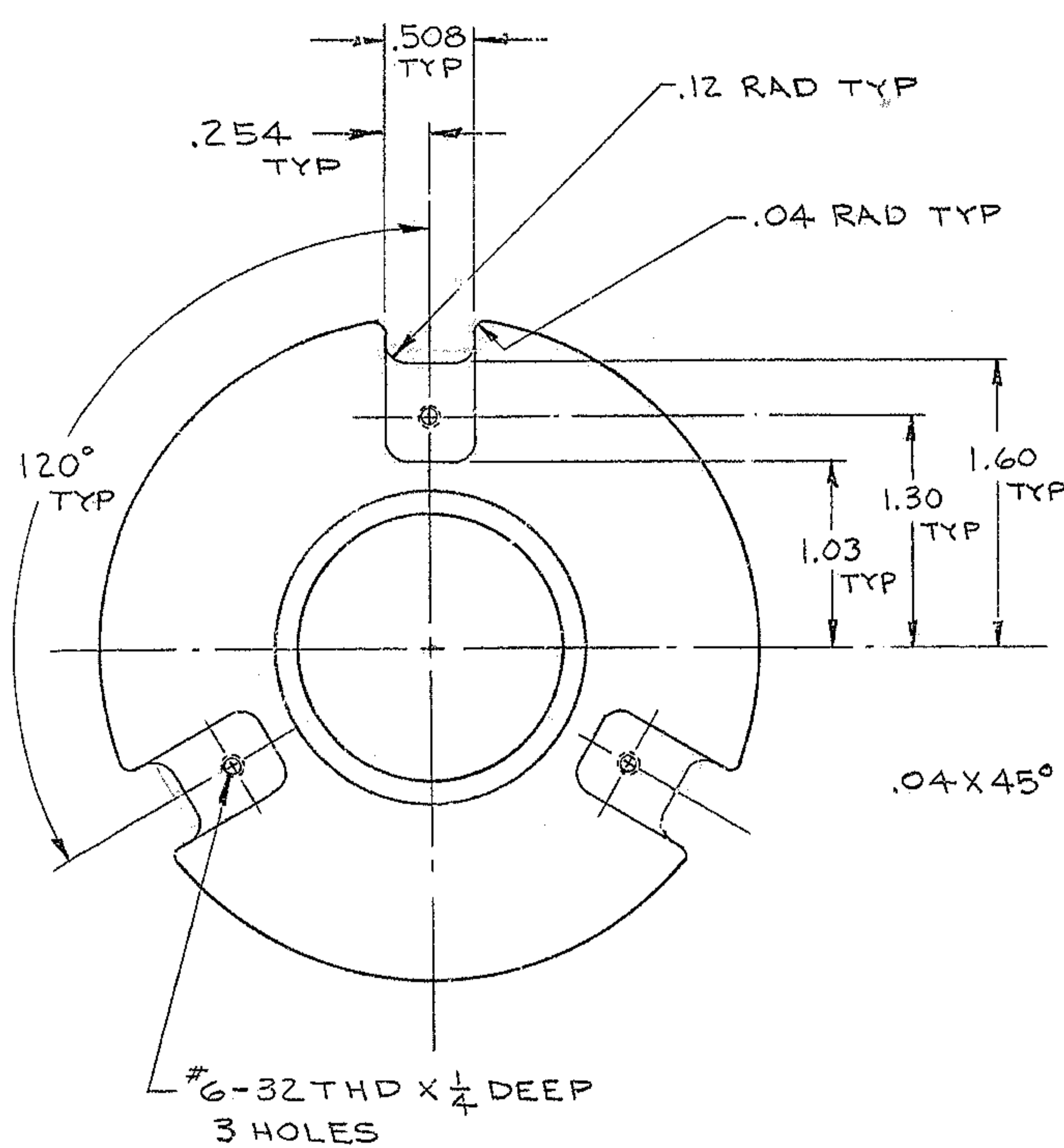

SECTION A-A

- 8. ALL DIM TO BE HELD AFTER PLATING.
  - 7. HARD CHROME .0003-.0005.
  - 6. HARDEN & DRAW R/C 60-62.
  - 5-BREAK SHARP EDGES .03
  - 4-IDENTIFY BY \_\_\_\_\_ AT LOCATION  "AURA INC. MADE IN U.S.A."
  - 3-STAMP MATCH MARKS ON ALL MATING PARTS WHERE NECESSARY.
  - 2-PROJECT DRAWINGS \_\_\_\_\_
  - 1-FOR NEXT ASSY. SEE 2150.530E.302
- NOTES-

LET.	REVISION	ECR	DATE	BY
B	REVISED & REDRAWN	0821	4-25-72	J.B.H.

**TOLERANCES UNLESS OTHERWISE NOTED**  
 DECIMAL DIMENSIONS  
 .00, .01 ± .010  
 .00, .000 ± .003  
 FRACTIONAL DIMENSIONS  
 UP TO 18' ± 1/64  
 18' TO 50' ± 1/32  
 50' & OVER ± 1/16  
 ANGLES ± 0° - 30'  
 ALL SURFACES  
 TO HAVE 125/ FINISH  
 UNLESS OTHERWISE NOTED.  
**MATERIAL:**  
 AISI-SAE O2 OIL  
 HARDENING TOOL  
 STEEL

**KITT PEAK NATIONAL OBSERVATORY**  
 OPERATED BY THE  
 ASSOCIATION OF UNIVERSITIES FOR RESEARCH IN ASTRONOMY, INC.  
 UNDER CONTRACT WITH  
 NATIONAL SCIENCE FOUNDATION

150 INCH STELLAR TELESCOPE  
 NAME HEAD - DRAW BAR,  
 SECONDARY FLIP LOCK ASSY.

REF. FILE 1193  
 SCALE FULL  
 PRINT ISSUED

DESIGNED BY J.B.HOEY DATE 4-11-70 APPROVED BY L.V.R. DATE 8-17-70  
 DRAWN BY J.B.HOEY DATE 6-16-70 APPROVED BY A.A. DATE 8-13-70  
 CHECKED BY L.BRAUN DATE 8-24-70 APPROVED BY J.W. DATE 8-13-70

DRAWING NUMBER 2150.530C314 REV. B