

REVISIONS			
LTR	DESCRIPTION	DATE	APPROVED
A	REVISED/AURA REQ	2-19-70	WR

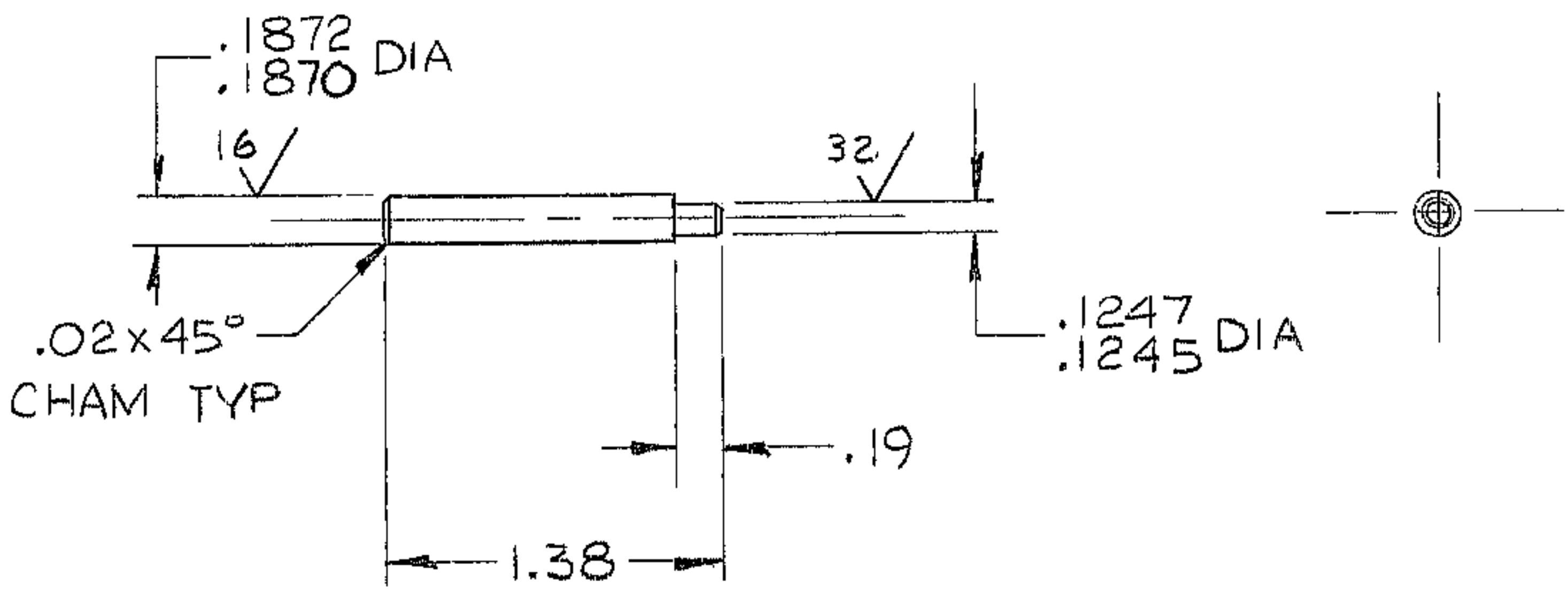

REF. FILE 1190

NO. REQ. - NOTED PER NEXT ASSEM.
 MAT'L - H.T. 416 ST. STL.
 FINISH - _____
 HT. TR.: - _____

N/A - 2150.570 E102 - (2) REQ'D (x2)
 N/A - 2150.590 E002 - (2) REQ'D (x3)
 N/A - 2150.590 E102 - (2) REQ'D (12) TOTAL

LIMITS ON MACHINED DIMENSIONS EXCEPT AS NOTED
 ANGULAR ± 1/2°
 LINEAR
 .X = ± .1
 .XX = ± .03 .01
 .XXX = ± .003 .003
 FRACTIONAL ± 1/32

BREAK ALL SHARP EDGES

150 INCH STELLAR TELESCOPE
 DRAWN MMS / 3-27-69
 CHECK WR 2-12-70
 ENGR *R* 2-20-70

APPROVED

Western GEAR CORPORATION HEAVY MACHINERY DIVISION
 EVERETT, WASHINGTON

REDUCTION GEAR SHAFT
 SEC. & PRIME FOCUS ASS'Y

SIZE A	CODE IDENT NO. 16603	2150.505 A109	REV A
SCALE FULL	WT. .01	LB SHEET	OF