

REVISIONS			
LTR	DESCRIPTION	DATE	APPROVED
A	REVISED PER AURA REQ.	3-31-70	WR
B	No. REQ. WAS 2	10-14-96	J.H.

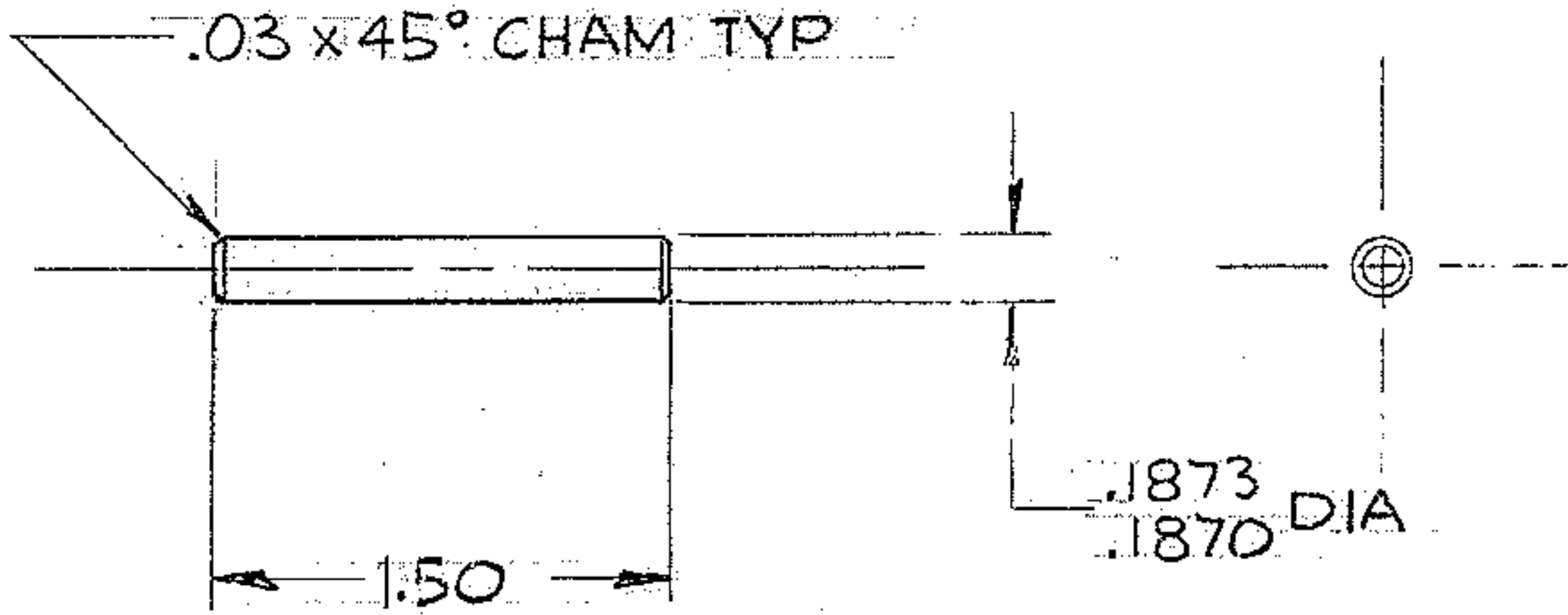

REF.
FILE 1190

NO. REQ. - 1 PER NEXT ASSEM.
MAT'L - H.T. 416 ST. STL.
FINISH -
HT. TRT. -

N/A-2150.501E002

LIMITS ON MACHINED DIMENSIONS EXCEPT AS NOTED
ANGULAR ± 1/2°
LINEAR
X = ± .002
XX = ± .01
XXX = ± .003
FRACTIONAL ± 1/32
BREAK ALL SHARP EDGES

150 INCH STELLAR TELESCOPE

DRAWN MMS/4-23-69
CHECK WR 4-2-70
ENGR P 4/10/70

ORIGINAL

APPROVED



HEAVY MACHINERY DIVISION
EVERETT, WASHINGTON

ACCESS DOOR LATCH PIN
SEC. MIRROR & PRIME FOCUS ASSY

SIZE	CODE IDENT NO.	REV
A	16603 2150.501A124	B

SCALE FULL WT. — LB SHEET 1 OF 1