

BILL OF MATERIAL

ITEM	QTY.	MATERIAL	DESCRIPTION	WEIGHT
				.14

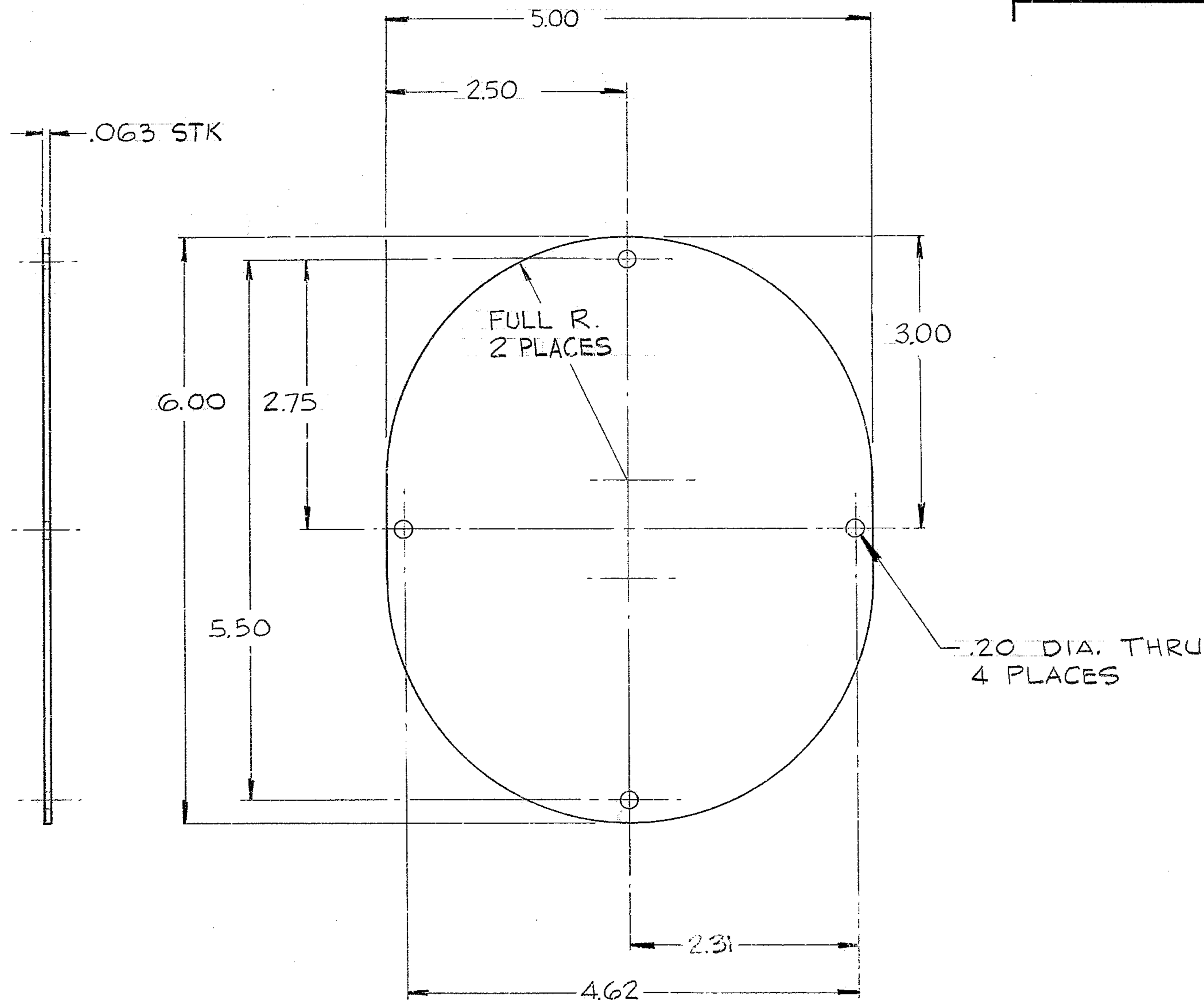

- 8. MATL: AL ALLOY
  - 7. BLACK ANODIZE PER MIL-A-8625 TYPE II, CL2, DIM. AFTER ANODIZE.
  - 6. INTERPRET DWG PER USASI-Y14.5-1966
  - 5. BREAK SHARP EDGES .02
  - 4. IDENTIFY BY TAG AT LOCATION 4, "AURA INC. MADE IN U.S.A."
  - 3. STAMP MATCH MARKS ON ALL MATING PARTS WHERE NECESSARY.
  - 2. PROJECT DRAWINGS
  - 1. FOR NEXT ASSY. SEE 2150.340 E 002
- NOTES-

TOLERANCES UNLESS OTHERWISE NOTED				
DECIMAL DIMENSIONS				
00.00 ± .010				
00.000 ± .003				
FRACTIONAL DIMENSIONS				
UP TO 18' ± 1/64				
18' TO 50' ± 1/32				
50' & OVER ± 1/16				
ANGLES ± 0° -30'				
ALL SURFACES TO HAVE 125 ✓ FINISH UNLESS OTHERWISE NOTED.				
LET.	REVISION	ECR.	DATE	BY

<b>KITT PEAK NATIONAL OBSERVATORY</b>			
OPERATED BY THE ASSOCIATION OF UNIVERSITIES FOR RESEARCH IN ASTRONOMY, INC. UNDER CONTRACT WITH NATIONAL SCIENCE FOUNDATION			
150" STELLAR TELESCOPE			REF. FILE 1186
NAME COVER			SCALE 1/1
			PRINT ISSUED
DESIGNED BY	DATE	APPROVED BY	DATE
DRAWN BY PARNES	8-25-71	APPROVED BY [Signature]	10/12/71
CHECKED BY CHADD	10-19-71	APPROVED BY [Signature]	10-19-71
DRAWING NUMBER 2150.340 C042			REV.