

NOTES: UNLESS OTHERWISE NOTED

1. REMOVE ALL BURRS AND SHARP EDGES $\text{---} R \text{ MAX}$
2. MACHINED SURFACE ROUGHNESS $\sqrt{125}$
3. MAT'L: .032 X .002
LAMINATED SHIM STOCK

REVISIONS				
LTR	DESCRIPTION	ECR	DATE	BY/APVD
A	ADDED W/A 2150.0005605E	1186	5-7-93	JH

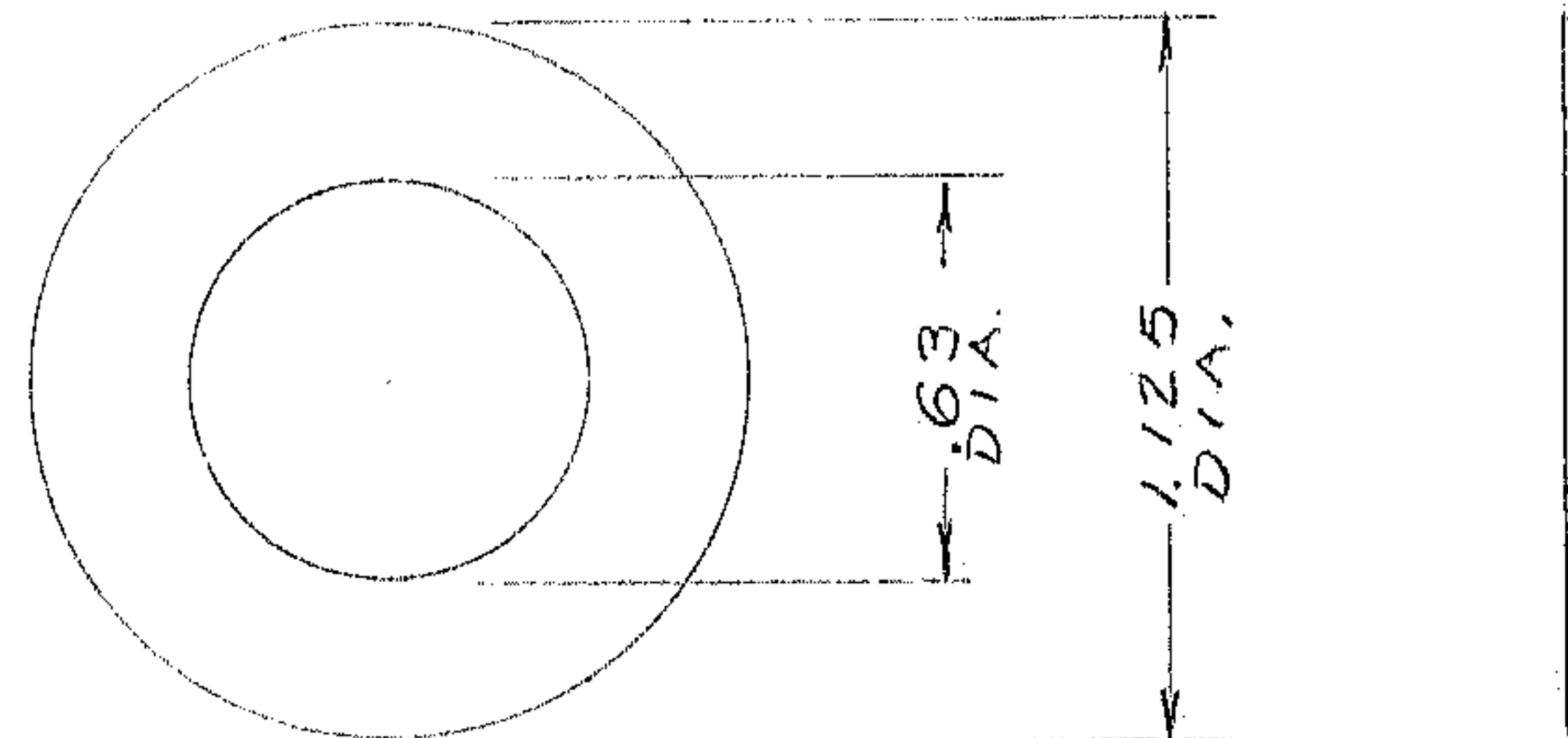

TOLERANCES UNLESS OTHERWISE NOTED DECIMALS FRACTIONS ANGULAR .XX ± .03 ± — ± 0° 30' .XXX ± .010			KITT PEAK NATIONAL OBSERVATORY <small>OPERATED BY THE ASSOCIATION OF UNIVERSITIES FOR RESEARCH IN ASTRONOMY, INC. UNDER CONTRACT WITH NATIONAL SCIENCE FOUNDATION</small>			
NEXT ASSEMBLY 2150.340-E502 2150.0005605E		NAME SHIM WASHER		REF FILE 1186		
SCALE 2 X PRINT ISSUED	DESIGNED BY <i>M. J. Olson</i>	DATE 8/31/84	APPROVED BY <i>J. DeLima</i>	DATE 8-31-84	DWG NO. 2150.340-B507	REV A
	DRAWN BY <i>M. J. Olson</i>	DATE 8/31/84	APPROVED BY <i>J. DeLima</i>	DATE 8-31-84	RELEASE DATE 11-12-84	
	CHECKED BY	DATE	APPROVED BY	DATE		