

RELIEF .02 x .02 MAX.

.06 x 45°

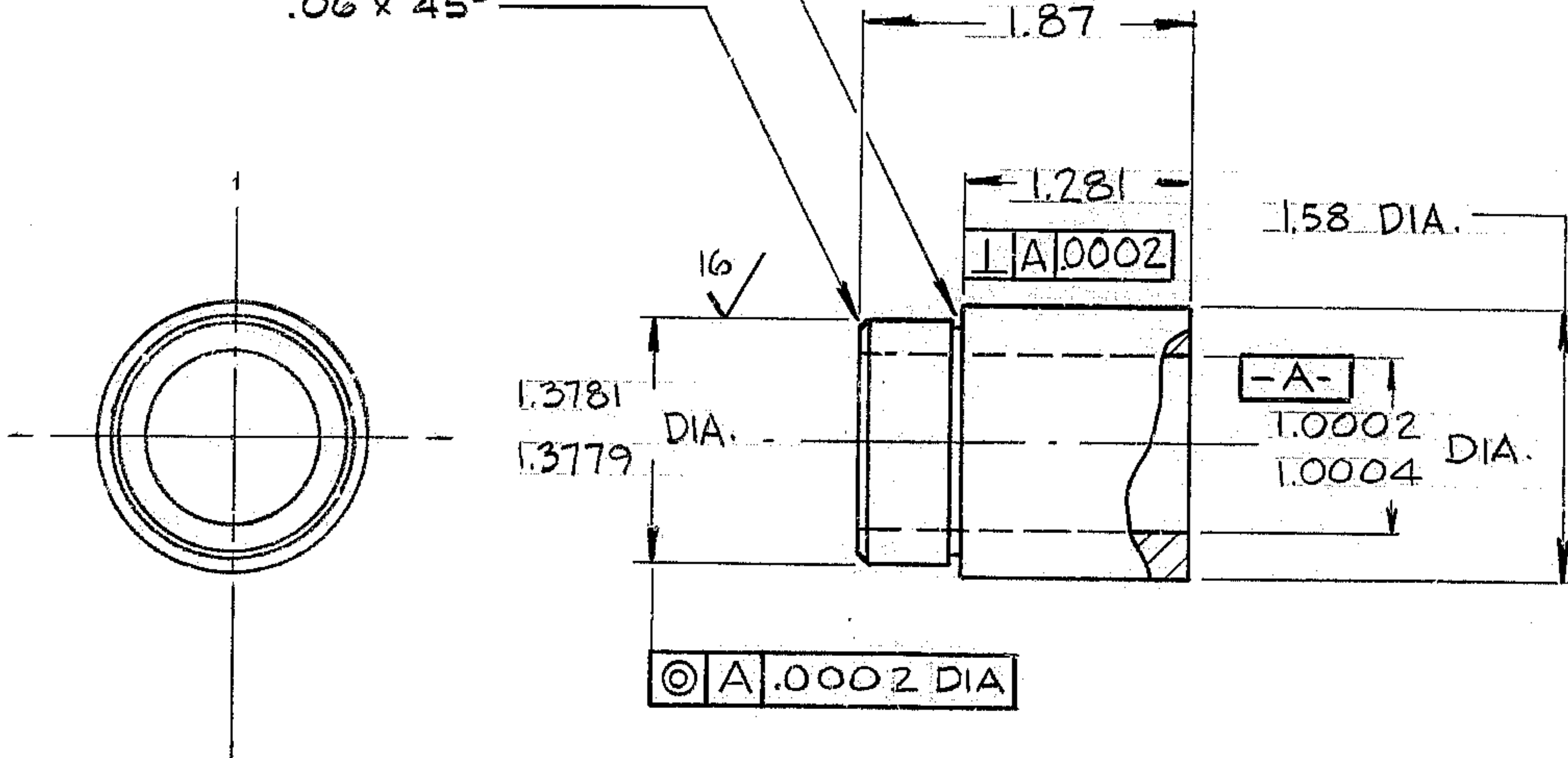

6- MAT'L: STEEL AISI 4340
 5- HEAT TREAT R/C 32-36
 4- INTERPRET DWG PER USAS1-Y14.5-1966
 3- IDENTIFY BY TAG AT LOCATION 3, "DRAWING MADE IN U.S.A."
 2- ~~STAMP MATCH MARKS ON ALL MATING PARTS WHERE NECESSARY~~
 1- FOR NEXT ASSY. SEE 2150-340 E 002
 2150 000 5013 E, 2150 000 5014 E

TOLERANCES UNLESS OTHERWISE NOTED			
DECIMAL DIMENSIONS 00.00 ± .010 00.000 ± .003			
FRACTIONAL DIMENSIONS UP TO 18' ± 1/64 18' TO 50' ± 1/32 50' & OVER ± 1/16			
BREAK SHARP EDGES .02			
ALL SURFACES TO HAVE 125 FINISH UNLESS OTHERWISE NOTED.			
DES'D BY	DATE	APP'D BY	DATE
DRN BY PARNESS	8-24-71	APP'D BY Bares	10/19/71
CH'KD BY CHADD	10-19-71	APP'D BY EG	10-19-71
LET.	REVISION ON	ECR	DATE BY
A	ADDED N/A No's	3274	8-10-70 JH

KITT PEAK NATIONAL OBSERVATORY
 OPERATED BY THE
 ASSOCIATION OF UNIVERSITIES FOR RESEARCH IN ASTRONOMY, INC.
 UNDER CONTRACT WITH
 NATIONAL SCIENCE FOUNDATION

150" STELLAR TELESCOPE REF. FILE 1186

NAME: PINION RETAINER SCALE 1/1
 PRINT ISSUED

DRAWING NUMBER: 2150-340 B 032 REV. A