

THIS DOCUMENT CONTAINS INFORMATION PROPRIETARY TO WESTERN GEAR CORPORATION. ALL DESIGN, MANUFACTURING, REPRODUCTION, USE, PATENT, AND SALES RIGHTS REGARDING THE SAME ARE HEREBY EXPRESSLY RESERVED BY WESTERN GEAR CORPORATION. THIS DOCUMENT IS SUBMITTED FOR REFERENCE PURPOSES ONLY AND SHALL NOT BE DISCLOSED TO ANY UNAUTHORIZED PERSON OR INCORPORATED INTO ANY OTHER PROJECT.

REVISIONS				
ZONE	LTR	DESCRIPTION	DATE	APPROVED

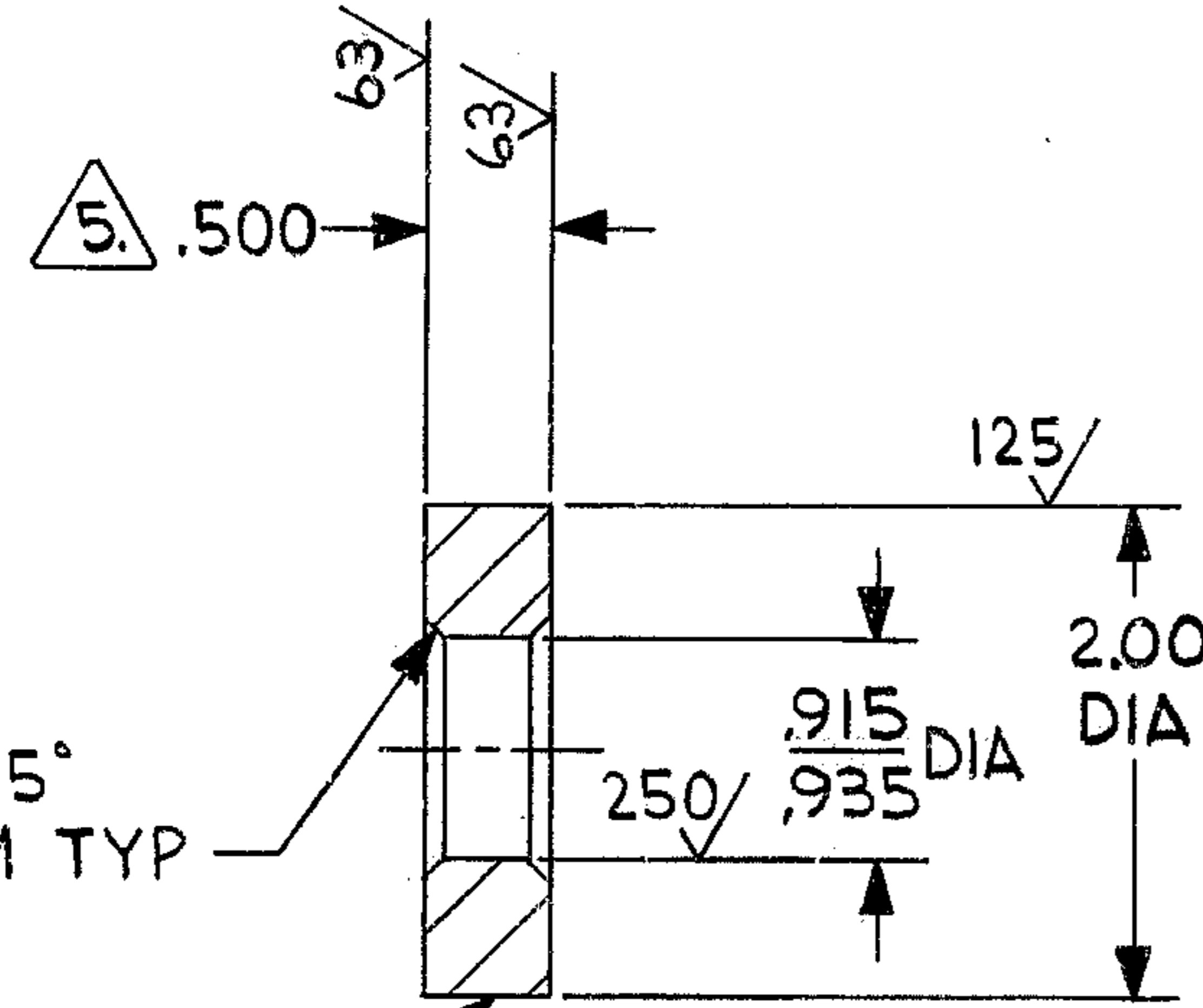

- NOTES: UNLESS OTHERWISE SPECIFIED:
- 1.- ALL DIMENSIONS ARE IN INCHES.
 - 2.- INTERPRET DIMENSIONING & TOLERANCING PER USA STANDARD USASI-Y14.5-1966.
 - 3.- MATERIAL: STEEL BAR, 4340 QQ-S-624.
 - 4.- HEAT TREAT: R_C 28-32 PER MIL-S-690.
 - 5.- SPACERS TO BE PROCESSED IN SETS OF 18 PIECES. THICKNESS WITHIN SETS TO BE WITHIN .0002.

REF. FILE 1185

NEXT ASSY: 2150.330E002 (82402-44175R302)

LIMITS ON MACHINED DIMENSIONS EXCEPT AS NOTED ANGULAR ± 1° 0' LINEAR X = ± .1 .XX = ± .03 .XXX = ± .010 FRACTIONAL ± 1/32 BREAK ALL SHARP EDGES	150 IN STELLAR TELESCOPE MTG		WESTERN HEAVY MACHINERY DIVISION GEAR CORPORATION EVERETT, WASHINGTON	
	DRAWN <i>Gallardo</i> 10-23-69		SPACER, ASSEMBLY DECLINATION	
	CHECK <i>VVG</i> 10-24-69			
	ENGR <i>VVG</i> 10-24-69		SIZE B	CODE IDENT NO. 16603
APPROVED <i>[Signature]</i>		SCALE 1/1	WT. CALC - LB	SHEET 1 OF 1

REV

44175C314