

- NOTES: UNLESS OTHERWISE NOTED
1. REMOVE ALL BURRS AND SHARP EDGES $\frac{1}{32}$ R MAX
 2. MACHINED SURFACE ROUGHNESS $\sqrt{125/32}$

| REVISIONS | | | | | |
|-----------|----------------------------------|------|---------|----------|------|
| LTR | DESCRIPTION | ECR | DATE | BY | APVD |
| A | CHG'D. RFN NO. FROM 1145 TO 1146 | 1863 | 5-17-77 | D. L. B. | 768 |

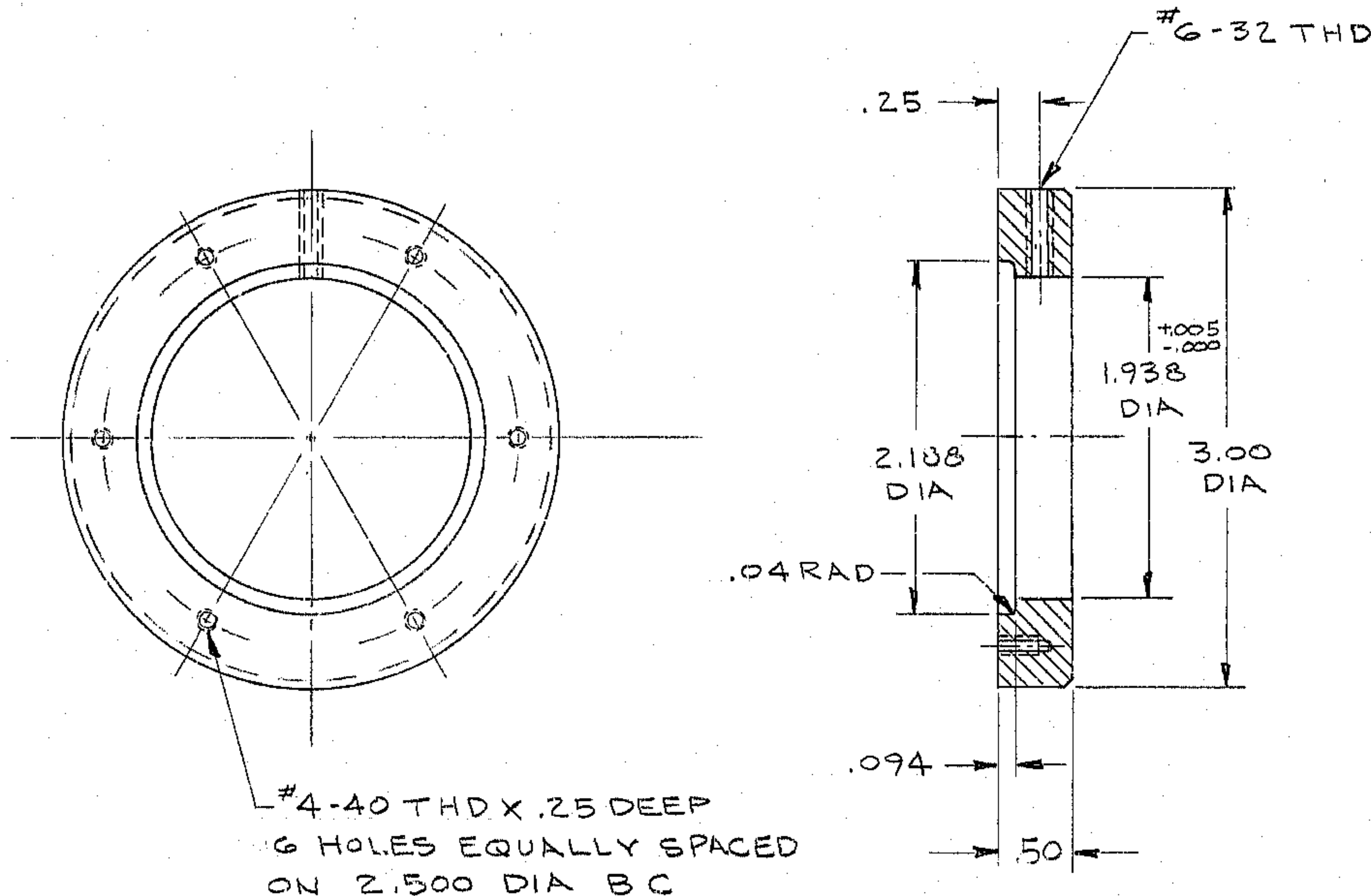

MATERIAL: TG ALUMI
1 REQ'D

| | | | | | | |
|--------------------------------------|--|---------------------|---|------------------|--------------------------|----------|
| TOLERANCES UNLESS OTHERWISE NOTED | | | KITT PEAK NATIONAL OBSERVATORY <small>OPERATED BY THE ASSOCIATION OF UNIVERSITIES FOR RESEARCH IN ASTRONOMY, INC.</small> <small>UNDER CONTRACT WITH NATIONAL SCIENCE FOUNDATION</small> | | | |
| DECIMALS .XX ± .03 .XXX ± .010 | FRACTIONS $\pm \frac{1}{64}$ | ANGULAR ± 0° 30' | | | | |
| NEXT ASSEMBLY 2150.300 -E102 | NAME HUB-OIL SLINGER DAMPER ASSY. R.A. DRIVE | | REF FILE 1182 | | | |
| SCALE FULL | DESIGNED BY J.B. Jones | DATE 3-17-73 | APPROVED BY A.A.A. | DATE 10-19-73 | DWG NO. 2150.300-B120 | REV A |
| PRINT ISSUED | DRAWN BY J.B. Jones | DATE 3-22-73 | APPROVED BY | DATE | RELEASE DATE 10-22-73 | |
| | CHECKED BY | DATE | APPROVED BY | DATE | | |