

5

4

3

2

1

THIS DOCUMENT CONTAINS INFORMATION PROPRIETARY TO WESTERN GEAR CORPORATION. ALL DESIGN, MANUFACTURING, REPRODUCTION, USE, PATENT, AND SALES RIGHTS REGARDING THE SAME ARE HEREBY EXPRESSLY RESERVED BY WESTERN GEAR CORPORATION. THIS DOCUMENT IS SUBMITTED FOR REFERENCE PURPOSES ONLY AND SHALL NOT BE DISCLOSED TO ANY UNAUTHORIZED PERSON OR INCORPORATED INTO ANY OTHER PROJECT.

REVISIONS				
ZONE	LTR	DESCRIPTION	DATE	APPROVED

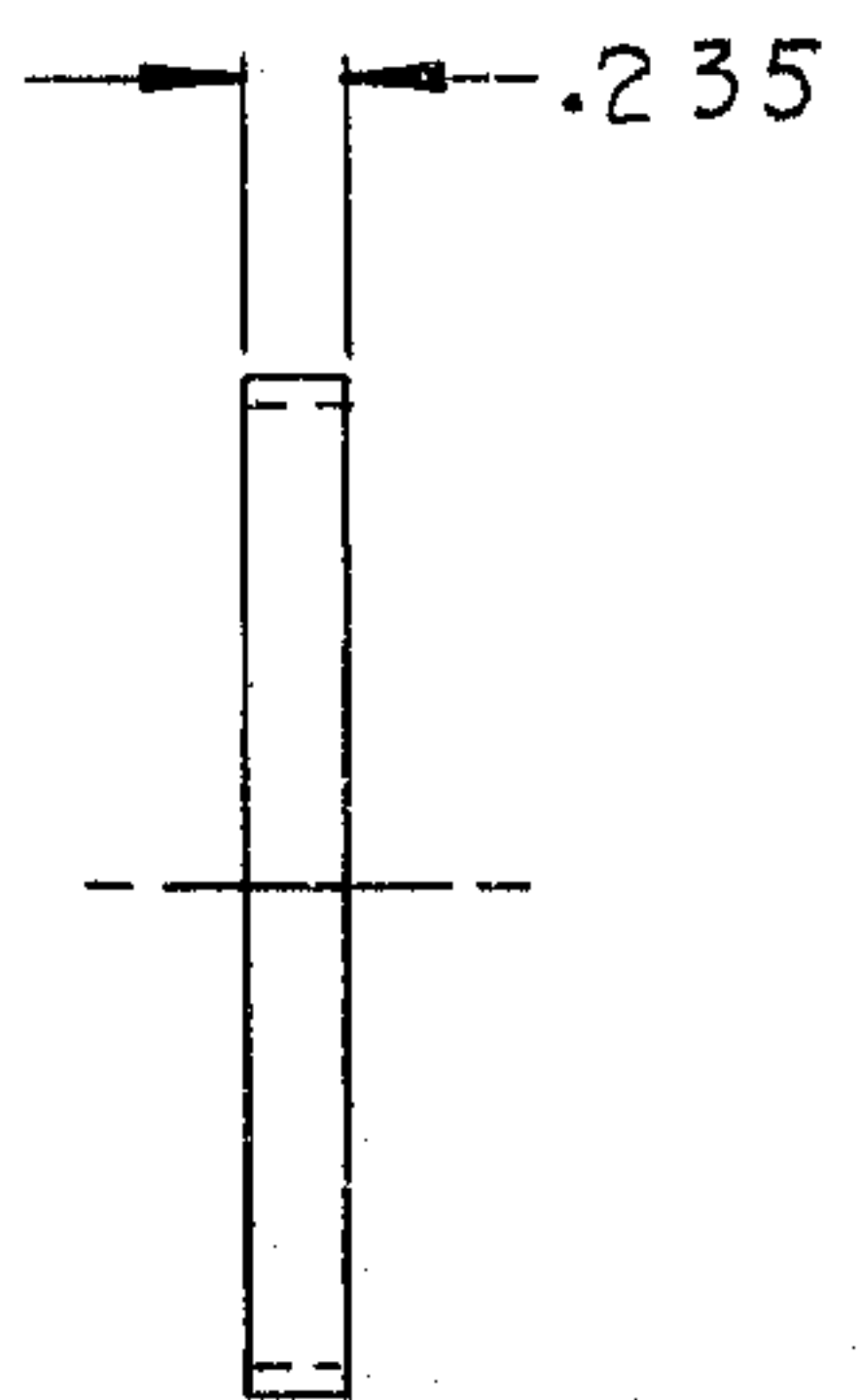
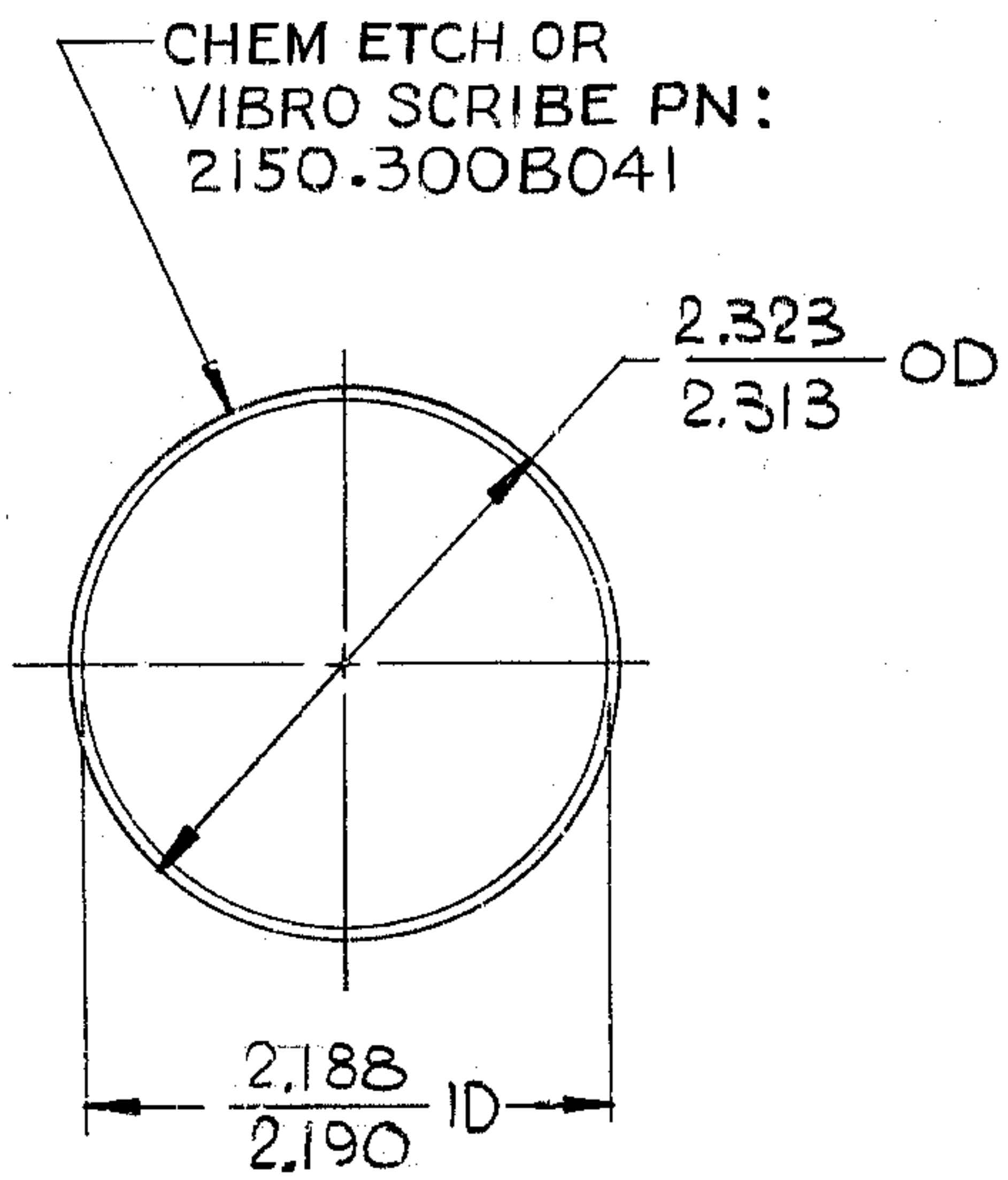

NOTES: UNLESS OTHERWISE SPECIFIED:

- 1.- ALL DIMENSIONS ARE IN INCHES.
- 2.- INTERPRET DIMENSIONING AND TOLERANCING PER USA STANDARD USAS1-Y14.5-1966.
- 3.- SURFACE ROUGHNESS 125/ ALL OVER PER USA STANDARD USAS-B46.1-1962.
- 4.- MATERIAL: BRASS TUBING HALF HARD.

REF. FILE 1181

NEXT ASSY: 2150.300E002 (82402-4 4175R2)

LIMITS ON MACHINED DIMENSIONS EXCEPT AS NOTED ANGULAR ± 1° 0' LINEAR X = ± .1 XX = ± .03 XXX = ± .010 FRACTIONAL ± 1/32  BREAK ALL SHARP EDGES	150 IN. STELLAR TELESCOPE MTG	<b>WESTERN</b> HEAVY MACHINERY DIVISION GEAR CORPORATION EVERETT, WASHINGTON		
	DRAWN J.P.B. 08-21-69	RING, SHIELD - DRIVE GEARBOX		
	CHECK B. SIML 10-21-69	SIZE <b>B</b>	CODE IDENT NO. <b>16603</b>	REV
	ENGR	2150.300B041		
82402-44175C41	APPROVED <i>[Signature]</i>	SCALE 1/1	WT. — LB SHEET 1 OF 1	

REV

44175C41