

THIS DOCUMENT CONTAINS INFORMATION PROPRIETARY TO WESTERN GEAR CORPORATION. ALL DESIGN, MANUFACTURING, REPRODUCTION, USE, PATENT, AND SALES RIGHTS REGARDING THE SAME ARE HEREBY EXPRESSLY RESERVED BY WESTERN GEAR CORPORATION. THIS DOCUMENT IS SUBMITTED FOR REFERENCE PURPOSES ONLY AND SHALL NOT BE DISCLOSED TO ANY UNAUTHORIZED PERSON OR INCORPORATED INTO ANY OTHER PROJECT.

.435
.445 DIA-THRU
.762 DIA x 90° CSK FAR SIDE
4 HOLES EQ SP ON 2.750 DIA BSC
⊕ A .030 DIA

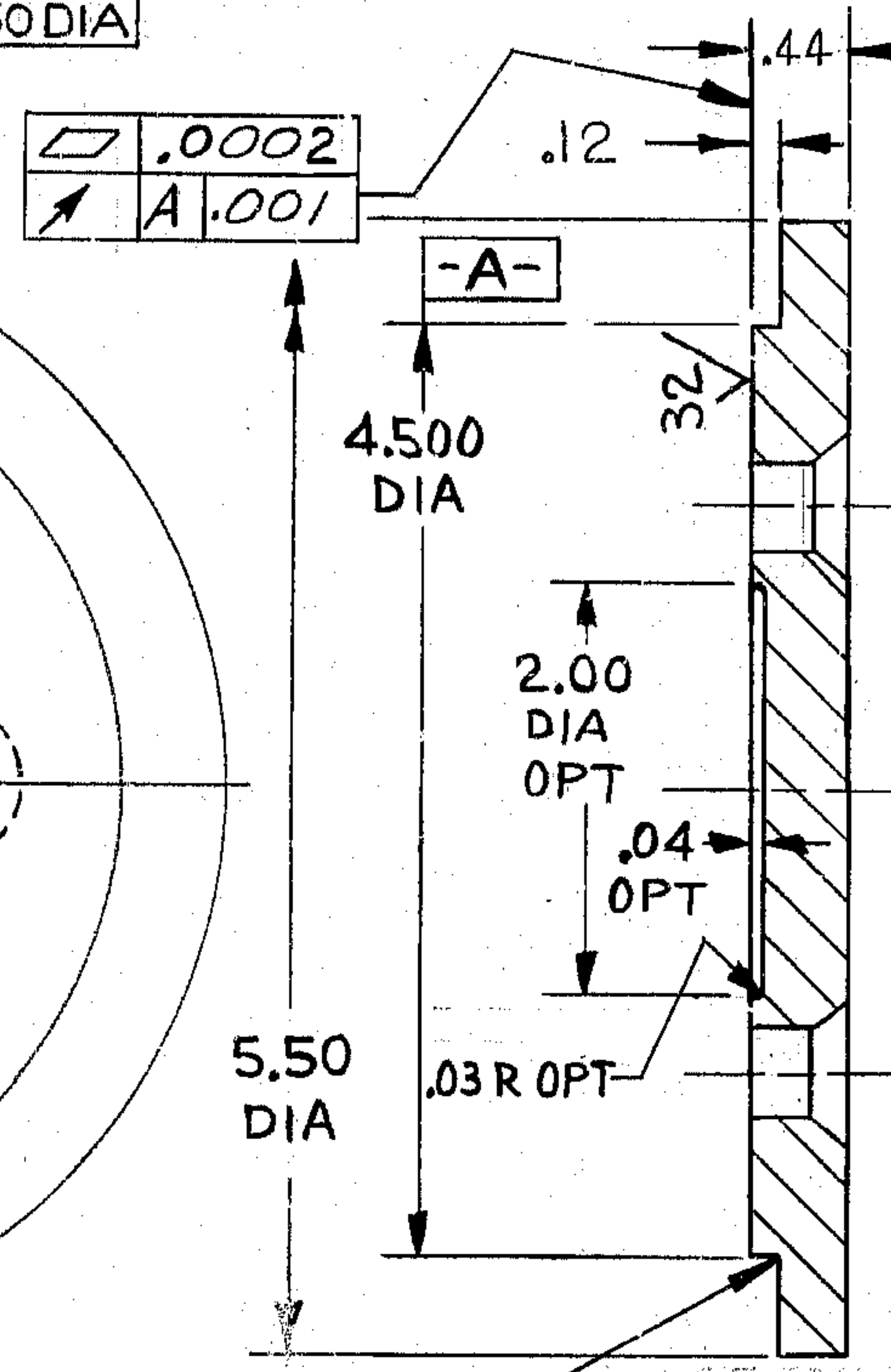
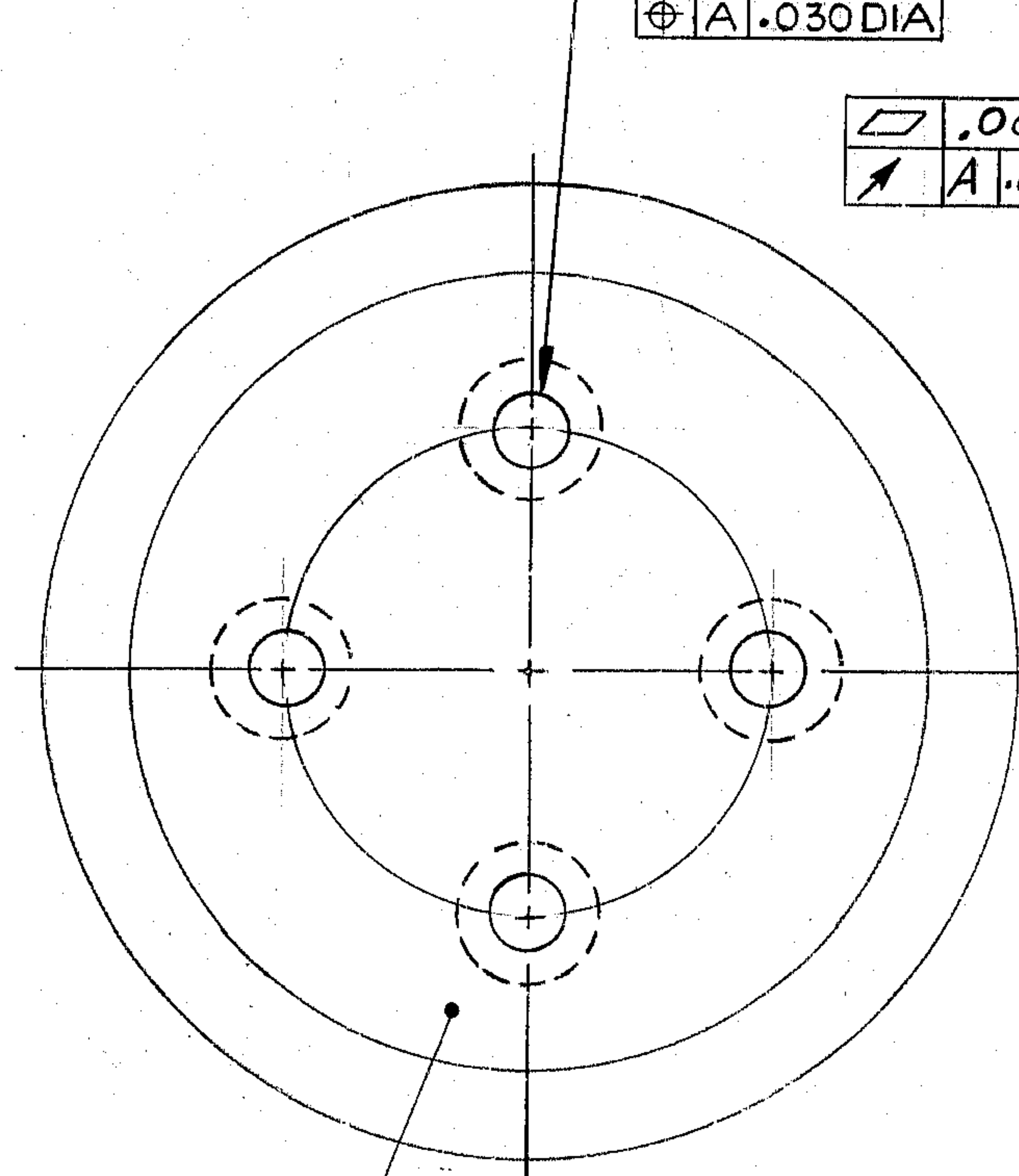

REVISIONS				
ZONE	LTR	DESCRIPTION	DATE	APPROVED
D-3	A	.0002 WAS .0014 ADDED OPT U-CUT	7-2-70	E

- NOTES: UNLESS OTHERWISE SPECIFIED:
- ALL DIMENSIONS ARE IN INCHES.
 - INTERPRET DIMENSIONING & TOLERANCING PER USA STANDARD USAS1-Y14.5-1966.
 - SURFACE ROUGHNESS 250/ ALL OVER PER USA STANDARD USAS-B46.1-1962.
 - MATERIAL: STEEL ASTM-A36

REF. FILE 118J

NEXT ASSY: 2150.300E002
(82402-44175R2)

CHEM ETCH OR VIBRO SCRIBE PART NO: 2150.300B015

LIMITS ON MACHINED DIMENSIONS EXCEPT AS NOTED ANGULAR ± 1° LINEAR .X = ± .1 .XX = ± .03 .XXX = ± .010 FRACTIONAL ± 1/32 BREAK ALL SHARP EDGES	150 IN. STELLAR TELESCOPE MTG	WESTERN GEAR CORPORATION HEAVY MACHINERY DIVISION EVERETT, WASHINGTON
	82402-44175C15	
APPROVED <i>[Signature]</i>	SIZE B	CODE IDENT NO. 16603
	SCALE 1/1	WT. — LB SHEET 1 OF 1

REV A

44175C15