

5

4

3

2

1

REVISIONS				
ZONE	LTR	DESCRIPTION	DATE	APPROVED
	A	NEW DRAWING	9/28/68	
	B	NOTE 2: STAMP WAS TAG-ADDED 079	1/24/69	
	C	2 WAS 2 5/8, 2 3/4 WAS 2.687	5-13-71	JW
	D	1.187 WAS 1.570	4-17-77	

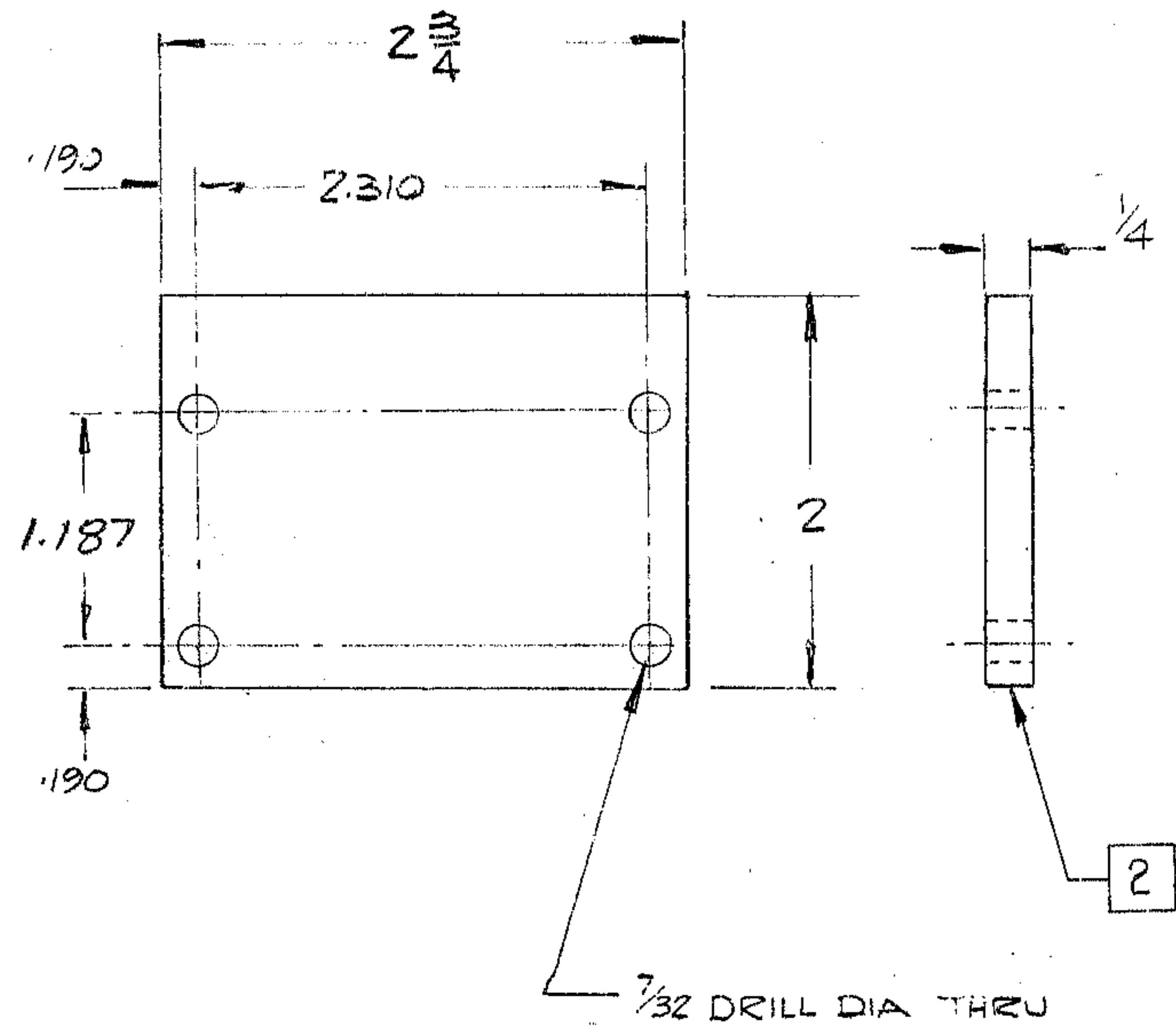

NOTES

1. ALL DIMENSIONS ARE IN INCHES.
2. STAMP PART NO 2150.289E.079
3. MATL STL C 1018.
FLAT BAR 1/4 x 2 x 2 3/4

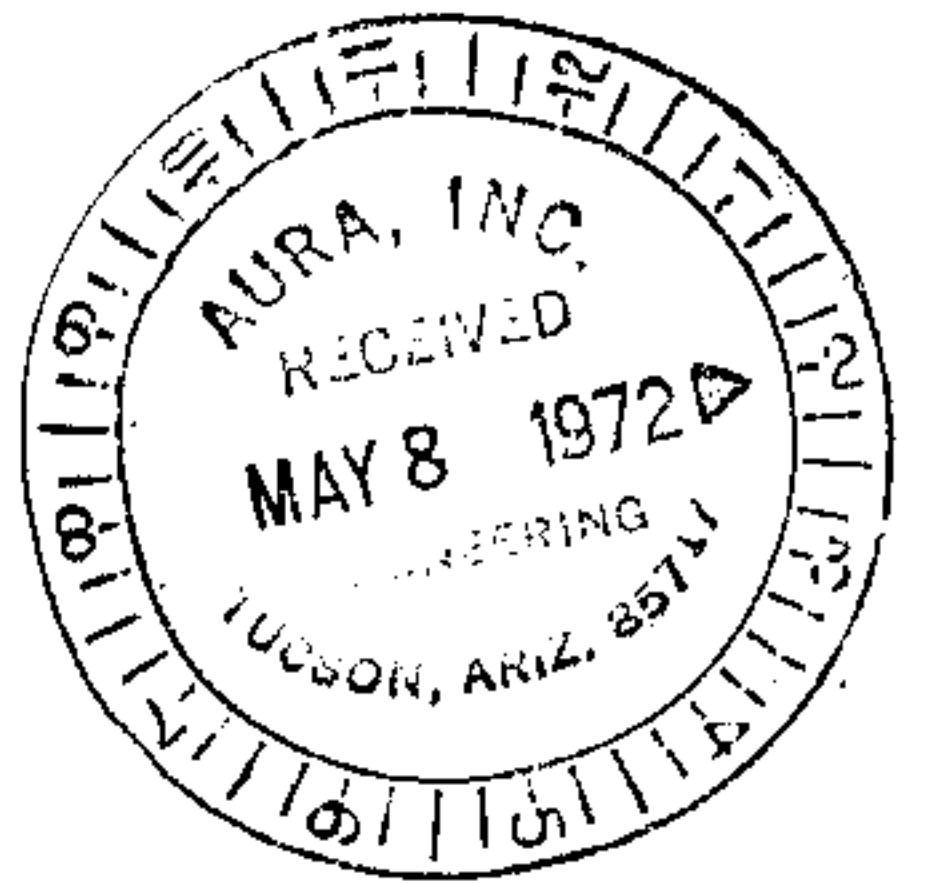

WESTERN GEAR CORPORATION
CONSTRUCTION PROJECTS
DEPARTMENT
APPROVED FOR
PROCUREMENT

GR. REF. FILE 1179

LIMITS ON
MACHINED DIMENSIONS
EXCEPT AS NOTED
ANGULAR ± 1° 0'
LINEAR
.X = ± .1
.XX = ± .03
.XXX = ± .010
FRACTIONAL ± 1/32

BREAK ALL
SHARP EDGES

150" STELLAR
TELESCOPE MFG
DRAWN J. LINDSTER.
CHECK P. GREFE
ENGR
W.G. C112681
APPROVED

Western GEAR CORPORATION		HEAVY MACHINERY DIVISION EVERETT, WASHINGTON	
LIMIT SWITCH MOUNTING PLATE (DEC AXIS C/WEIGHT)			
SIZE B	CODE IDENT NO. 16603	2150.289B079	REV D
SCALE 1/1	WT.	LB	SHEET 1 OF 1