

5

4

3

2

1

REVISIONS				
ZONE	LTR	DESCRIPTION	DATE	APPROVED
4C	A	.751 DIA WAS ^{.752} _{.750} ⁶³ / ADDED	11-2-68	
B3	A	.571 DIM WAS .554	"	
	A	REV PER AURA APPD PRINT	"	

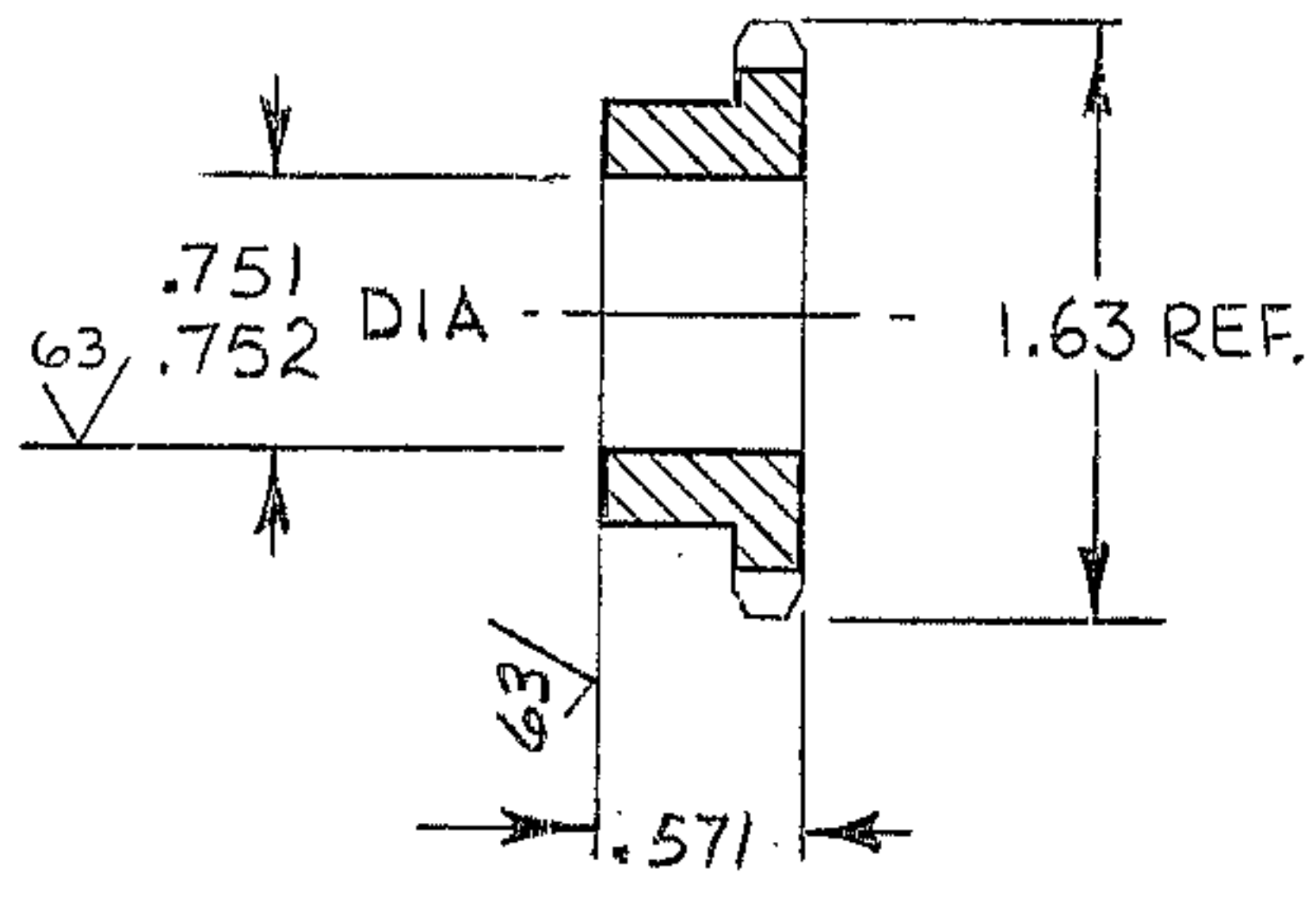
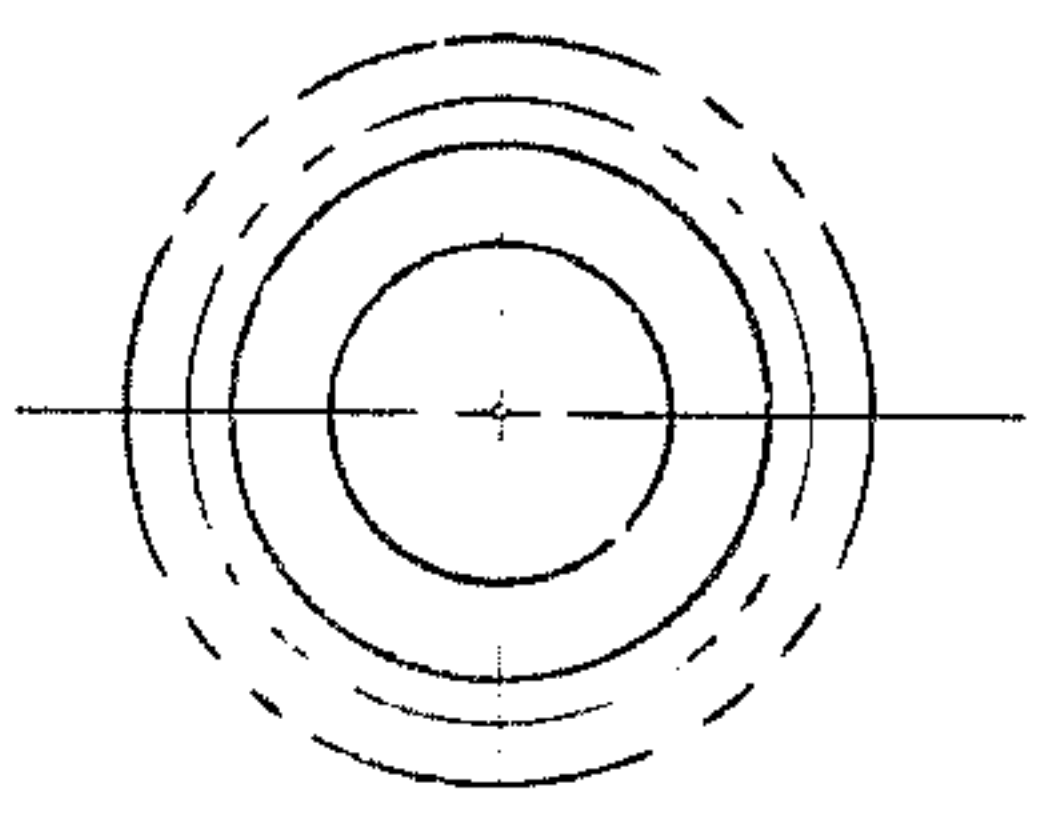

NOTES

1. ALL DIMENSIONS ARE IN INCHES.
2. SPROCKET TO BE MODIFICATION OF DIAMOND CHAIN SPROCKET PT.NO. 35B12.
3. TAG PART WITH PT.NO. 2150.283B509

WESTERN GEAR CORPORATION
 CONSTRUCTION PROJECTS
 DEPARTMENT
 APPROVED FOR
 PROCUREMENT

DATE 4/68

NEXT ASS'Y 2150.283E502(WGN102974)

REF. FILE 1176

LIMITS ON MACHINED DIMENSIONS EXCEPT AS NOTED ANGULAR ± 1° 0' LINEAR .X = ± .1 .XX = ± .03 .XXX = ± .010 FRACTIONAL ± 1/32 BREAK ALL SHARP EDGES	150 IN STELLAR TELESCOPE MOUNTING	Western GEAR CORPORATION HEAVY MACHINERY DIVISION EVERETT, WASHINGTON	
	DRAWN COSTA	SPROCKET (MOD) CENTRAL DUST COVER COUDE #3	
CHECK <i>E. V. Nicolay</i> ENGR	WGC112420	SIZE B	CODE IDENT NO. 16603
APPROVED		2150.283B509	REV A
	SCALE $\frac{1}{1}$	WT.	LB SHEET OF