

5

4

3

2

1

REVISIONS

ZONE	LTR	DESCRIPTION	DATE	APPROVED
	A	REV PER AURA. APP PRINT	10/29/68	
C5	A	2 <sup>9</sup> / <sub>32</sub> WAS 2 <sup>5</sup> / <sub>32</sub>		
B2	A	2 <sup>3</sup> / <sub>8</sub> WAS 2 <sup>3</sup> / <sub>16</sub>		

3/32 DIADRILL THRU 2 PLACES

1/32 X 45° 2 PLACES

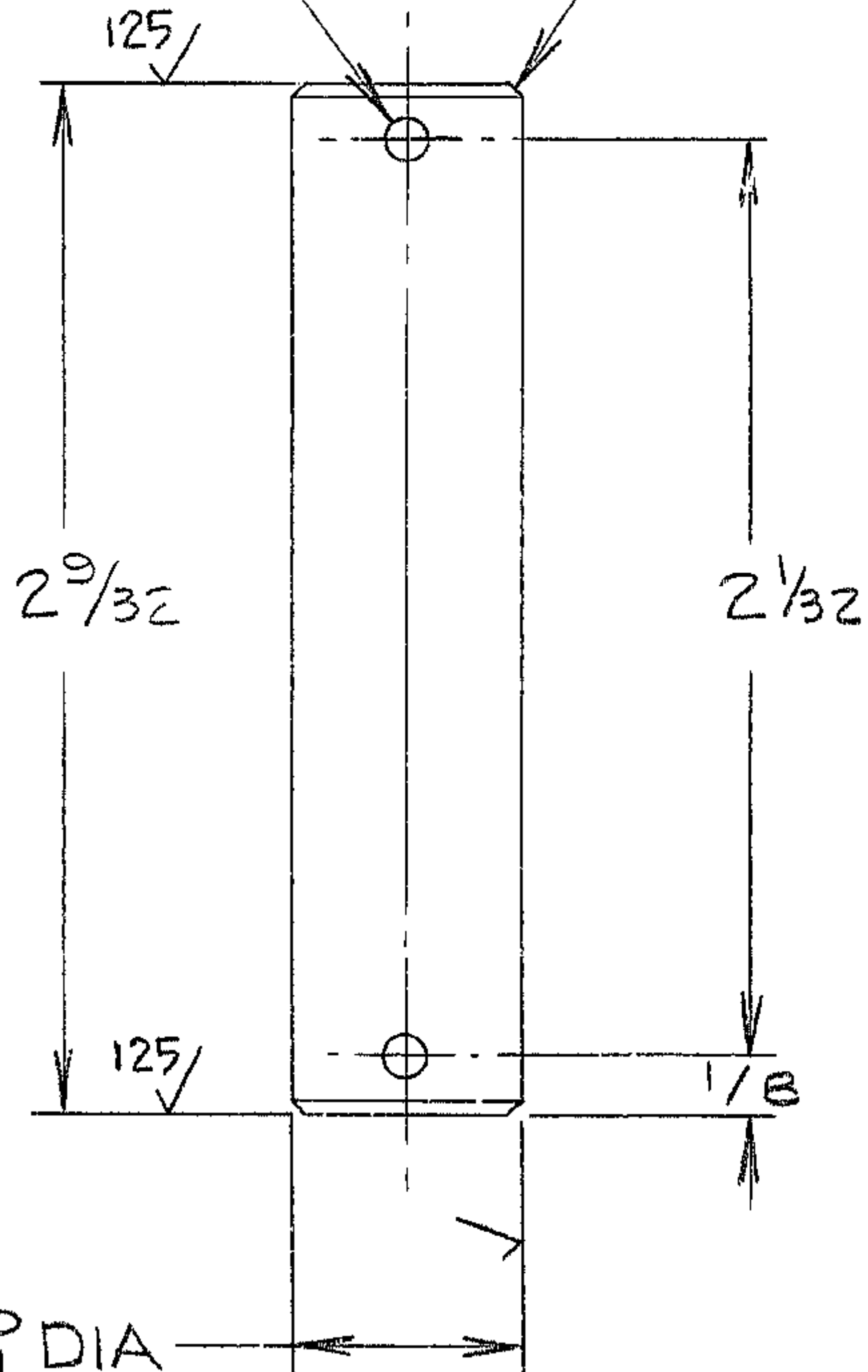

.500<sup>+0.000</sup>/<sub>-.001</sub> DIA STK

WESTERN GEAR CORPORATION  
 COUDES PROJECTS  
 FOR  
 MEASUREMENT  
 P.G. DATE 11/22/68

NOTES:

1. ALL DIMENSIONS ARE IN INCHES
2. ALL SURFACES MARKED ✓ TO BE 6<sup>3</sup>/<sub>16</sub> EXCEPT AS NOTED
3. MATERIAL: STL PRECISION SHAFTING AISI C-1045 .500<sup>+0.000</sup>/<sub>-.001</sub> DIA X 2<sup>3</sup>/<sub>8</sub> LG. OR EQ.
4. TAG WITH PART NO. 2150.283B405

REF. FILE 1176

NEXT ASSY 2150.283C402 (W.G.D 107,441)

LIMITS ON MACHINED DIMENSIONS EXCEPT AS NOTED ANGULAR ± 1° 0' LINEAR .X = ± .1 .XX = ± .03 .XXX = ± .010 FRACTIONAL ± 1/32 BREAK ALL SHARP EDGES	150 IN STELLAR TELESCOPE MTG		<b>Western GEAR CORPORATION</b> HEAVY MACHINERY DIVISION EVERETT, WASHINGTON	
	DRAWN BIRKENDAH 3/20/68 CHECK [Signature] 5-18-68 ENGR		SHAFT, PIVOT COUDE #3 ASSY	
	W.G.C 112,449		SIZE B CODE IDENT NO. 16603 2150.283B405	REV A
	APPROVED	SCALE 2/1	WT. .2 LB	SHEET 1 OF 1