

5

4

3

2

1

REVISIONS				
ZONE	LTR	DESCRIPTION	DATE	APPROVED
	A	REVISED PER AURA APPD. PRINTS & GENERAL REVISIONS	11/3/68	

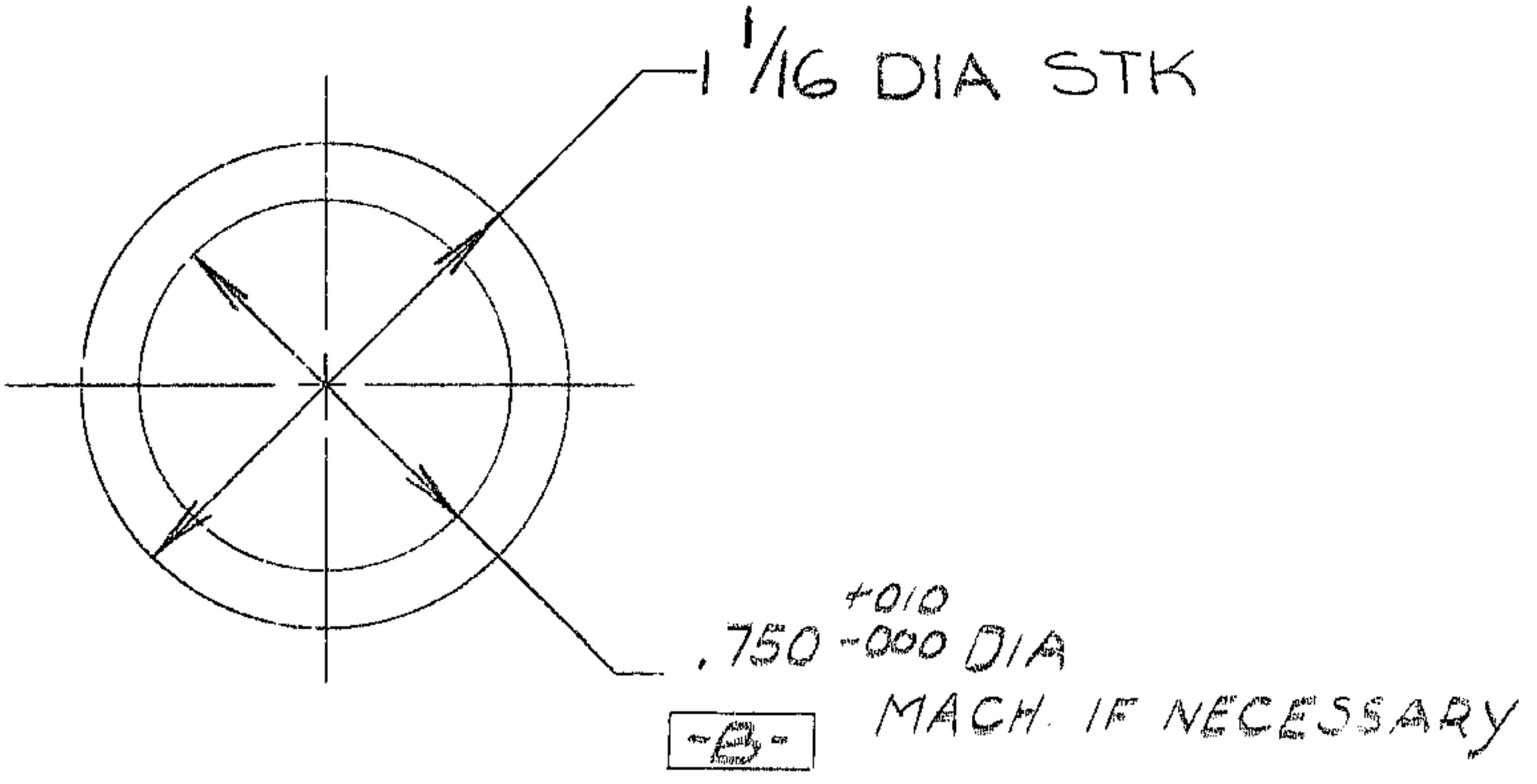

- NOTES:
1. ALL DIMENSIONS IN INCHES
 2. ALL SURFACES TO BE 125° EXCEPT AS NOTED
 3. MATERIAL: TUBE 1/16 O.D. X 3/4 I.D. X 7/8 LG
STL AISI-MT-1015
 4. STAMP WITH PART NO. 2150.283B306

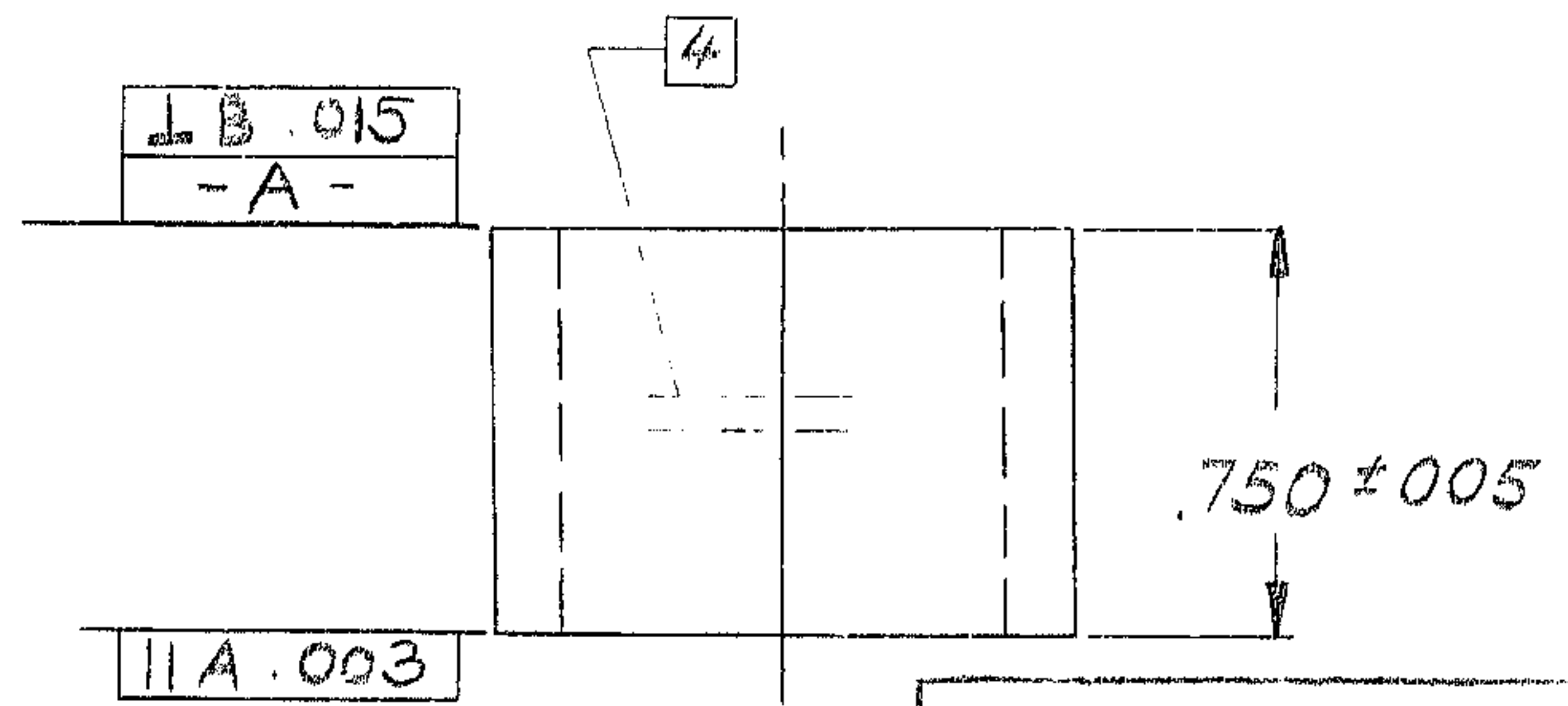

REF. FILE 1176

WESTERN GEAR CORPORATION
CONSTRUCTION PROJECTS
DEPARTMENT

APPROVED FOR
PROCUREMENT

P.G. DATE 11-29-68

NEXT ASSY 2150.283 D302 (W.G.E 107,675)

LIMITS ON MACHINED DIMENSIONS EXCEPT AS NOTED ANGULAR $\pm 1^\circ 0'$ LINEAR .X = $\pm .1$.XX = $\pm .03$.XXX = $\pm .010$ FRACTIONAL $\pm 1/32$ BREAK ALL SHARP EDGES	150IN STELLAR TELESCOPE MOUNTING	Western GEAR CORPORATION HEAVY MACHINERY DIVISION EVERETT, WASHINGTON		
	DRAWN BIRKENDAH 3/9/8 CHECK <i>Ch/10</i> 52868 ENGR	SPACER, BEARING - ROTATION DRIVE CODE #3 ASSY		
W.G.C 112,447	SIZE B	CODE IDENT NO. 16603	2150.283B306	REV A
APPROVED	SCALE <u>2/1</u>	WT.	LB SHEET	OF