

THIS DOCUMENT CONTAINS INFORMATION PROPRIETARY TO WESTERN GEAR CORPORATION. ALL DESIGN, MANUFACTURING, REPRODUCTION, USE, PATENT AND SALES RIGHTS REGARDING THE SAME ARE HEREBY EXPRESSLY RESERVED BY WESTERN GEAR CORPORATION. THIS DOCUMENT IS SUBMITTED FOR REFERENCE PURPOSES ONLY AND SHALL NOT BE DISCLOSED TO ANY UNAUTHORIZED PERSON OR INCORPORATED INTO ANY OTHER PROJECT.

REVISIONS				
ZONE	LTR	DESCRIPTION	DATE	APPROVED
	B	REVISED & REDRAWN PER KPNO2120E46	5-20-69	
	C	RELEASED PER ADRA APPD PRINT	7-27-69	
B-1	D	6.62/6.47 DIA WAS $6\frac{5}{8}$	2-4-71	JW

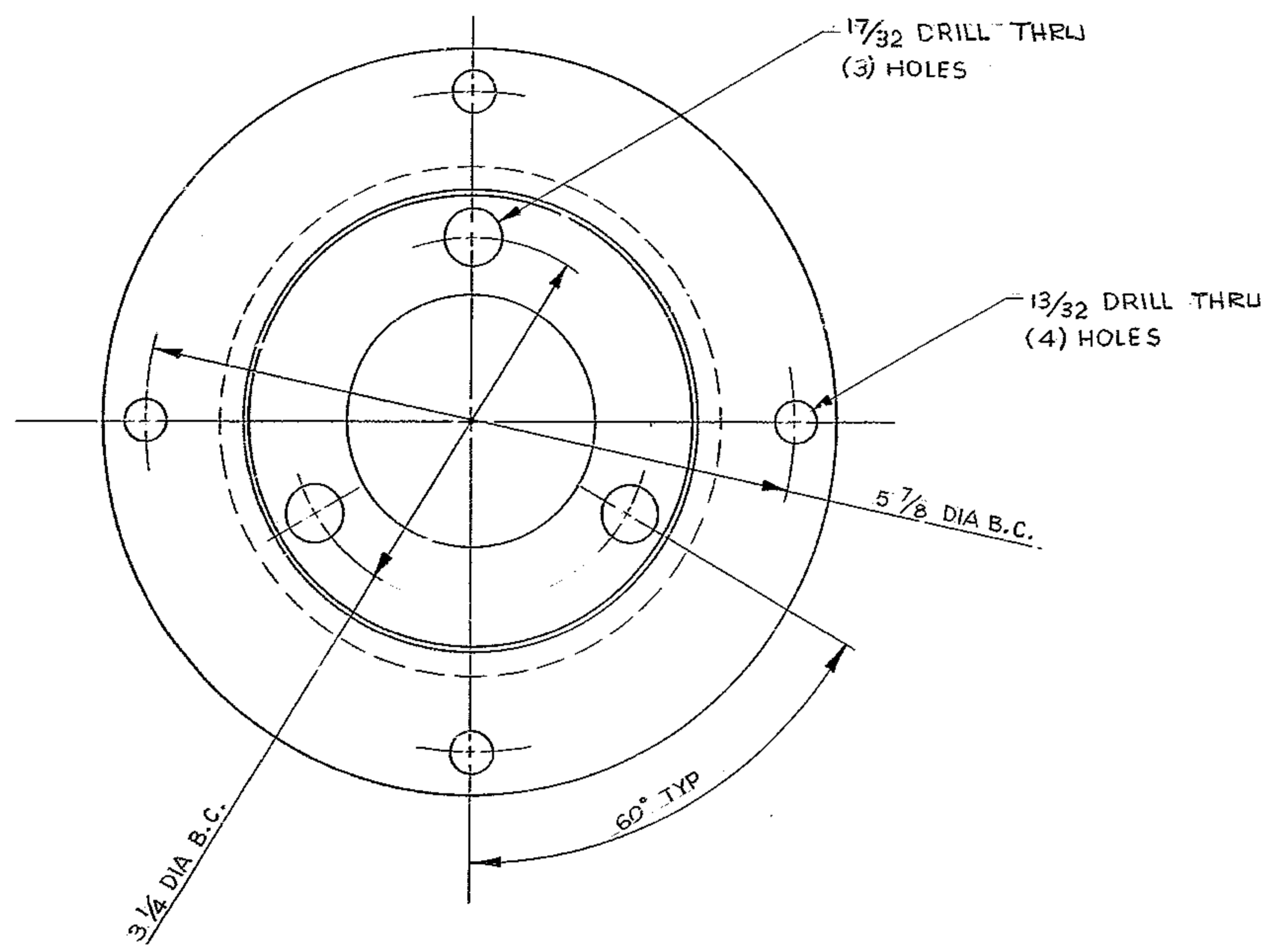

NOTES:
 1. ALL MACHINED SURFACES TO BE $\sqrt{125}$ UNLESS OTHERWISE SPECIFIED
 2. TAG WITH P/N 2150.281D086

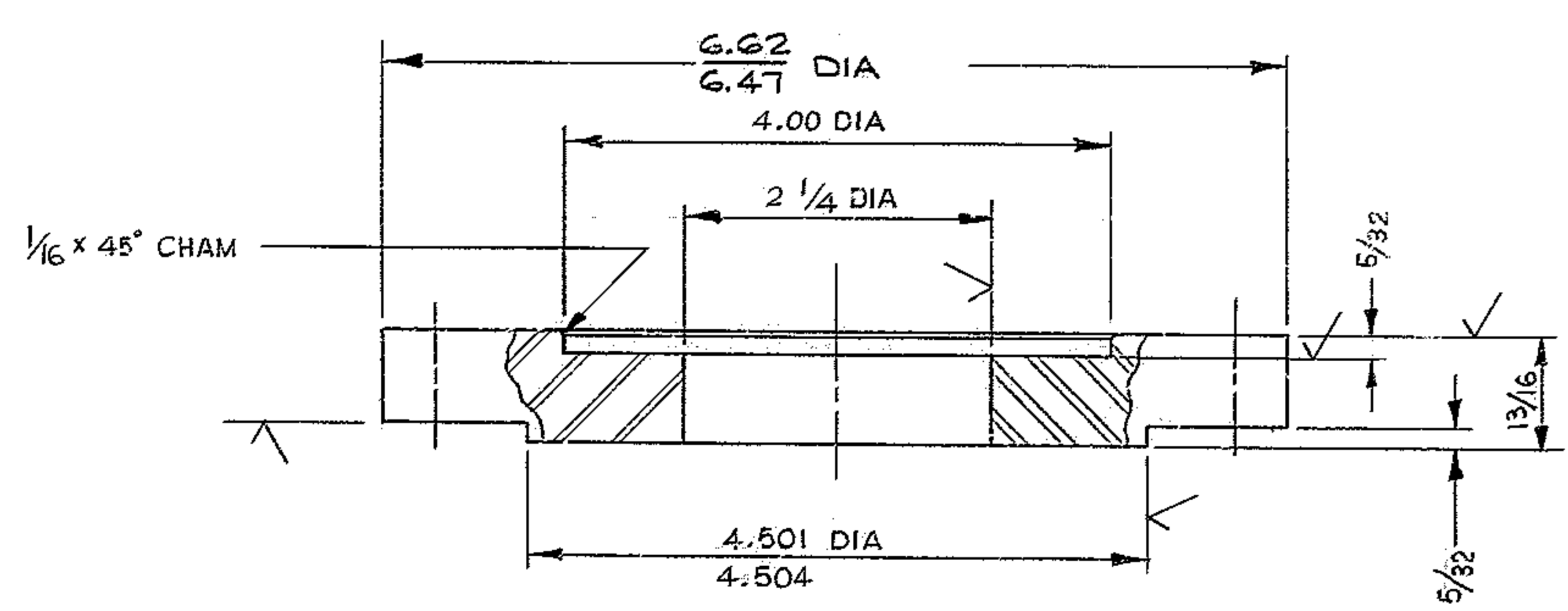

1120

NEXT ASSY: 2150.281E002 (WGN 103002)

WESTERN GEAR CORPORATION
 CONSTRUCTION PROJECTS
 DEPARTMENT
 APPROVED FOR
 PROCUREMENT
 GR DATE 10/17/69

FIND NO.	PART NO.	DESCRIPTION	QTY	MATERIAL	CODE IDENT
LIST OF MATERIAL (LM)					
LIMITS ON MACHINED DIMENSIONS EXCEPT AS NOTED ANGULAR = ± 1°		150 IN. STELLAR TELESCOPE MTG		WESTERN GEAR CORPORATION HEAVY MACHINERY DIVISION EVERETT, WASHINGTON	
LINEAR: X = ± .1 .XXX = ± .010 XX = ± .03 FRACTIONAL = ± 1/32		DRAWN: STOUTENBURGH 5-20-69 CHECK: <i>cm</i> 23 May 70		ADAPTER, MOTOR	
BREAK ALL SHARP EDGES		ENGR			
MATERIAL		STL. AISI C1018 P. 6 5/8 ø x 1"		SIZE	CODE IDENT NO.
		WGE 107841		D	16603 2150.281D086
		APPROVED:		SCALE	FULL WT B LB SHEET 1 OF 1