

4

3

2

1

REVISIONS				
ZONE	LTR	DESCRIPTION	DATE	APPROVED
B4	A	3.375 WAS 3.437	10-22-68	
B4	A	ADDED 1/2 x 2" HOLE	"	
	A	APP'D. FOR CONST. PER AURA PRINT	"	
B4	B	1/2 WAS 3/4, 2 1/4 WAS 2, 10° SLANT ADDED	5-28-71	JW
	C	ADDED ±.050 .025 WAS .010	7-20-72	LDS

D

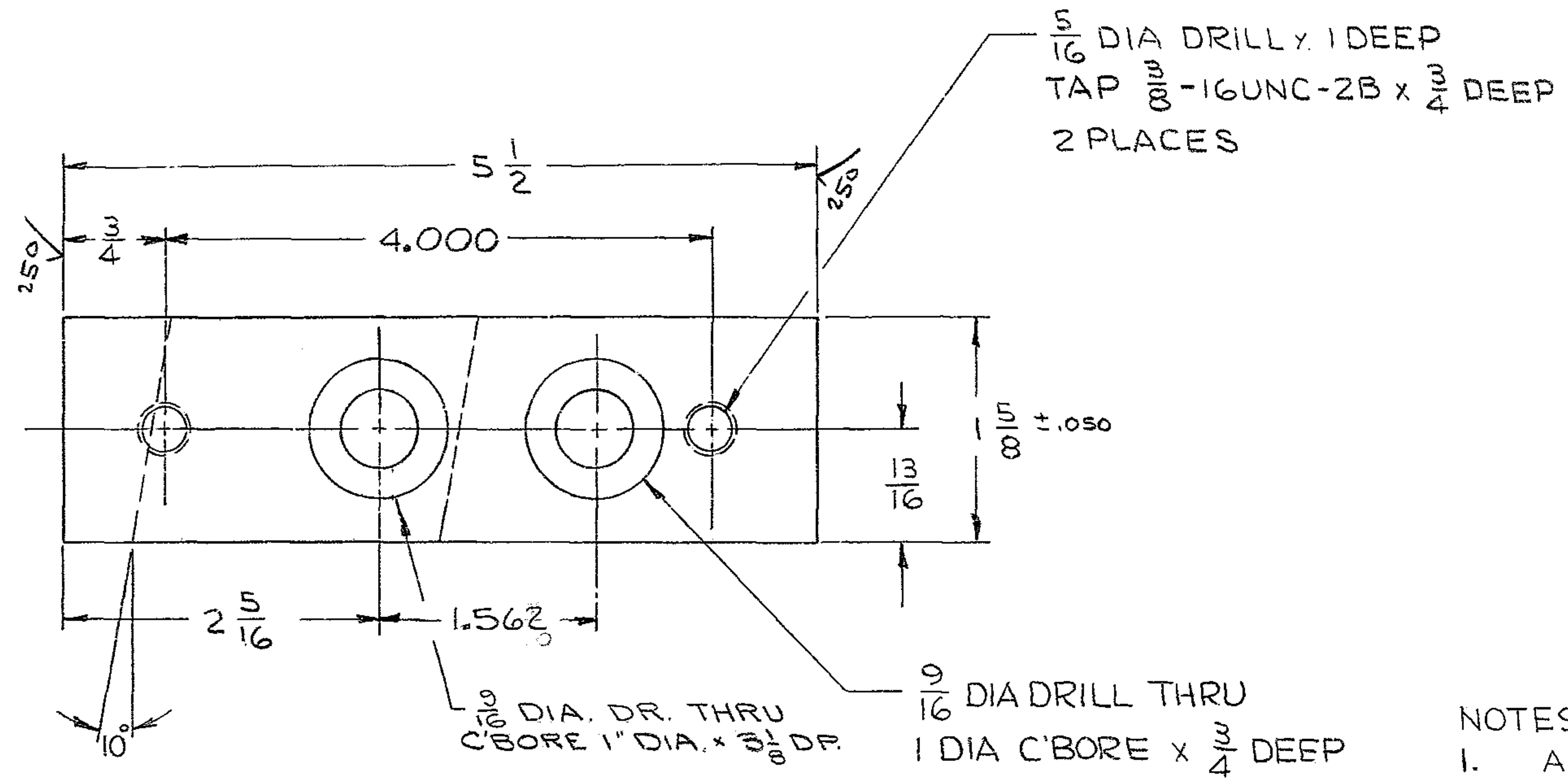

C

- NOTES:
1. ALL DIMENSION ARE IN INCHES.
 2. STAMP PART NO. 2150.281C044 APPROX WHERE SHOWN.
 3. SURFACE MARKED ✓ TO BE 125 ✓ EXCEPT AS NOTED.
 4. APPLY ONE (1) COAT PRIME PAINT ALL OVER BEFORE MACHINING PER W.G.C. SPEC 511.

B

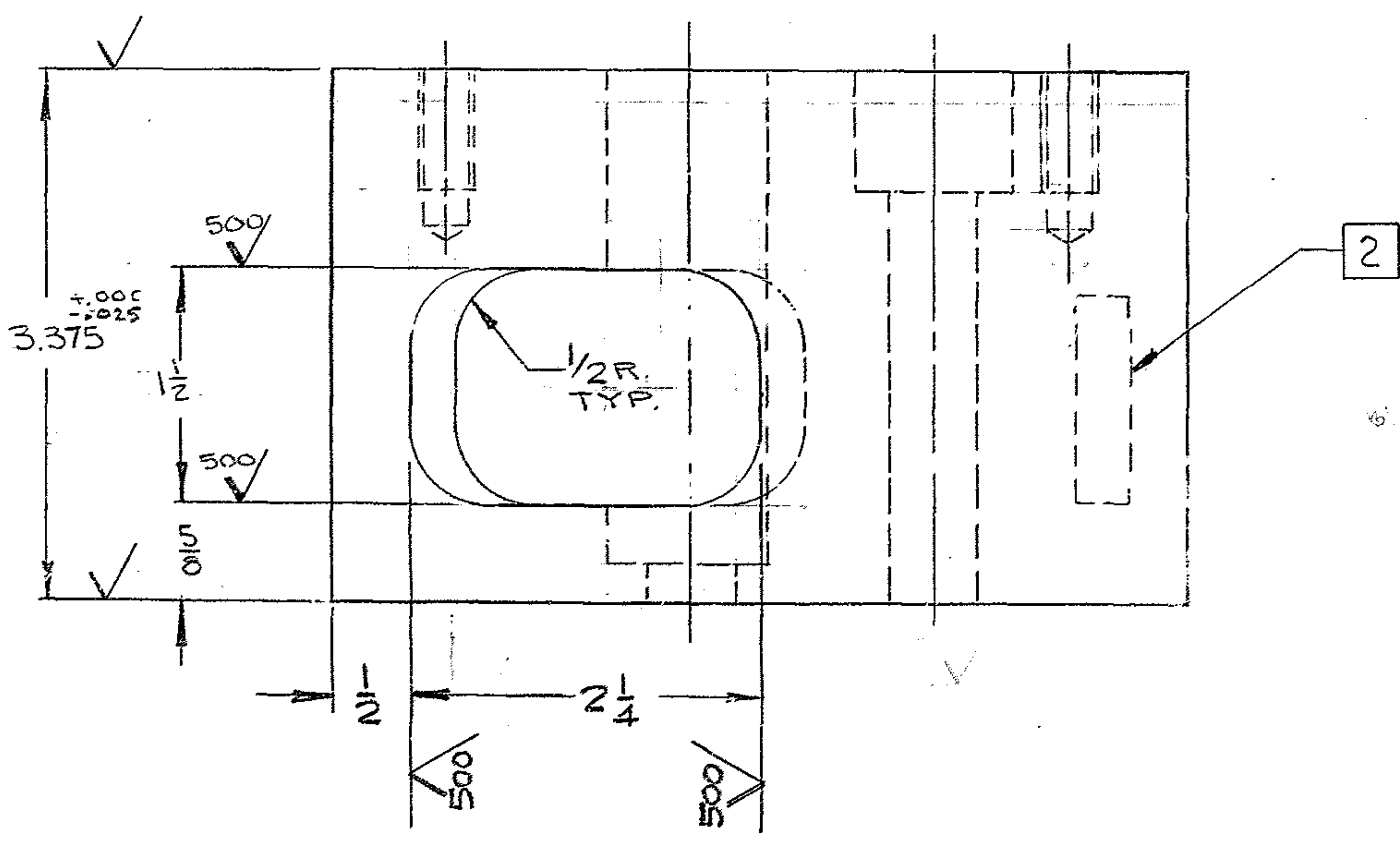

A

NEXT ASSY: 2150.281E002 (W.G.N103002)

REF. FILE 1175

FIND NO.	PART NO.	DESCRIPTION	QTY	MATERIAL	CODE IDENT
LIST OF MATERIAL (LM)					
LIMITS ON MACHINED DIMENSIONS EXCEPT AS NOTED ANGULAR = ± 1° 0' LINEAR: X = ± .1 .XXX = ± .010 .XX = ± .03 FRACTIONAL = ± 1/32		150 ^{IN} STELLAR TELESCOPE MOUNTING		WESTERN GEAR CORPORATION HEAVY MACHINERY DIVISION EVERETT, WASHINGTON	
BREAK ALL SHARP EDGES		DRAWN R. Strong	5-22-68	SPACER, PILLOW BLOCK	
MATERIAL		CHECK F.W.K.	8-15-68	IRIS COVER	
PL 3 1/2 x 1 5/8 x 1/8 STLASTM-A7 (OR EQUAL)		ENGR		SIZE	CODE IDENT NO.
		APPROVED		C 16603	2150.281C044
				REV	C
				SCALE 1/1	WT LB SHEET 1 OF 1

D

C

B

A