

REVISIONS				
ZONE	LTR	DESCRIPTION	DATE	APPROVED
	A	APPROVED FOR CONST. PER AURA	9-20-68	11-4-68

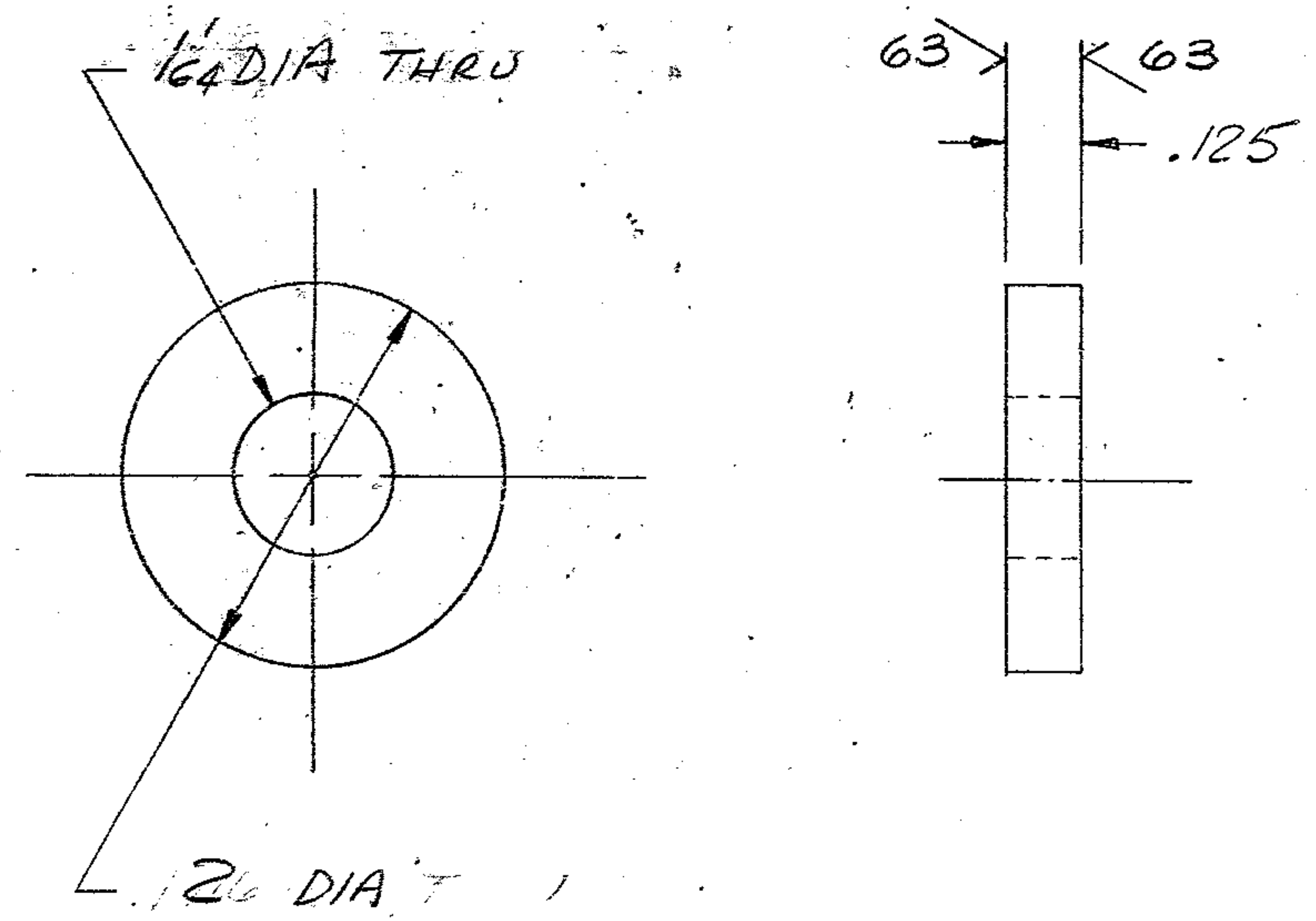

NOTES:
 1. ALL DIMENSIONS ARE IN INCHES
 2. TAG WITH PART NO. 2150.281C024

REF. FILE. 1175

NEXT ASSY: 2150.281E002 (W.G.N 103002)

FIND NO.	PART NO.	DESCRIPTION	QTY	MATERIAL	CODE IDENT
LIST OF MATERIAL (LM)					
LIMITS ON MACHINED DIMENSIONS EXCEPT AS NOTED ANGULAR = ± 1° 0'		750 IN. STELLAR TELESCOPE MTG		WESTERN GEAR CORPORATION HEAVY MACHINERY DIVISION EVERETT, WASHINGTON	
LINEAR: X = ± .1 .XXX = ± .010 .XX = ± .03 FRACTIONAL = ± 1/32		DRAWN <i>F. Hubler</i> 8-21-68 CHECK <i>WJ</i> ENGR			
BREAK ALL SHARP EDGES		MATERIAL AL 2" DIA X 3/16		SIZE	CODE IDENT NO.
		STL AISI C1018		C 16603	2150.281C024
		APPROVED		SCALE NONE	WT
		ORIGINAL		LB	SHEET 1 OF 1

WESTERN GEAR CORPORATION
 CONSTRUCTION PROJECTS
 DEPARTMENT
 APPROVED FOR
 PROCUREMENT
 D.G. DATE 11/21/68