

4

3

2

1

REVISIONS				
ZONE	LTR	DESCRIPTION	DATE	APPROVED
	A	APPR PER AURA CONSTRUCTION PRINT	20/9/68	10/23/68
DB	B	.500 DIM. WAS .375		6/24/70

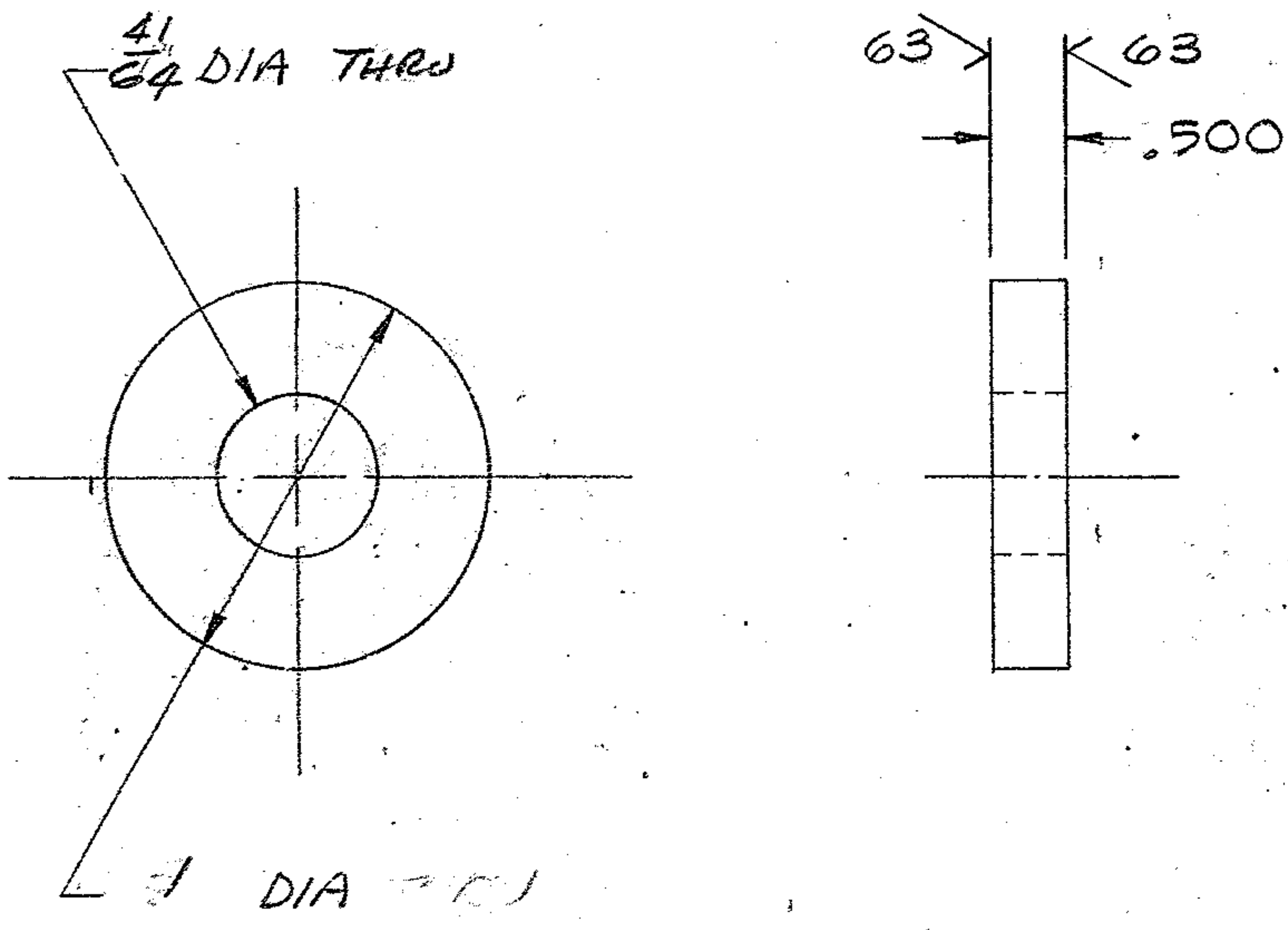

NOTES:
 1. ALL DIMENSIONS ARE IN INCHES
 2. TAG WITH PART NO. 2150.281C023

REF. FILE 1175

NEXT ASSY: 2150.281E002 (W.G.N 103002)

WESTERN GEAR CORPORATION
 COMPANY PROJECTS
 DRAWN FOR
 PROCUREMENT
 P.G. DATE 11/21/68

FIND NO.	PART NO.	DESCRIPTION	QTY	MATERIAL	CODE IDENT
LIST OF MATERIAL (LM)					
LIMITS ON MACHINED DIMENSIONS EXCEPT AS NOTED ANGULAR = ± 1° 0'		150 IN. STELLAR TELESCOPE MTG		Western GEAR CORPORATION HEAVY MACHINERY DIVISION EVERETT, WASHINGTON	
LINEAR: .X = ± .1 .XXX = ± .010 .XX = ± .03 FRACTIONAL = ± 1/32		DRAWN <i>F. McBlair</i> 8-21-68 CHECK <i>C. J. W.</i> 8-21-68		SPACER, SPROCKET CENTER SECTION	
BREAK ALL SHARP EDGES		ENGR			
MATERIAL 1 1/2 DIA x 7/16 STL AISI C101B		W.G. D 107629		SIZE C 16603	CODE IDENT NO. 2150.281C023
APPROVED		ORIGINAL		REV B	
				SCALE NONE	WT LB SHEET / OF /