

4

3

2

1

REVISIONS			
ZONE	LTR	DESCRIPTION	DATE
	A	APP'D FOR CONST. PER AURA 9-20-68	11-4-68

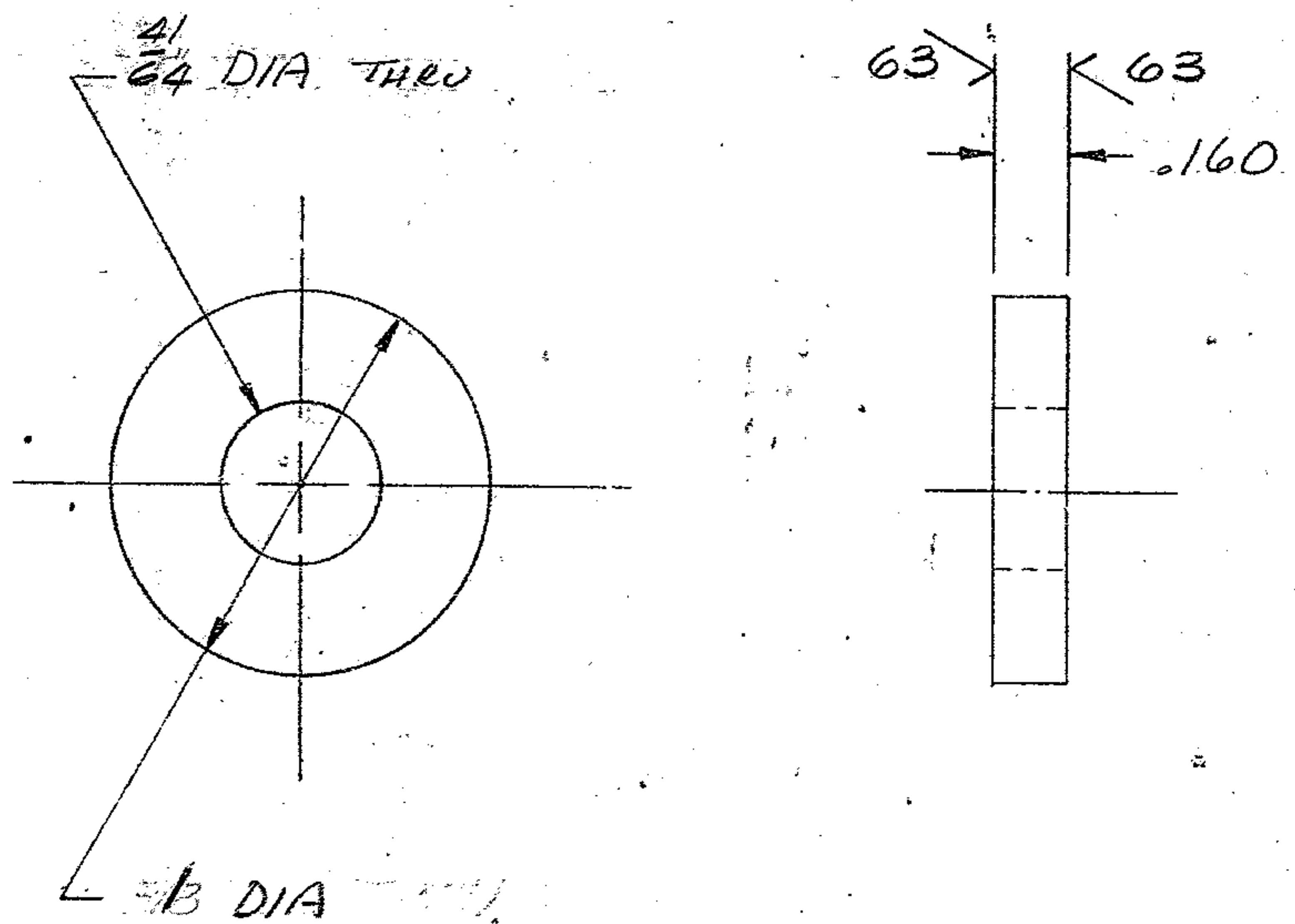

NOTES.
 1. ALL DIMENSIONS ARE IN INCHES
 2. TAG WITH PART NO. 2150.281C022

REF. FILE 1175

NEXT ASSY: 2150.281E002 (W.G.N 103002)

WESTERN GEAR CORPORATION
 APPROVED FOR
 PROCUREMENT
 DATE 11/21/68

FIND NO.	PART NO.	DESCRIPTION	QTY	MATERIAL	CODE IDENT
LIST OF MATERIAL (LM)					
LIMITS ON MACHINED DIMENSIONS EXCEPT AS NOTED ANGULAR = ± 1° 0'		150 IN. STELLAR TELESCOPE MTG		WESTERN GEAR CORPORATION HEAVY MACHINERY DIVISION EVERETT, WASHINGTON	
LINEAR: X = ± .1 .XXX = ± .010 .XX = ± .03 FRACTIONAL = ± 1/32		DRAWN <i>F. Huber</i> 8-21-68 CHECK <i>J.W.</i> ENGR		SPACER, SPROCKET, CENTER SECTION	
BREAK ALL SHARP EDGES		MATERIAL 1 1/2" DIA X 3/16		W.G.D 107628	
		STL A151 C101B		APPROVED ORIGINAL	
		SCALE NONE		WT	LB SHEET / OF /
		SIZE	CODE IDENT NO.	REV	
		C 16603	2150.281C022	A	