

4

3

2

1

REVISIONS				
ZONE	LTR	DESCRIPTION	DATE	APPROVED
	A	APPD. FOR CONST. PER AURA 9-20-68	11-4-68	

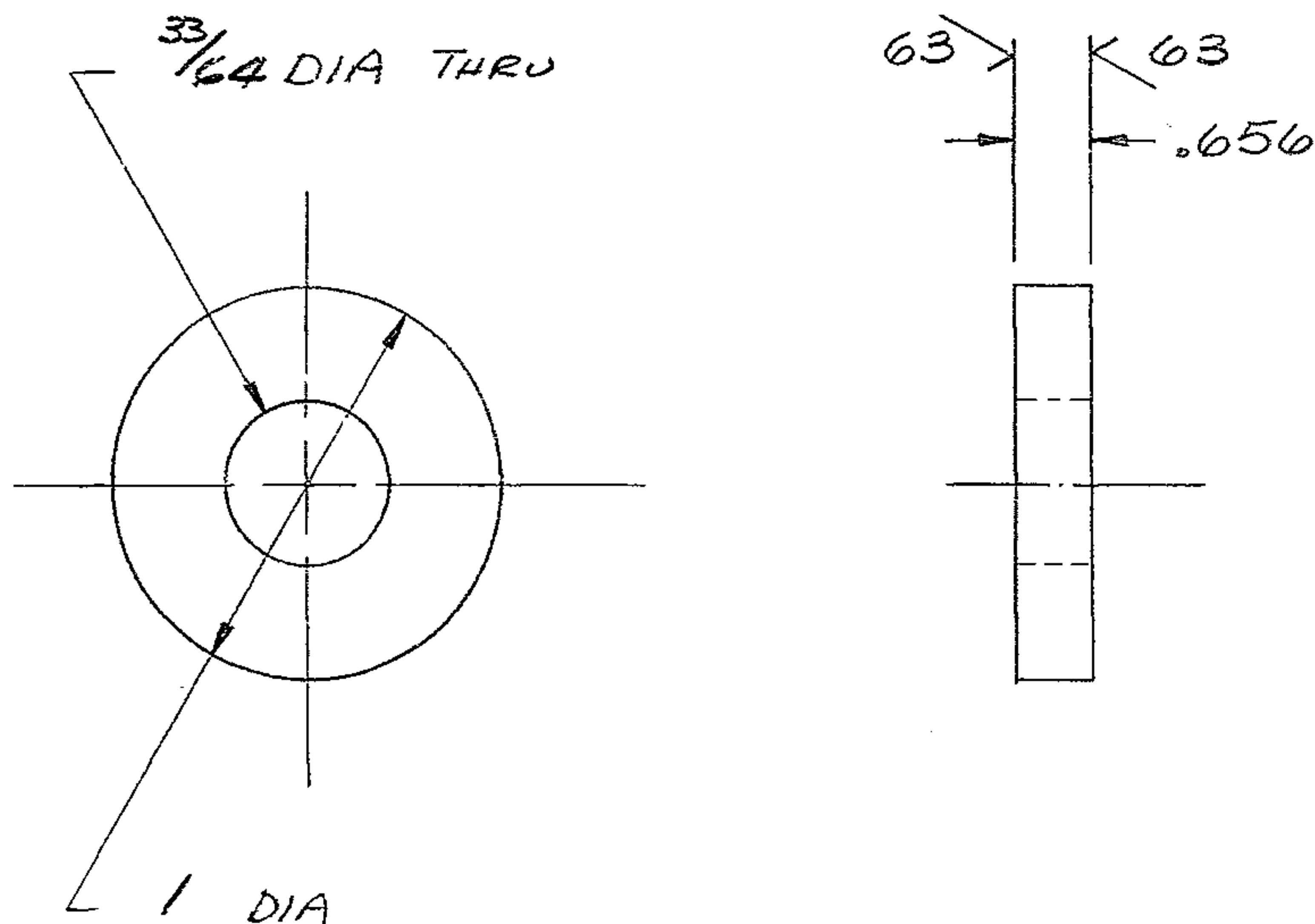

NOTES.
 1. ALL DIMENSIONS ARE IN INCHES
 2. TAG WITH PART NO. 2150.281C019

REF. FILE 1175

NEXT ASSY: 2150.281E002 (W.G.N 103002)

WESTERN GEAR CORPORATION
 CONSTRUCTION PROJECTS
 DEPARTMENT
 APPROVED FOR
 PROCUREMENT
 P.G. DATE 11/24/68

FIND NO.	PART NO.	DESCRIPTION	QTY	MATERIAL	CODE IDENT
LIST OF MATERIAL (LM)					
LIMITS ON MACHINED DIMENSIONS EXCEPT AS NOTED ANGULAR = ± 1° 0'		150 IN. STELLAR TELESCOPE MTG		HEAVY MACHINERY DIVISION EVERETT, WASHINGTON SPACER, HOUSING, CENTER SECTION	
LINEAR: .X = ± .1 .XXX = ± .010 .XX = ± .03 FRACTIONAL = ± 1/32		DRAWN <i>F. Huber</i> 8-21-68 CHECK <i>SWH.</i> ENGR			
BREAK ALL SHARP EDGES		MATERIAL		SIZE	CODE IDENT NO.
		ROD 1" DIA X 3/4 STL AISI C1018		C	16603
		APPROVED		SCALE NONE	WT
				2150.281C019	
				REV	A
				LB SHEET 1 OF 1	