

5

4

3

2

1

| REVISIONS | | | | |
|-----------|-----|---------------------|---------|----------|
| ZONE | LTR | DESCRIPTION | DATE | APPROVED |
| | A | RELEASED FOR CONST. | 11-5-68 | |
| | B | DIMEN. CHANGED | 4-17-70 | S. |

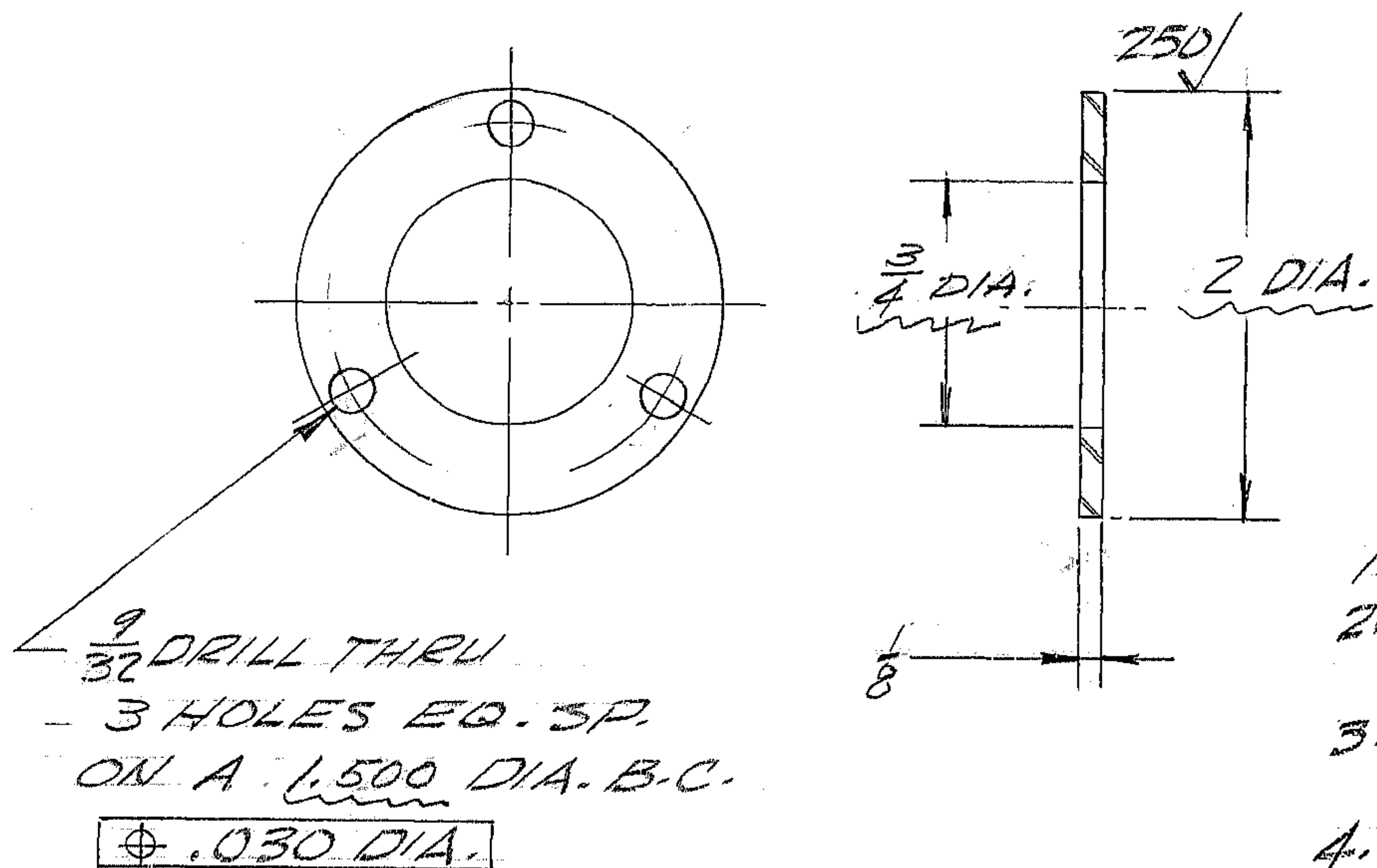

- NOTES:
1. ALL DIMENSIONS ARE IN INCHES
 2. MATL. STL A.I.S.I. C1018 OR EQUIV. 2 DIA. BAR x $\frac{3}{16}$
 3. FINISH 125 ALL OVER UNLESS NOTED.
 4. TAG WITH PART N° 2150.281B085

REF. FILE 1175

WESTERN GEAR CORPORATION
 CONSTRUCTION PROJECTS
 DEPARTMENT
 APPROVED FOR
 PROCUREMENT
 P.G. DATE 11/21/68

NEXT ASSY: 2150.281E002 (W.G. N103,002)

| | | |
|---|--------------------------------|---|
| LIMITS ON MACHINED DIMENSIONS EXCEPT AS NOTED ANGULAR ± 1° 0' LINEAR .X = ± .1 .XX = ± .03 .XXX = ± .010 FRACTIONAL ± 1/32 BREAK ALL SHARP EDGES | 150 IN. STELLAR TELESCOPE MTG. | HEAVY MACHINERY DIVISION EVERETT, WASHINGTON |
| | DRAWN R.N. 10/31/68 | |
| APPROVED | W.G. C112735 | SIZE B CODE IDENT NO. 16603 2150.281B085 REV B |
| | | SCALE NONE WT. LB SHEET 1 OF 1 |