

5

4

3

2

1

REVISIONS				
ZONE	LTR	DESCRIPTION	DATE	APPROVED
	A	APP'D FOR CONST. PER AURKA 9/29/64	11-5-64	

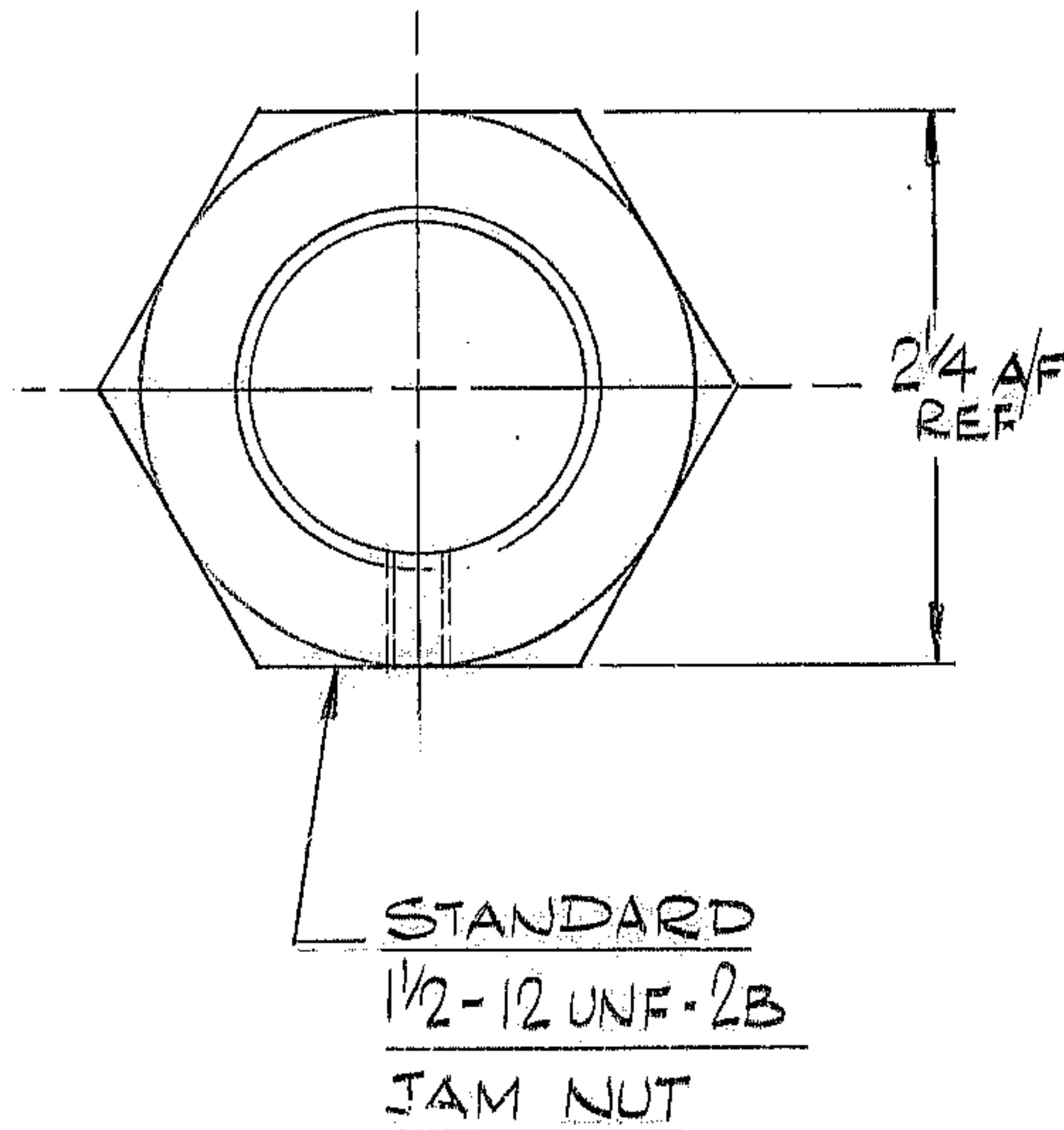
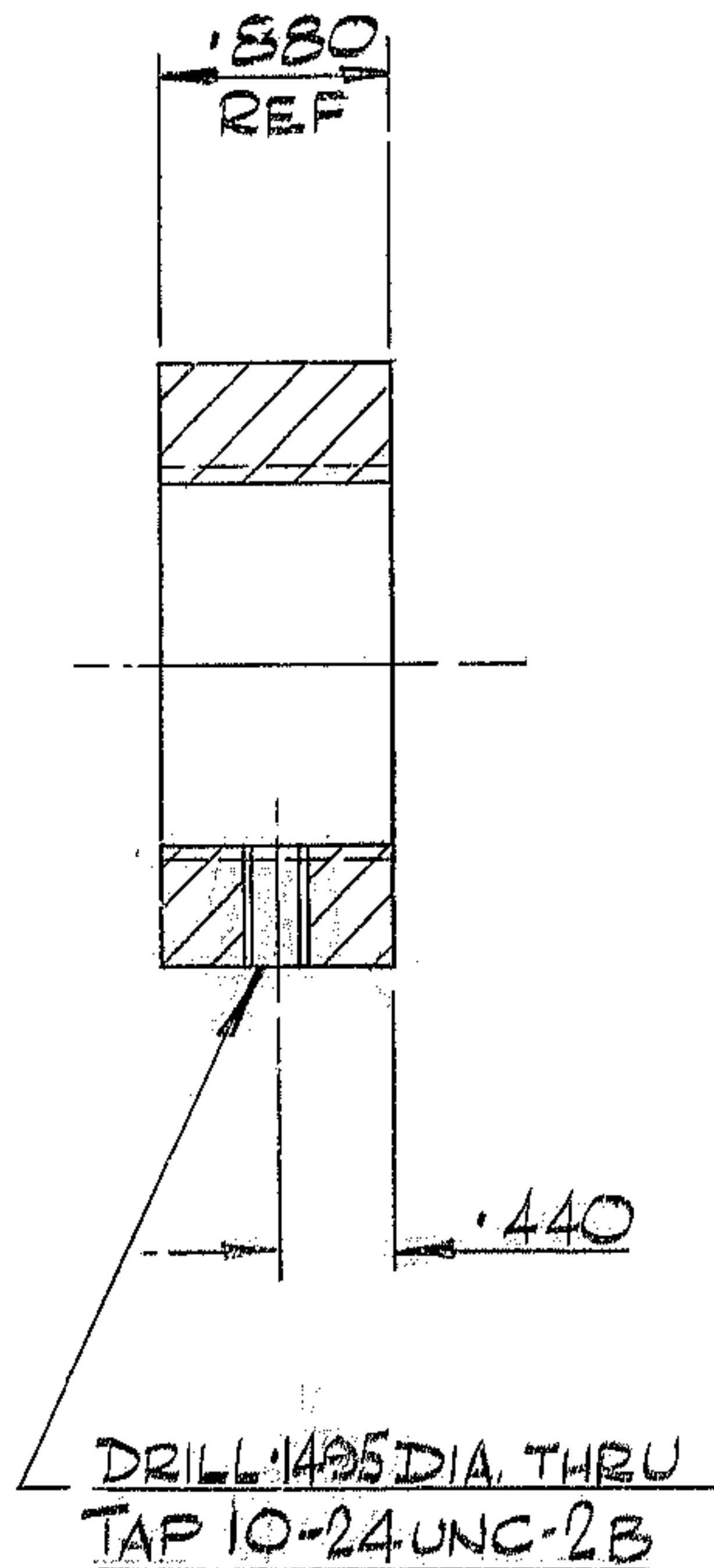

NOTES:

1. ALL DIMENSIONS IN INCHES
2. TAG WITH PART NO. 2150.281B036
3. MAT'L: STL. MAKE FROM STANDARD 1/2-12 UNF-2B NUT

REF. FILE 1175

WESTERN GEAR CORPORATION
CONSTRUCTION PROJECTS
DEPARTMENT
APPROVED FOR
PROCUREMENT

P.G. DATE 11/21/68

NEXT ASSY 2150.281.E002

WGN103002

LIMITS ON MACHINED DIMENSIONS EXCEPT AS NOTED ANGULAR ± 1° 0' LINEAR .X = ± .1 .XX = ± .03 .XXX = ± .010 FRACTIONAL ± 1/32	150 IN STELLAR TELESCOPE MOUNTING		Western GEAR CORPORATION HEAVY MACHINERY DIVISION EVERETT, WASHINGTON	
	DRAWN MAUNDER 5/30/68	CHECK F.W. 8/15/68	JAM NUT, SPECIAL DUST COVER & IRIS ASSY, PRIMARY MIRROR	
ENGR	WGC 112624	SIZE B	CODE IDENT NO. 16603	REV A
BREAK ALL SHARP EDGES	APPROVED	SCALE 1" = 1/2" IN	WT. 1 LB	SHEET 1 OF 1