

5

4

3

2

1

REVISIONS				
ZONE	LTR	DESCRIPTION	DATE	APPROVED
2B	A	NOTE 3 ADDED.	10/21/68	
1B	A	1 ⁹ / ₁₆ ADDED TO MAT. NOTE		

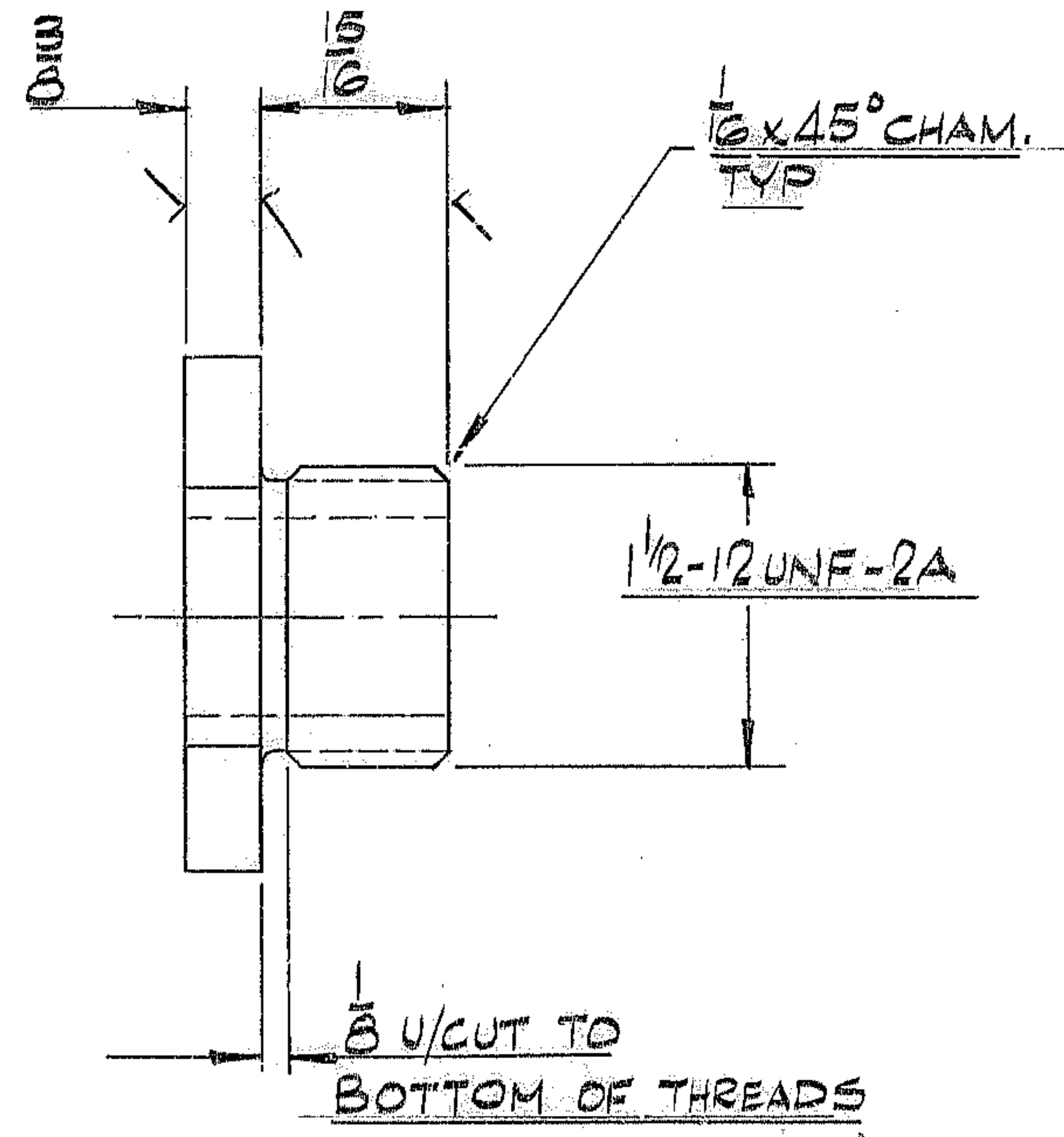
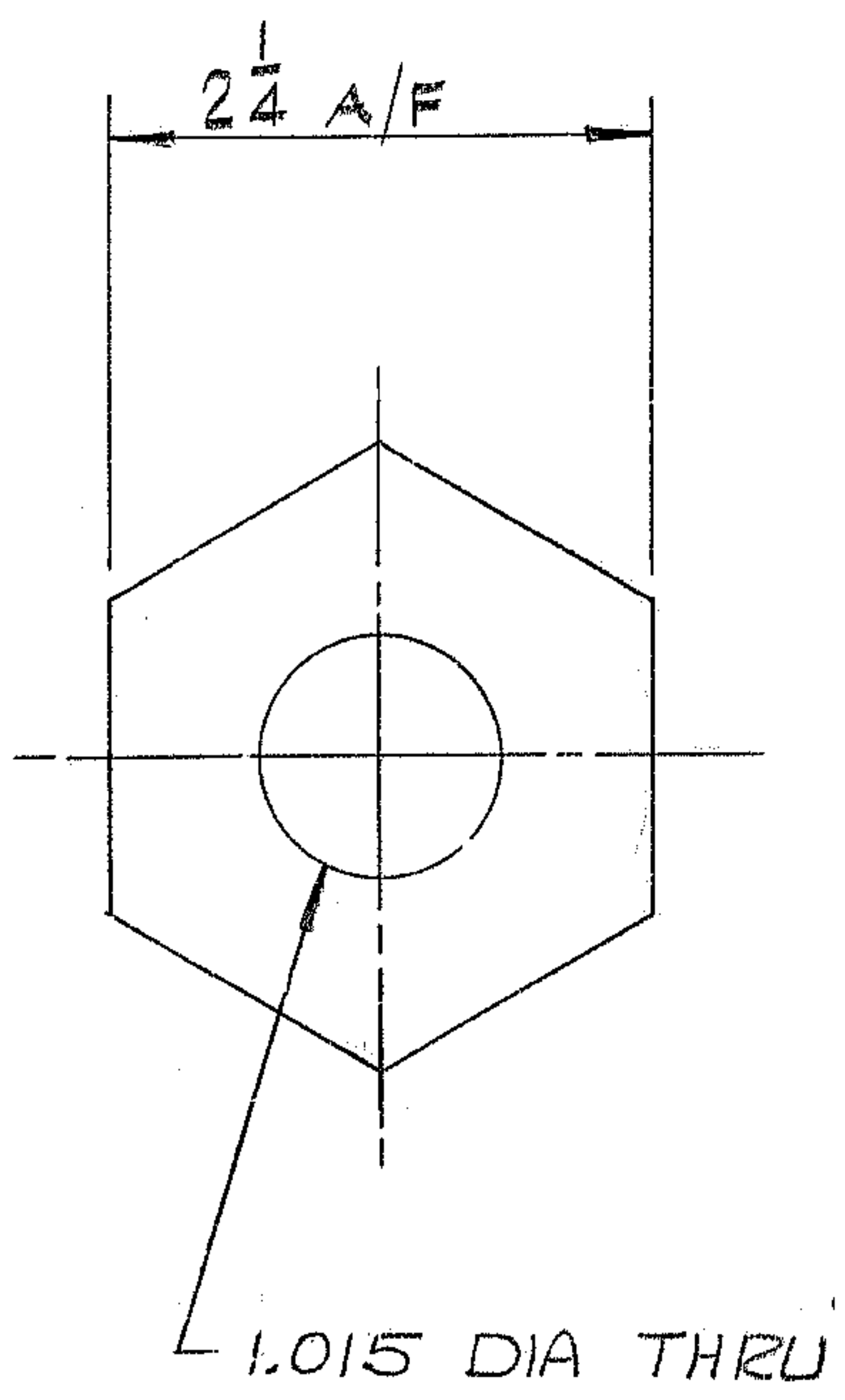

- NOTES:
- ALL DIMENSIONS IN INCHES
 - TAG WITH PART NO. 2150.281B035
 MAT. - STL. HEX. BAR 2 1/4 A/F. x 1⁹/₁₆ LG
AISI C1018
 - SURFACES MARKED ✓ TO BE ¹²⁵ ✓

REF. FILE 1175

WESTERN GEAR CORPORATION
 CONSTRUCTION PROJECTS
 DEPARTMENT
 APPROVED FOR
 PROCUREMENT
 P.G. DATE 11/21/68

NEXT ASSY. 2150.281.E002 WGN 103002

LIMITS ON MACHINED DIMENSIONS EXCEPT AS NOTED ANGULAR ± 1° 0' LINEAR .X = ± .1 .XX = ± .03 .XXX = ± .010 FRACTIONAL ± 1/32	150 IN STELLAR TELESCOPE MOUNTING	WESTERN GEAR CORPORATION HEAVY MACHINERY DIVISION EVERETT, WASHINGTON	
	DRAWN MAUNDERS 2/30 CHECK <i>L.W. 11/21/68</i> ENGR	NUT, ADJUSTABLE DUST COVER & IRIS ASSY PRIMARY MIRROR	
NGC 112625	SIZE B	CODE IDENT NO. 16603	REV A
BREAK ALL SHARP EDGES	APPROVED	SCALE 1" = 1/2" IN	WT. 1 LB SHEET OF