

5

4

3

2

1

REVISIONS				
ZONE	LTR	DESCRIPTION	DATE	APPROVED
4C	A	FINISH MARK ADDED TO O/DIA	10/18/68	
	A	APPROVED PER AURA CONSTRUCTION PRINT 9-20-68		

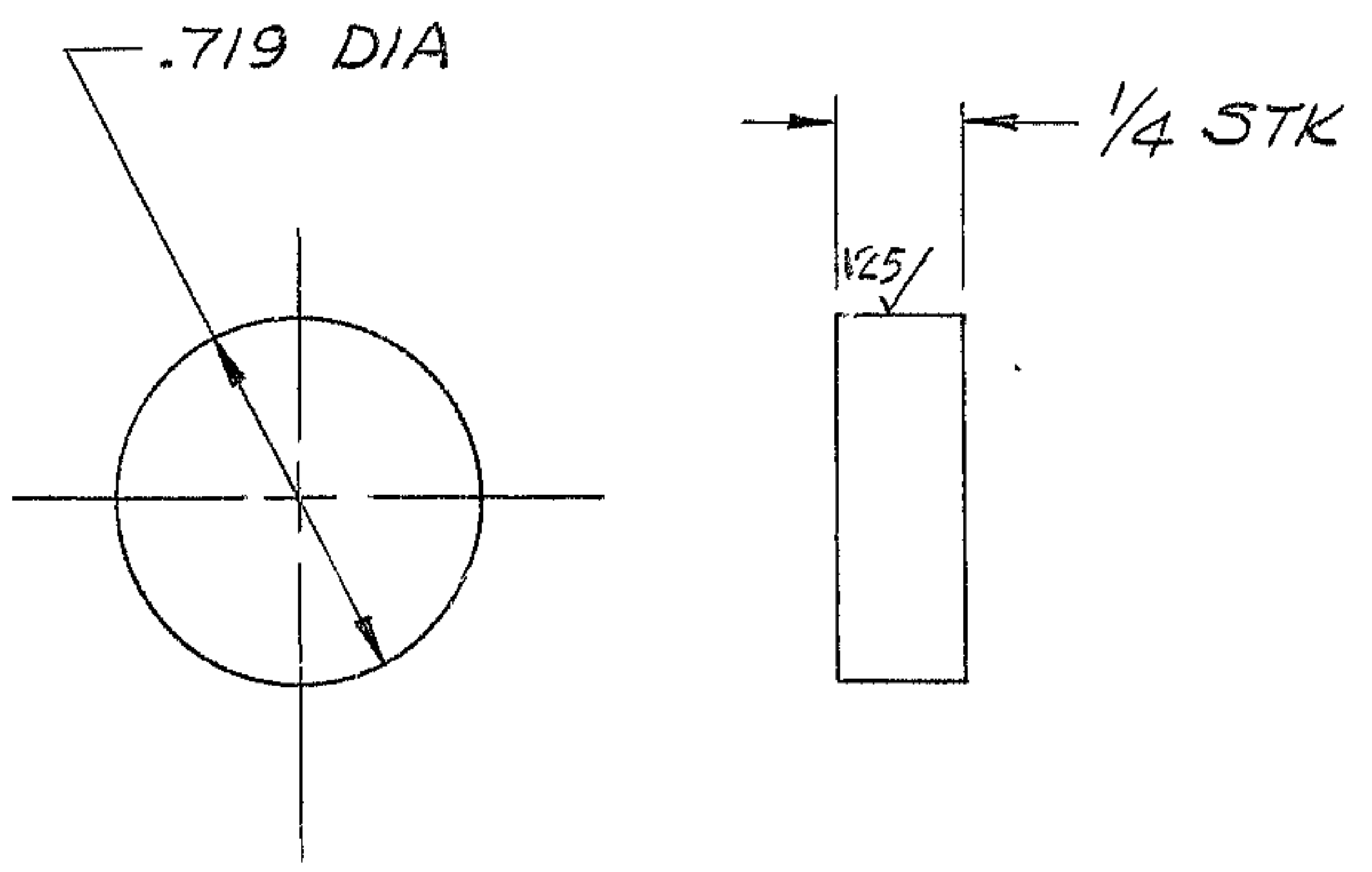

NOTES:

1. ALL DIMENSIONS ARE IN INCHES
2. TAG WITH PART NO. 2150.281B049
3. MATL: \varnothing 3/4 DIA X 1/4 STL AISI C1018

REF. FILE 1175

WESTERN GEAR CORPORATION
 CONSTRUCTION PROJECTS
 DEPARTMENT
 APPROVED FOR
 PROCUREMENT
 P.G. DATE 11/31/68

NEXT ASSY: 2150.281E002 (W.G.N 103002)

LIMITS ON MACHINED DIMENSIONS EXCEPT AS NOTED ANGULAR $\pm 1^{\circ} 0'$ LINEAR .X = $\pm .1$.XX = $\pm .03$.XXX = $\pm .010$ FRACTIONAL $\pm 1/32$ BREAK ALL SHARP EDGES	150 IN. STELLAR TELESCOPE MTG	WESTERN GEAR CORPORATION HEAVY MACHINERY DIVISION EVERETT, WASHINGTON		
	DRAWN <i>E. Nicolaysen</i> 8-16-68	RETAINER, SPRING CENTER SECTION		
	CHECK <i>JWH</i>	SIZE B	CODE IDENT NO. 16603	2150.281B029
	ENGR	W.G.C 112702	REV A	
	APPROVED	SCALE 2/1	WT. LB SHEET 1 OF 1	