

5

4

3

2

1

REVISIONS				
ZONE	LTR	DESCRIPTION	DATE	APPROVED
	A	REL. FOR MANUFACTURE PER AURA	2/17/69	G.R.

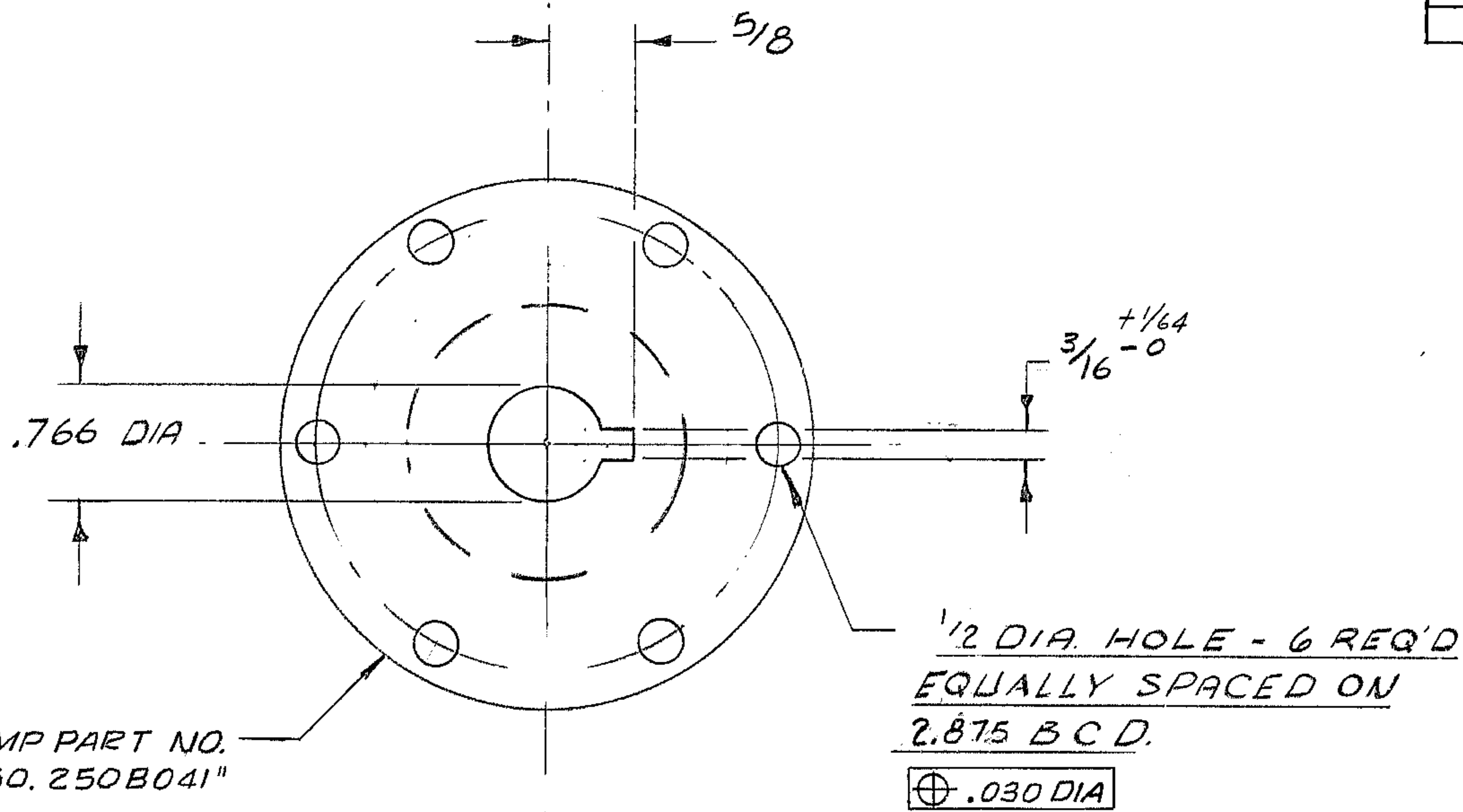

STAMP PART NO.
"2150.250B041"

WESTERN GEAR CORPORATION
CONSTRUCTION PROJECTS
DEPARTMENT

APPROVED FOR
PROCUREMENT

G.R. DATE 2/19/69

NOTE:

1. FINISH ¹²⁵ ✓ ALL OVER EXCEPT
AS NOTED

2. ALL DIMS. IN INCHES

3. MATERIAL: - STL. SAE 4140 H.T.
(100,000 PSI Y.S. MIN) OR EQUIV. 3 3/4 DIA x 1 3/4
(300-324 BHN)

NEXT ASSY: 2150.250 E 002 (U.G.N 102 901)

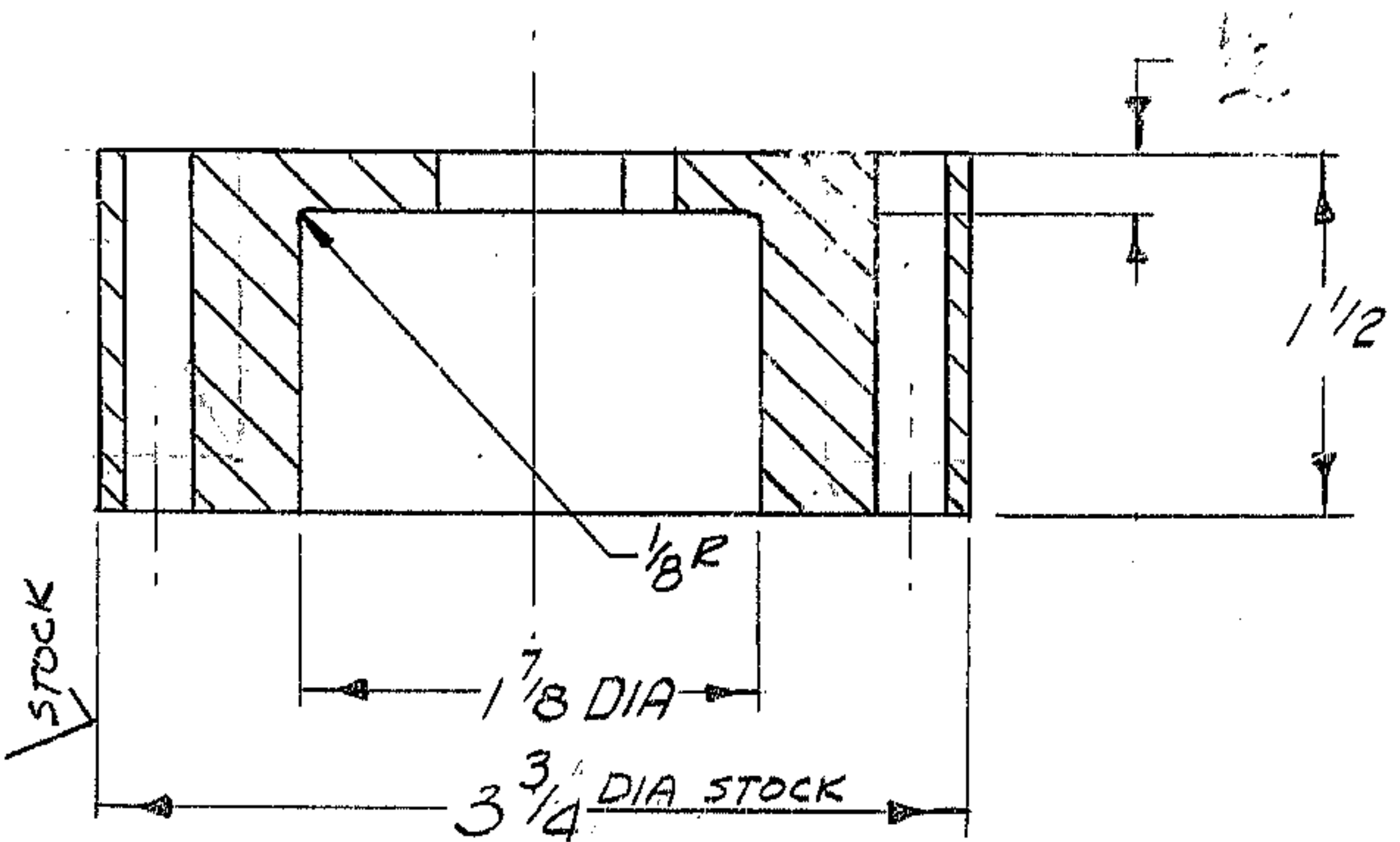

LIMITS ON
MACHINED DIMENSIONS
EXCEPT AS NOTED

ANGULAR ± 1° 0'

LINEAR
.X = ± .1
.XX = ± .03
.XXX = ± .010

FRACTIONAL ± 1/32

BREAK ALL
SHARP EDGES

150" STELLAR
TELESCOPE MOUNTING

DRAWN A. GREEN

CHECK *A.W.M.*

ENGR

U.G.C 112 378

APPROVED

WESTERN GEAR CORPORATION HEAVY MACHINERY DIVISION
EVERETT, WASHINGTON

ADAPTER, HAT SECTION,
HORSESHOE ASSY.

SIZE B	CODE IDENT NO. 16603	2150.250B041	REV A
SCALE NONE	WT. 1 1/2 LB	SHEET 1 OF 1	