

5

4

3

2

1

REVISIONS				
ZONE	LTR	DESCRIPTION	DATE	APPROVED
	A	RELEASED FOR CONSTR.	3/11/69	P.G.

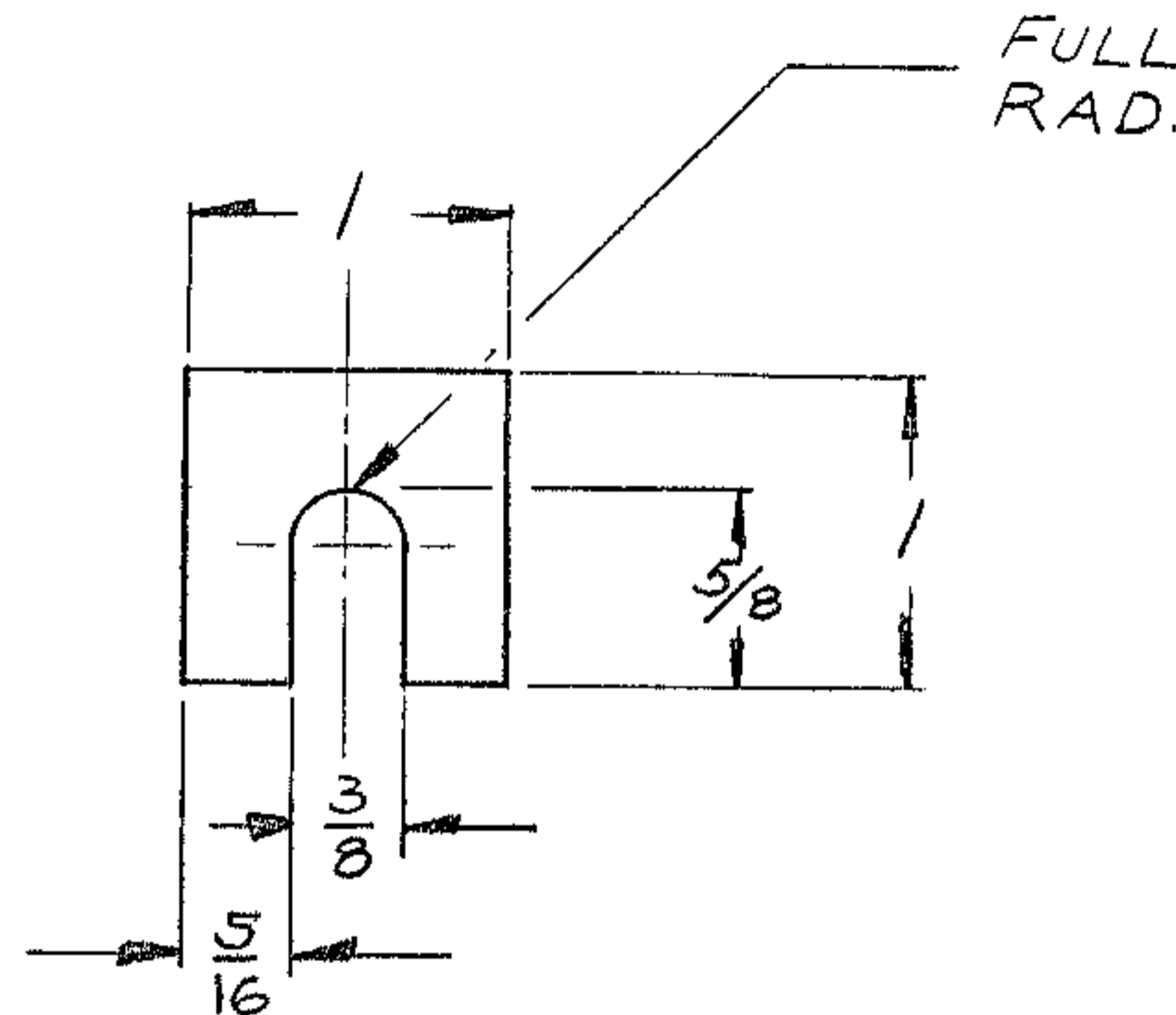

- NOTES :
1. ALL DIMENSIONS ARE IN INCHES
 2. MATL: BRASS SHIM STOCK, MAKE IN SETS OF:
 1. @ .020 THK
 2. @ .007 THK
 3. @ .005 THK
 3. TAG WITH PART NO 2150.250.B019

WESTERN GEAR CORPORATION
 CONSTRUCTION PROJECTS
 DEPARTMENT
 APPROVED FOR
 PROCUREMENT
 P. J. Jefe DATE 3/12/69

NEXT ASSY: 2150.250E002 (W.G.N 102901)

REF. FILE 1168

LIMITS ON MACHINED DIMENSIONS EXCEPT AS NOTED ANGULAR ± 1° 0' LINEAR .X = ± .1 .XX = ± .03 .XXX = ± .010 FRACTIONAL ± 1/32 BREAK ALL SHARP EDGES	150 IN STELLAR TELESCOPE MOUNTING	Western GEAR CORPORATION HEAVY MACHINERY DIVISION EVERETT, WASHINGTON		
	DRAWN D. Thompson CHECK Gene Russo 3/13/68 ENGR	SHIM SET, RIGHT ANGLE BOX HORSE SHOE ASSY		
W.G.C 112684	SIZE B	CODE IDENT NO. 16603	2150.250B019	REV A
APPROVED	SCALE 1/1	WT.	LB SHEET 1 OF 1	