

5

4

3

2

1

REVISIONS				
ZONE	LTR	DESCRIPTION	DATE	APPROVED
	A	RELEASED FOR CONSTR.	3/11/68	PG

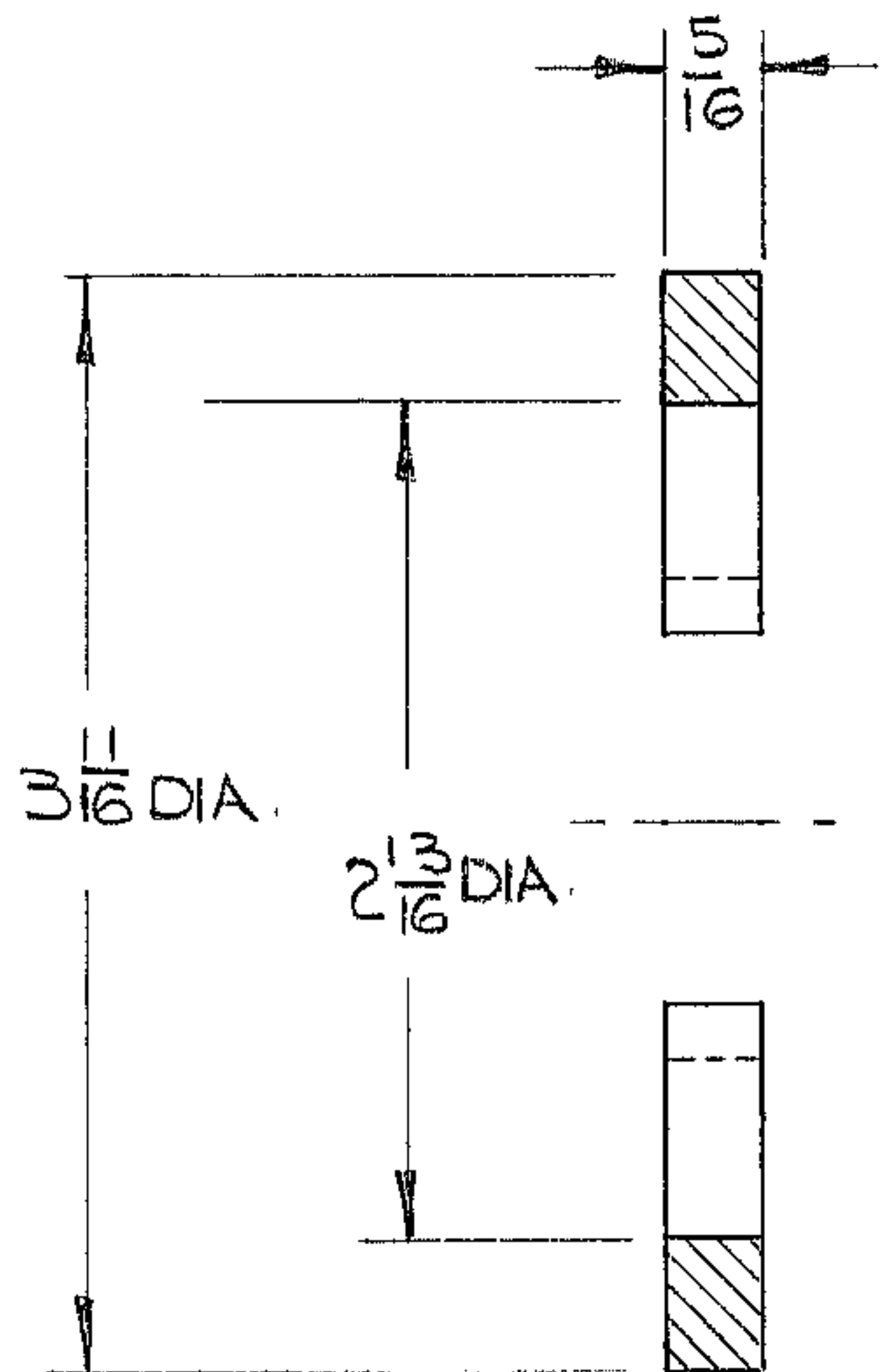
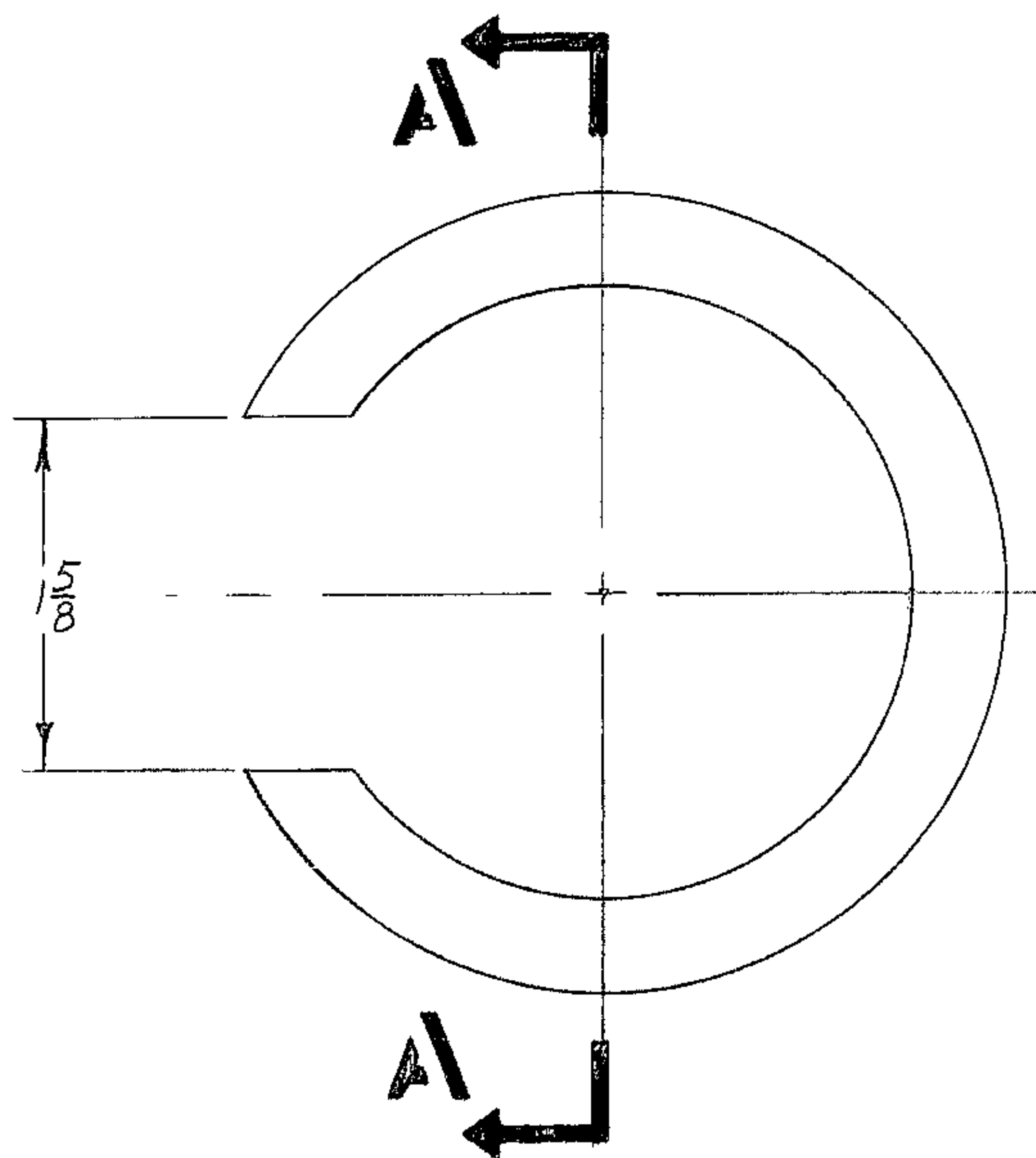

SECTION A-A

NOTES:

1. FINISH $\sqrt{250}$ ALL OVER
2. THICKNESS TO BE MACHINED TO SUIT AT ASSY WITH BUSHINGS.
3. ALL DIMENSIONS ARE IN INCHES.
- 4.
5. MAT'L: 3 3/4 BAR X 1/2 LG STL AISI 1020
6. TAG WITH PART NO. 2150 B013

WESTERN GEAR CORPORATION
 CONSTRUCTION PROJECTS
 DEPARTMENT
 APPROVED FOR
 PROCUREMENT
J. Greff DATE 3/18/69

NEXT ASSY.: 2150.250E002 (WG.N 102901)

REF. FILE 116.8

LIMITS ON MACHINED DIMENSIONS EXCEPT AS NOTED ANGULAR $\pm 1^\circ 0'$ LINEAR .X = $\pm .1$.XX = $\pm .03$.XXX = $\pm .010$ FRACTIONAL $\pm 1/32$ BREAK ALL SHARP EDGES	150 IN. STELLAR TELESCOPE MOUNTING.	WESTERN GEAR CORPORATION HEAVY MACHINERY DIVISION EVERETT, WASHINGTON		
	DRAWN L. GOLD CHECK <i>F. Nicolay</i> 7-9-68 ENGR	SPACER, BUSHING HORSESHOE ASSY		
WGC112471	SIZE B	CODE IDENT NO. 16603	2150.250B013	REV A
APPROVED	SCALE 1/1	WT. .4 LB	SHEET 1	OF 1