

REVISIONS				
ZONE	LTR	DESCRIPTION	DATE	APPROVED
3A	A	MAT: SIZE WAS 11 DIA X 5 1/2.	9/17/68	
6C	A	DOWEL HOLES ADDED		
4B	A	9.997 ± .003 SPH. DIA. WAS 5.000 SPH. RAD		
3B	A	SPHERICAL DIA WAS CAP CENTERLINE.		
3B	A	COLOR MARK ADDED TO NOTE 2.		
B4	B	ADDED AS-BUILT DIMS. FOR CTIO, -PITTS-	16 DEC 71	
	C	DELETED DOWEL HOLES	9/11/78	LBS

21 DIA DRILL THRU
 1/2-13UNC-2B THRU
 8 HOLES EQ. SPACED ON
 10.000 DIA B.C.
 .030 DIA

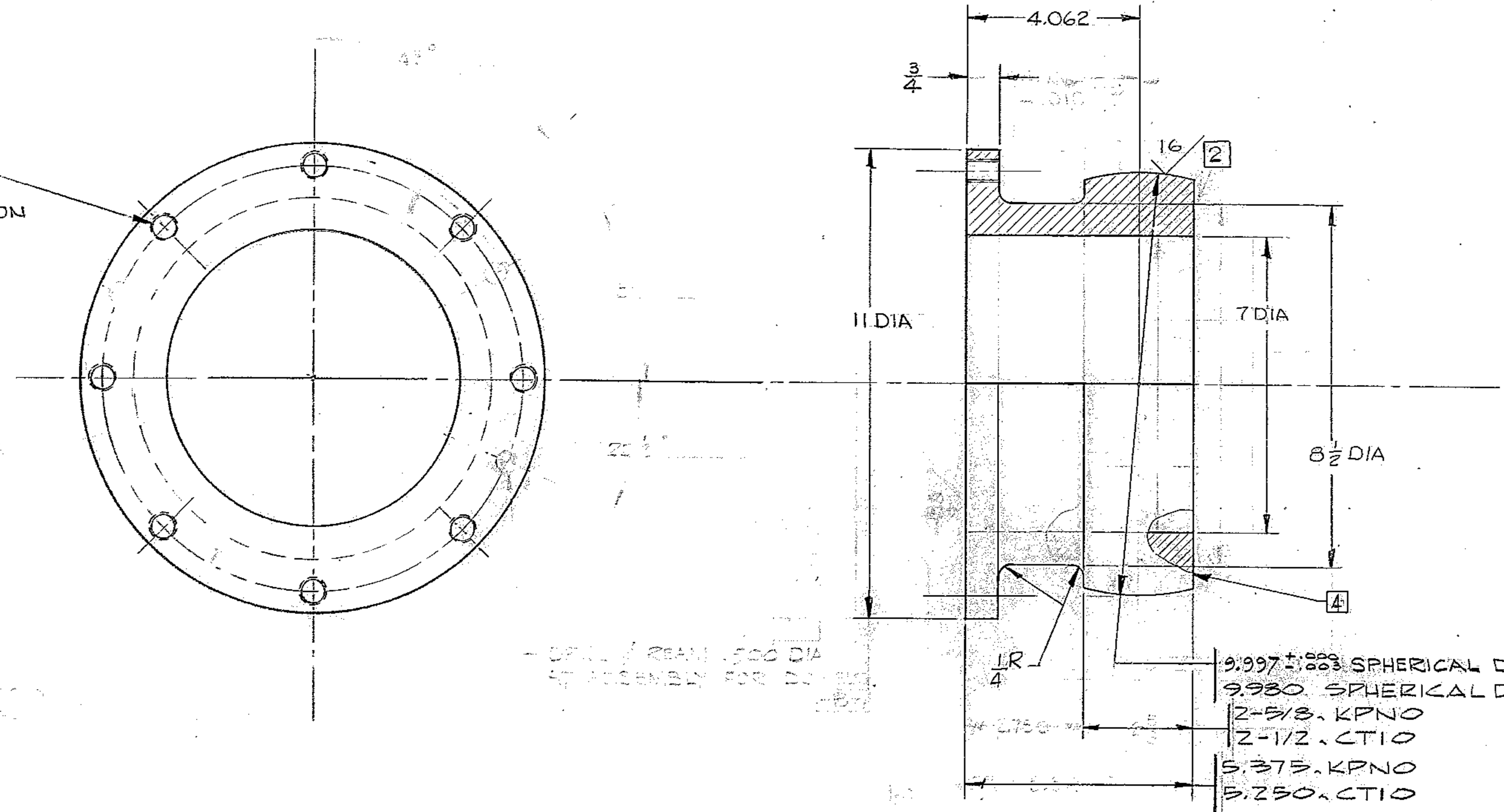

DRILL REAM .500 DIA
 TO ASSEMBLY FOR DOWEL

- 1 9.997 ± .003 SPHERICAL DIA. KPNO
- 2 9.980 SPHERICAL DIA. CTIO
- 3 2-5/8. KPNO
- 4 2-1/2. CTIO
- 5 3/8. KPNO
- 6 3/250. CTIO

- NOTES:
- 1 ALL DIMENSIONS ARE IN INCHES.
 - 2 MATCH SPHERICAL DIA WITH MATING PART NUMBERS (2150.240E008 AND 2150.240D009) COLOR MARK MAIN CONTACT AREA AND RECORD BY SKETCH OR PHOTOGRAPH
 - 3 SURFACE FINISH TO BE 125 UNLESS OTHERWISE SPECIFIED.
 - 4 STAMP PART NO. 2150.240D010 APPROX WHERE SHOWN.

WESTERN GEAR CORPORATION
 CONSTRUCTION PROJECTS
 DEPARTMENT
 APPROVED FOR
 PROCUREMENT
 GR. DATE SEP 18 1968

NEXT ASSY: 2150.240E002 (W.G.N 102993)

REF. FILE 1167

FIND NO.	PART NO.	DESCRIPTION	QTY	MATERIAL	CODE IDENT
LIST OF MATERIAL (LM)					
LIMITS ON MACHINED DIMENSIONS EXCEPT AS NOTED		150LN STELLAR TELESCOPE MOUNTING		WESTERN GEAR CORPORATION	
ANGULAR = ± 1°		DRAWN BAREAGER 3-15-68		HEAVY MACHINERY DIVISION EVERETT, WASHINGTON	
LINEAR: X = ± .1 .XXX = ± .010		CHECKED P. NIEVES 5-29-68		BEARING, PIVOT CASSEGRAIN RAMP ASSEMBLY	
.XX = ± .03 FRACTIONAL = ± 1/32		ENGR			
BREAK ALL SHARP EDGES					
MATERIAL		WGE 107659		SIZE CODE IDENT NO. REV	
STEEL A 15.1 C1018 BAR 11 1/2 DIA X 5 3/4		APPROVED		D 16603 2150.240D010	
SCALE 1/2 WT LB SHEET OF					