

5

4

3

2

1

REVISIONS				
ZONE	LTR	DESCRIPTION	DATE	APPROVED
5C	A	7/8 DIMENSION WAS 1/4	9/17/68	

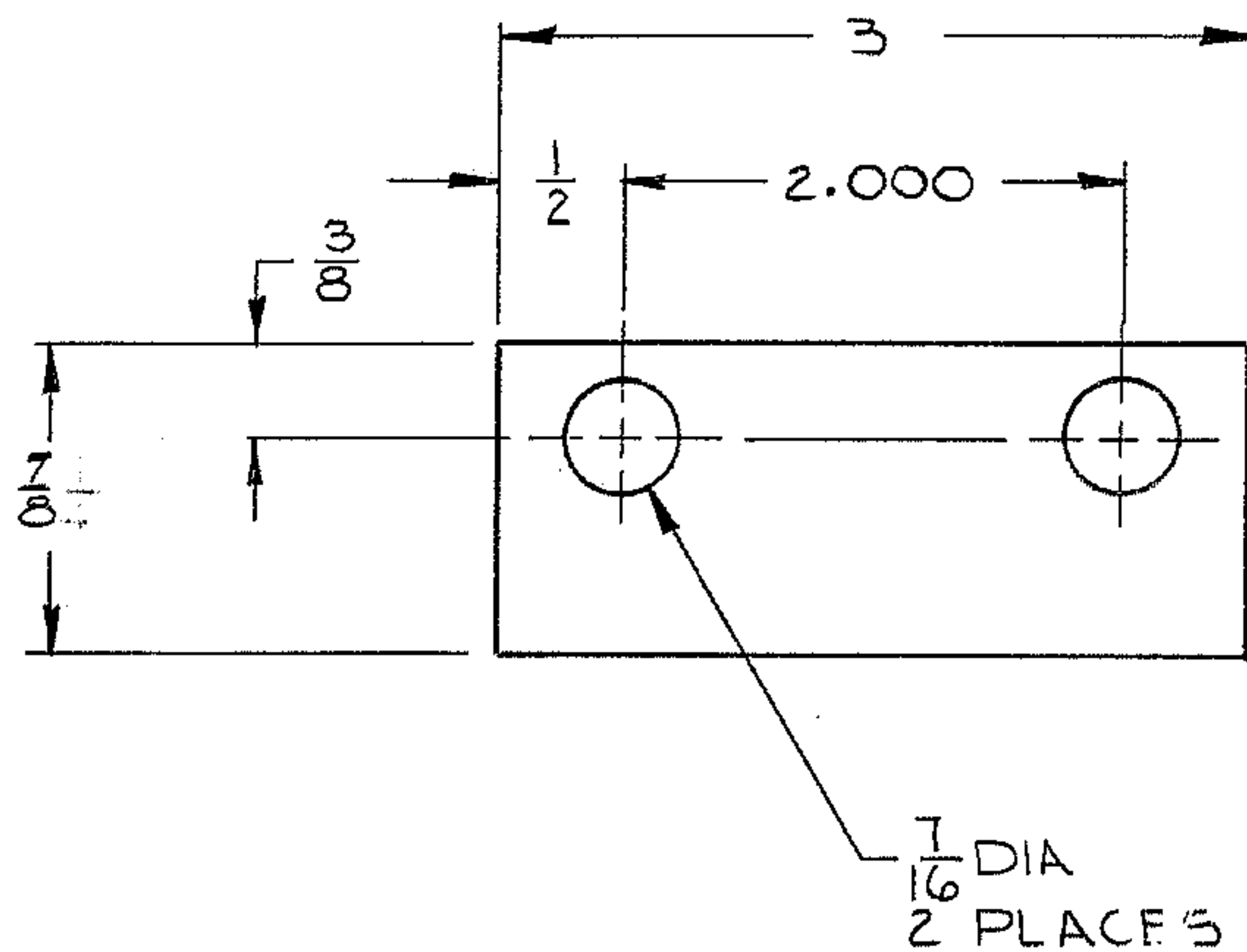

NOTES:

- 1 DIMENSIONS ARE IN INCHES.
- 2 MATL: BRASS SHIM STOCK - 1 SET CONSISTS OF 1-.020 THK, 3-.005 THK, 3-.007 THK; TOTAL .056 THK.
- 3 TAG WITH PART NO. 2150.240B021.

WESTERN GEAR CORPORATION  
 CONSTRUCTION PROJECTS  
 DEPARTMENT  
 APPROVED FOR  
 PROCUREMENT

GE DATE: SEP 18 1968

REF. FILE 1167

NEXT ASSY 2150.240E002 (W.G.N 102993)

LIMITS ON MACHINED DIMENSIONS EXCEPT AS NOTED ANGULAR ± 1° 0' LINEAR .X = ± .1 .XX = ± .03 .XXX = ± .010 FRACTIONAL ± 1/32  BREAK ALL SHARP EDGES	150 IN. STELLAR TELESCOPE MTG	western GEAR CORPORATION HEAVY MACHINERY DIVISION EVERETT, WASHINGTON		
	DRAWN R. ORR CHECK R. NIEVES ENGR	SHIM, BRACKET CASSEGRAIN RAMP ASSY		
W.G.C112511	APPROVED	SIZE B	CODE IDENT NO. 16603	REV A
		SCALE 1/1	WT.	LB SHEET 1 OF 1