

REVISIONS

ZONE	LTR	DESCRIPTION	DATE	APPROVED

NEAT BURN

STL STAMP P/N  
2150.202A016

3/8" DIA THRU  
4 HOLES EQ. SP.  
ON 3 1/2" DIA B.C.

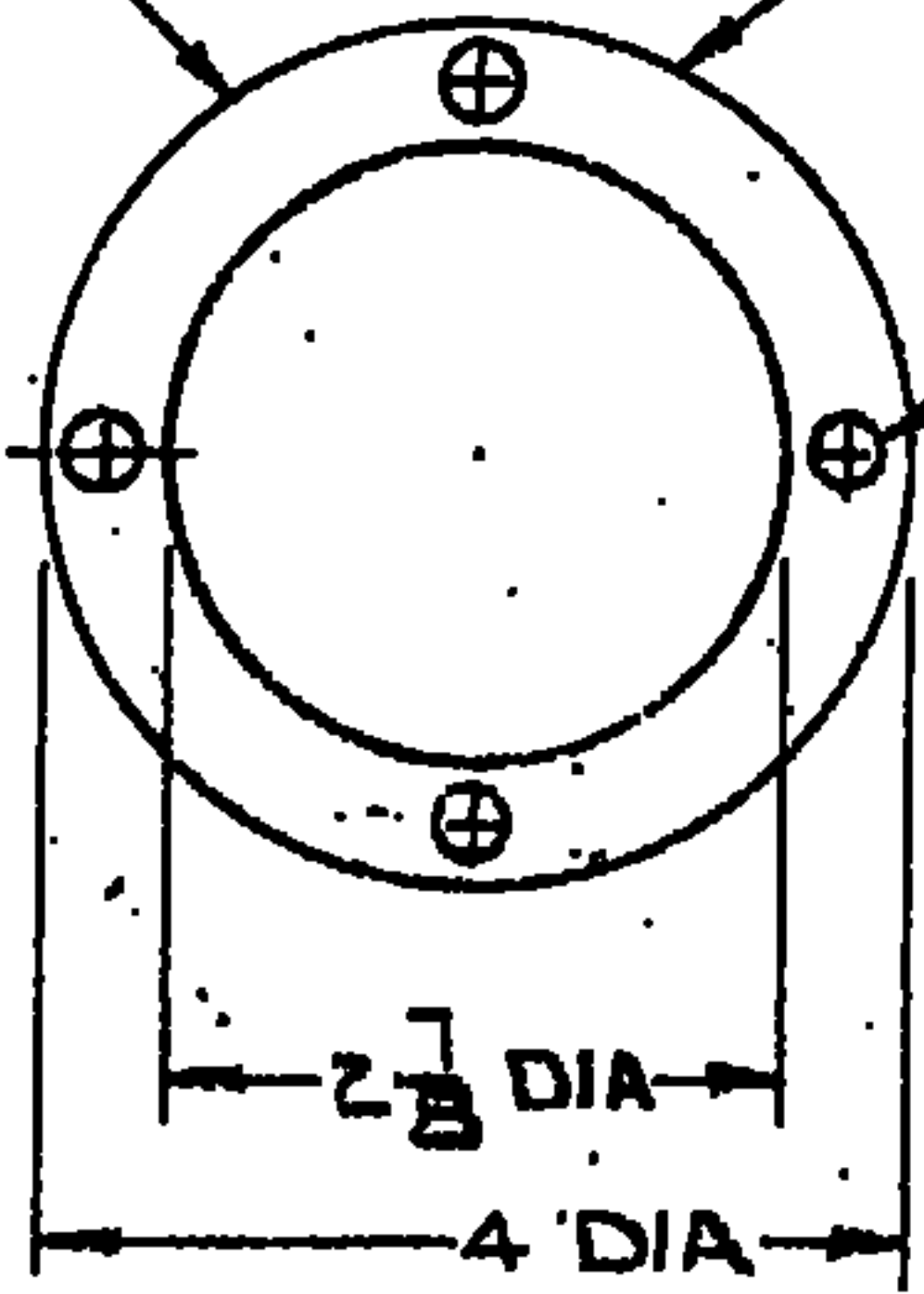

NOTES

1. SAND BLAST TO CLEAN UP
2. APPLY DIVE COAT OF PRIME PAINT PER WGC SPEC 511

REF. FILE 1164

NEXT ASSY: 2150.202E007 WGC N103026

LIMITS ON MACHINED DIMENSIONS EXCEPT AS NOTED ANGULAR ± 1° LINEAR X = ± .1 XX = ± .03 XXX = ± .010 FRACTIONAL ± 1/32 BREAK ALL SHARP EDGES	MAT'L: STL ASTM A-36 4 DIA X 3/8 THK	<b>WESTERN</b> HEAVY MACHINERY DIVISION GEAR CORPORATION EVERETT, WASHINGTON		
	DRAWN LGS 7-8-71	FLANGE, CONDUIT MOUNTING TUBE ASSY		
	CHECK ENGR SKILES 7-8-71	SIZE A	CODE IDENT NO. 16603	REV 2150.202A016
	WGC A301422 APPROVED	SCALE 1/2	WT. _____ LG	SHEET 1 OF 1