

THIS DOCUMENT CONTAINS INFORMATION PROPRIETARY TO WESTERN GEAR CORPORATION. ALL DESIGN, MANUFACTURING, REPRODUCTION, USE, PATENT, AND SALES RIGHTS REGARDING THE SAME ARE HEREBY EXPRESSLY RESERVED BY WESTERN GEAR CORPORATION. THIS DOCUMENT IS SUBMITTED FOR REFERENCE PURPOSES ONLY AND SHALL NOT BE DISCLOSED TO ANY UNAUTHORIZED PERSON OR INCORPORATED INTO ANY OTHER PROJECT.

REVISIONS				
ZONE	LTR	DESCRIPTION	DATE	APPROVED

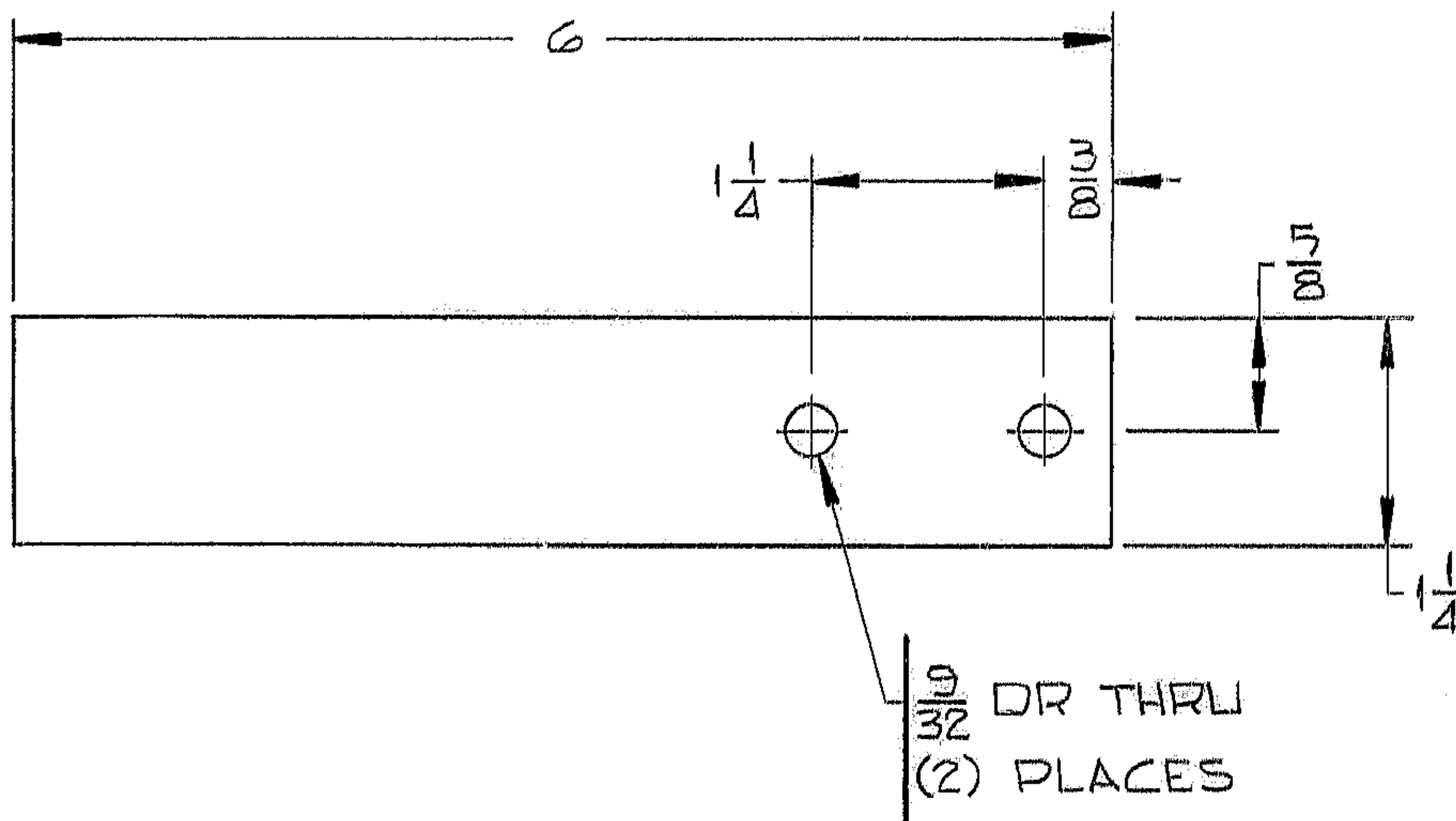

NOTES:

- 1) MATL - SHEET STL  
1/8 THICK
- 2) DEBURR
- 3) (2) REQ'D PER BOX
- 4) STL STAMP P/N 2150.201 B015

REF. FILE 1163

NEXT ASSY 2150.201 E00Z

LIMITS ON MACHINED DIMENSIONS EXCEPT AS NOTED  
 ANGULAR ± 1° 0'  
 LINEAR  
 .X = ± .1  
 .XX = ± .03  
 .XXX = ± .010  
 FRACTIONAL ± 1/32

BREAK ALL SHARP EDGES

**WESTERN** HEAVY MACHINERY DIVISION  
 GEAR CORPORATION EVERETT, WASHINGTON

DRAWN VAN DALEN  
 CHECK  
 ENGR Seales

HINGE CLIP  
 1GE1B3 BOX

WGB304778  
 APPROVED

SIZE	CODE IDENT NO.	REV
B	16603	2150.201B015
SCALE 1/1	WT. .7 LB	SHEET — OF —