

5

4

3

2

1

REVISIONS

ZONE	LTR	DESCRIPTION	DATE	APPROVED
	A	REVISED PER AURA APPD. CONST. PRINT DATED 17 FEB 68	2/24/68	

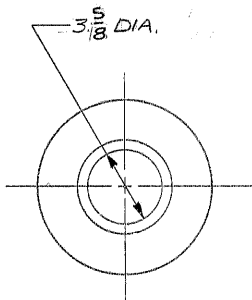
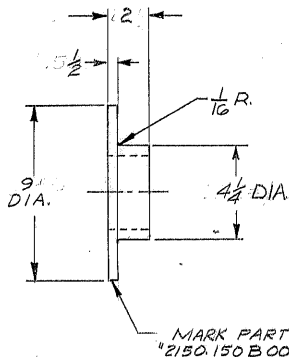

NOTES: —

1. MATERIAL MICARTA OR EQUIV. —
2. FINISH 125 ✓ EXCEPT AS NOTED
3. ALL DIMENSIONS IN INCHES. —

WESTERN GEAR CORPORATION
CONSTRUCTION PROJECTS
DEPARTMENT

APPROVED FOR
PROCUREMENT

SIGNED

DATE

FEB 24 1968

NEXT ASSEMBLY:

REF.

FILE 1158

2150.150D502 (W.G.E 107527)
2150.150D402 (W.G.E 107526)
2150.150D403

LIMITS ON MACHINED DIMENSIONS EXCEPT AS NOTED ANGULAR $\pm 1^{\circ}$ LINEAR X $\pm .1$ XX $\pm .03$ XXX $\pm .010$ FRACTIONAL $\pm 1/32$	150" STELLAR TELESCOPE MOUNTING	WESTERN GEAR CORPORATION	HEAVY MACHINERY DIVISION EVERETT, WASHINGTON			
	DRAWN G. J. TRAGGS JR. 1/21/68		CHECK ENGR	INSULATOR, KPNO SEISMIC ANCHOR		
BREAK ALL SHARP EDGES	W.G.C 112 307	APPROVED	SIZE B	CODE IDENT NO. 16603	2150.150B006	REV A
			SCALE 1/4" = 1" WT. 2.5 LB SHEET 1 OF 1			