

NOTES: UNLESS OTHERWISE NOTED

1. REMOVE ALL BURRS AND SHARP EDGES. $\phi 12$.
2. MACHINED SURFACE ROUGHNESS $\frac{125}{10}$
3. MATERIAL: STEEL, C-1018, COND. OF
4. FINISH: CADMIUM PLATE PER QQP-416 TYPE 2, CLASS 1
5. DIMENSIONS APPLY AFTER PLATING
6. NO PLATING AND THIS SURFACE ONLY
7. MACHINE AT ASSY FOR .002+.004 SLUR FIT WITH (.5M) OF COMPENSATOR BELLOW'S ASSY, DRG NO. 5918, SEALOL INC, PROK D.I.
8. MACHINE AT ASSY FOR .002 MIN CLEARANCE WITH SUPER DING ASSY, DEF DRG NO. 2150-100-0307

.22^{+0.002}_{-.001} DIA
 GROOVE .514 DIA
 TO DEPTH SHOWN
 3 HOLES SPACED
 120° APART

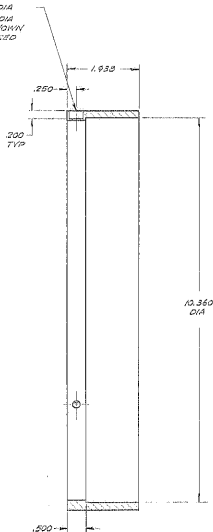
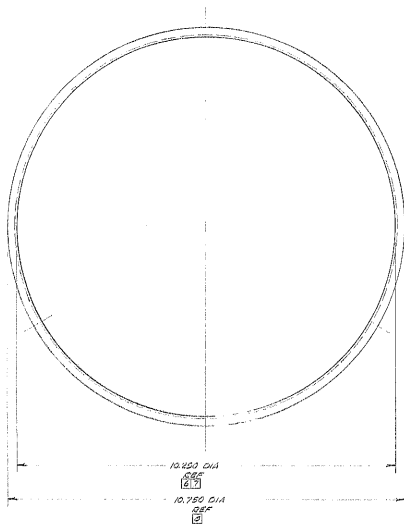

| REVISIONS | | | | | |
|-----------|-----|------------------------|------|--------|---------|
| ZONE | LTR | DESCRIPTION | ECN | DATE | BY APPO |
| A | | 14/A WAS 2150-100-0307 | 1983 | 8-4-83 | JAT |

| REV. NO. | PART OR IDENTIFYING NO. | DESCRIPTION | MATERIAL/SPECIFICATION | ZONE | ITEM NO. |
|--|-------------------------|-------------|------------------------|------|----------|
| PARTS LIST | | | | | |
| <p>TOLERANCES UNLESS OTHERWISE NOTED</p> <p>DIMENSIONS: .3" & UP: .015" .3" & UP: .015" .3" & UP: .015"</p> <p>ANGLES: .5° & UP: .015" .5° & UP: .015"</p> <p>NEXT TOLERANCE: 2150-100-0202</p> | | | | | |
| <p>KITT PEAK NATIONAL OBSERVATORY</p> <p>OPERATED BY THE ASSOCIATION OF UNIVERSITIES FOR RESEARCH IN ASTRONOMY, INC.</p> <p>UNIVERSITY OF CALIFORNIA, LOS ANGELES</p> <p>NATIONAL SCIENCE FOUNDATION</p> | | | | | |
| NAME | | REV. | | DWN | |
| DING-SAFETY BELLOW'S ASSY | | 1153 | | | |
| SCALE: 1/1 | | PART NO. | | REV. | |
| 2150-100-0306 | | A | | | |