

THIS DOCUMENT CONTAINS INFORMATION PROPRIETARY TO WESTERN GEAR CORPORATION. ALL DESIGN, MANUFACTURING, REPRODUCTION, USE, PATENT, AND SALES RIGHTS REGARDING THE SAME ARE HEREBY EXPRESSLY RESERVED BY WESTERN GEAR CORPORATION. THIS DOCUMENT IS SUBMITTED FOR REFERENCE PURPOSES ONLY AND SHALL NOT BE DISCLOSED TO ANY UNAUTHORIZED PERSON OR INCORPORATED INTO ANY OTHER PROJECT.

REVISIONS				
ZONE	LTR	DESCRIPTION	DATE	APPROVED

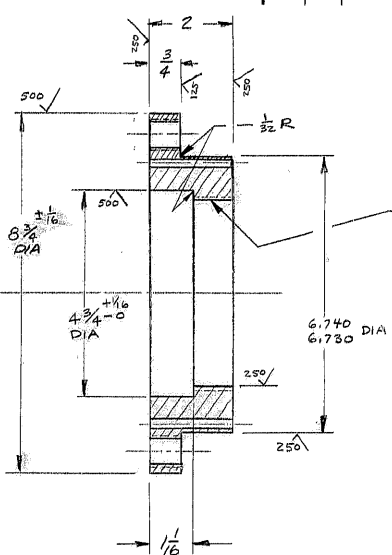
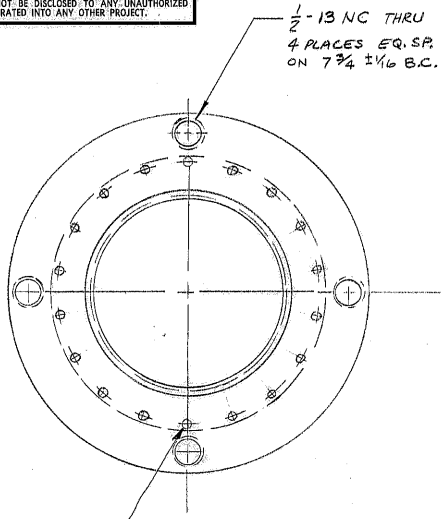

4 ²³/₃₂ -12 UNC-2B THD TO FIT SHAFT E107588 (SAME AS AN 24 NUT)

- NOTES:
 1. MATL: STEEL BAR STOCK
 2. ONE REQD

REF. FILE 1152

LIMITS ON MACHINED DIMENSIONS EXCEPT AS NOTED
 ANGULAR ± 1°
 LINEAR
 X = ± .1
 XX = ± .03
 XXX = ± .010
 FRACTIONAL ± 1/32
 BREAK ALL SHARP EDGES

150" TELE.
 DRAWN G. Russo 5/14/62
 CHECK
 ENGR
 B 304620
 APPROVED

WESTERN GEAR CORPORATION		HEAVY MACHINERY DIVISION EVERETT, WASHINGTON		
PULLER PLATE - FLIP BEARINGS				
SIZE B	CODE IDENT NO. 16603	2150.005 B 316	REV —	—
SCALE 1/2	WT. —	LB	SHEET 1	OF 1