

REVISIONS

LTR	DESCRIPTION	DATE	APPROVED

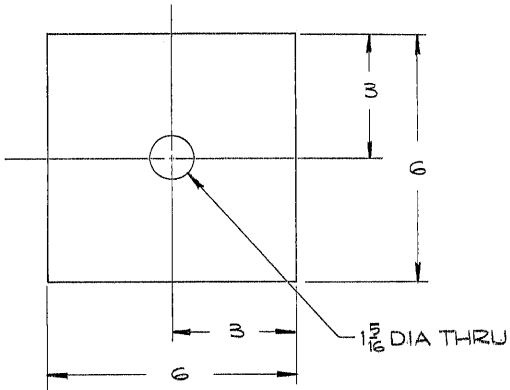

NOTES:

1. MATL - STL. P. 1 x 6 x 6
2. STEEL STAMP PART NO. 2150.005A269

AT EVERETT

REF.	
FILE	1152

LIMITS ON MACHINED DIMENSIONS EXCEPT AS NOTED

ANGULAR ± 1° 0'  
 LINEAR  
 X = ± .1  
 .XX = ± .03  
 .XXX = ± .010  
 FRACTIONAL ± 1/32

BREAK ALL SHARP EDGES

**Western**  
 GEAR CORPORATION

HEAVY MACHINERY DIVISION  
 EVERETT, WASHINGTON

DRAWN *White* 2-24-71

CHECK

ENGR *skies*

WG A301066

APPROVED

CAP, LIFTING BEAM  
 SER. TRUSS

SIZE	CODE IDENT NO.	REF.	REV
A	16603	2150.005A269	

SCALE 1/2 WT. LB SHEET 1 OF 1

A 301,066