

NOTES:

1. REMOVE ALL BURRS AND SHARP EDGES; 0.015 R MAX.
2. MACHINED SURFACE ROUGHNESS $\sqrt{32}$
3. MAT'L: FABRICATE FROM OFHC COPPER.
4. FINISH: ELECTRO-POLISH
5. MATCH WITH RETAINER WIDTH ON SHEET 2131.0008402B.
6. MATCH WITH HEAT SINK CLIPS ON SHEET 2131.0008398B.

REVISIONS					
LTR	DESCRIPTION	ECR	DATE	BY	APRV

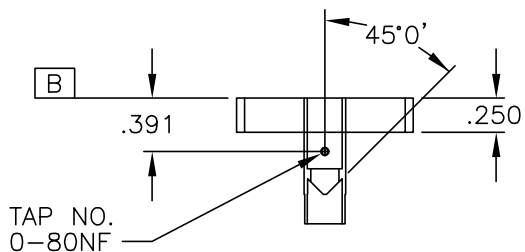
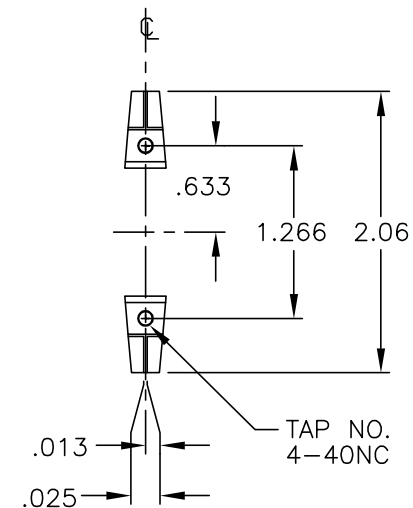
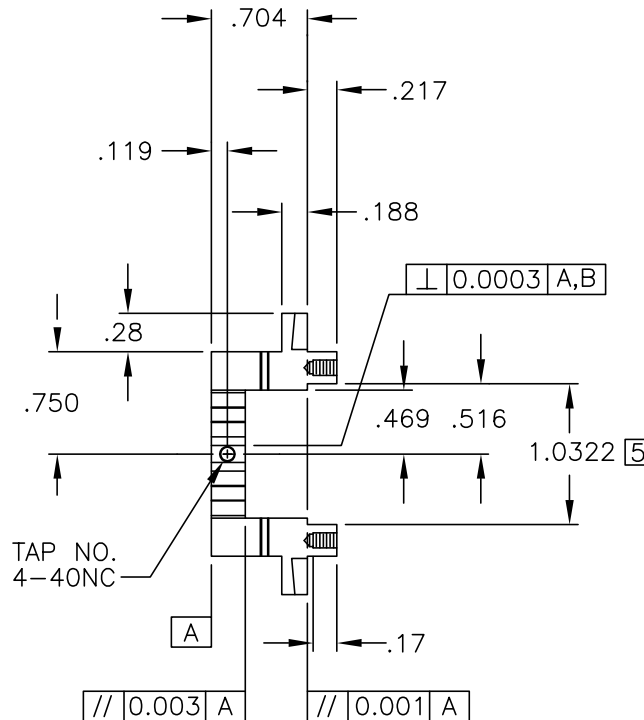
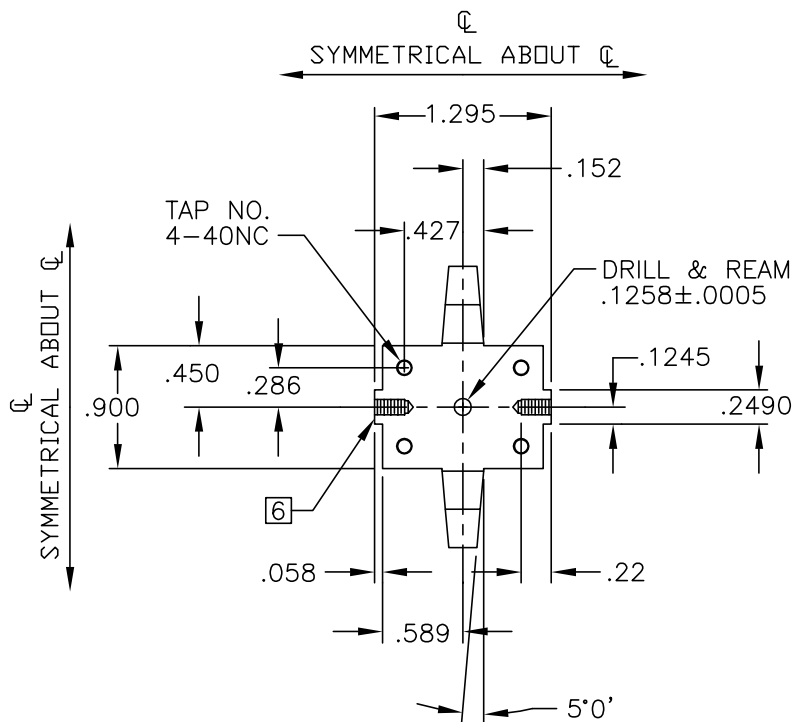

TOLERANCES UNLESS OTHERWISE NOTED
 DECIMALS FRACTIONS ANGULAR
 .XX ± .02 ± 0°30'
 .XXX ± .005
 .XXXX ± .0010 UN. NTD.

NATIONAL OPTICAL ASTRONOMY OBSERVATORIES
 OPERATED BY THE
 ASSOCIATION OF UNIVERSITIES FOR RESEARCH IN ASTRONOMY
 UNDER COOPERATIVE AGREEMENT WITH
 NATIONAL SCIENCE FOUNDATION

NEXT ASSEMBLY 2131.0008404D		NAME SPANNER FRAME; DETECTOR MOUNT			REF FILE 1307	
SCALE FULL		DESIGNED BY RDB		DATE 2/21/01		DWG NO 2131.0008399B
DRAWING PRODUCED USING AUTOCAD R14		DRAWN BY R. BLAKLEY		DATE 2/21/01		
ISSUED		CHECKED BY RDB		DATE 3/28/01		REV
APPROVED BY		APPROVED BY		APPROVED BY		SHEET 1 OF 1