

NOTES: UNLESS OTHERWISE SPECIFIED:

1. CONTACT ENGINEERING IF SOLID MODEL IS REQUIRED.
2. DIMENSIONING AND TOLERANCING PER ANSI Y14.5M 1994.
3. ALL DIMENSIONS IN INCHES.
4. IF "SEE NOTES" IS SHOWN IN THE "PART NUMBER" BLOCK OF THE BOM, THE PART OR ITEM IS AN INDUSTRY STANDARD COMPONENT, MANUFACTURED BY MULTIPLE VENDORS, COMMONLY AVAILABLE VIA DESCRIPTION
5. CHAMFER OR RADIUS SHARP EDGES .020-.040 TO REMOVE BURRS. THIS INCLUDES EDGES ON HOLES, SLOTS, POCKETS, AND THREADED HOLES.
6. MACHINED SURFACE ROUGHNESS TO BE 125 MICRO-INCHES OR BETTER.
7. FINISH: NONE.

REVISIONS					
ZONE	REV.	DESCRIPTION	DRAWN BY	DATE	APV BY

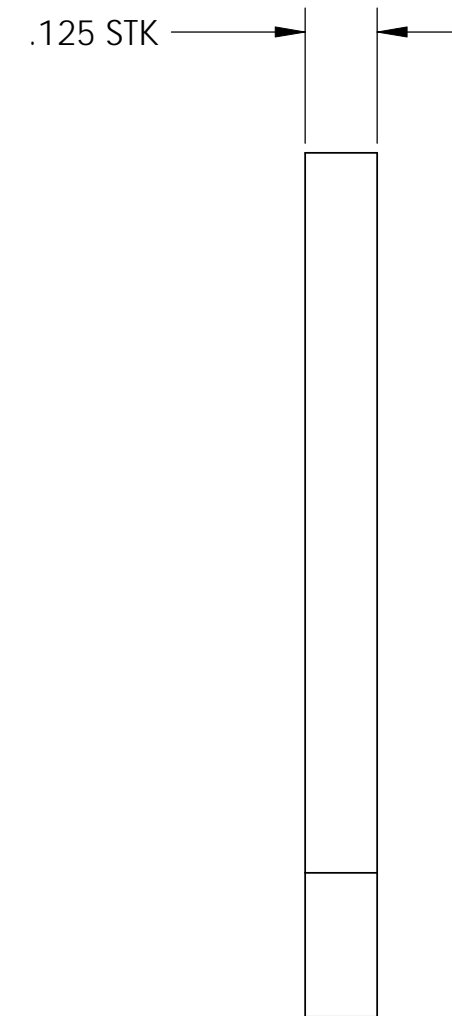
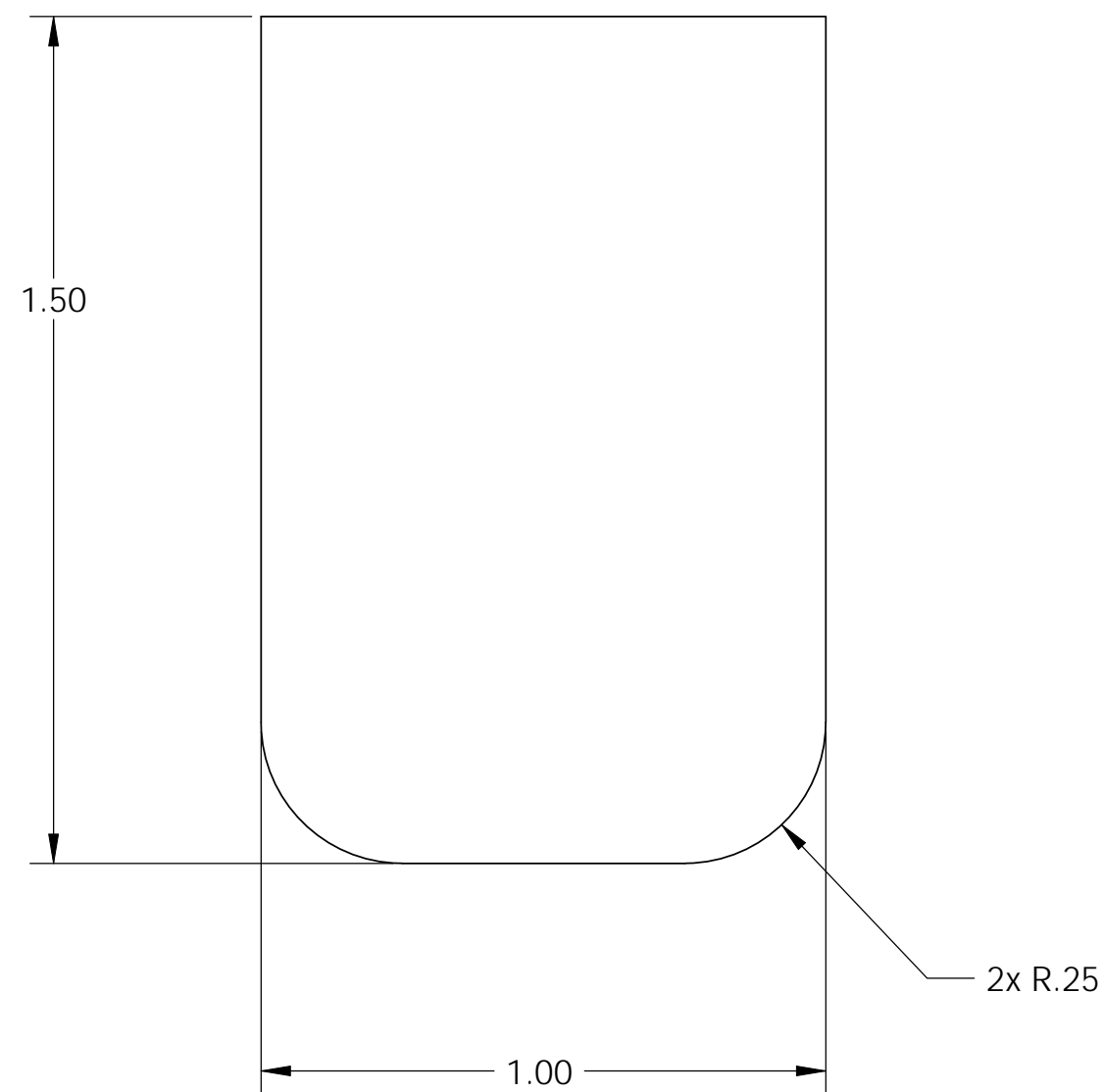
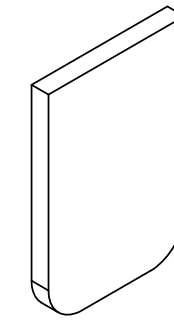

MATERIAL : ASTM A36		CALCULATED WEIGHT (Lbs) 0.1	
TOLERANCES UNLESS OTHERWISE NOTED .XX ±.03 FRACTIONAL ANGULAR .XXX ±.005 1/32" ±.5°		 THIRD ANGLE PROJECTION	 OPERATED BY THE ASSOCIATION OF UNIVERSITIES FOR RESEARCH IN ASTRONOMY UNDER COOPERATIVE AGREEMENT WITH THE NATIONAL SCIENCE FOUNDATION
NEXT ASSEMBLIES 2100-ME-660-0008		DRAWING TITLE END PLATE	
DESIGNED BY: MDK	DRAFTED BY: MDK	REF NUMBER: 1241	
CHECKED BY: DPG	APPROVED BY: DPG	DRAWING SIZE C	CURRENT REV OD
RELEASE DATE: 6/24/08		DRAWING NUMBER 2100-ME-660-1013	SCALE: 3:1 DO NOT SCALE DRAWING
		DWG PRODUCED WITH: SOLIDWORKS 2008	
		SHEET: 1 OF 1	